



## **Stable Flat West Wylfe, Wylfe, Warminster, Wiltshire, BA12 0QD**

A well presented, one bedroom first floor apartment with electric heating situated on private rural estate in the popular Wylfe Valley. SINGLE OCCUPANCY ONLY. Parking for one car.

- Refurbished in 2023
- First floor flat via outside steps
- One double bedroom
- En-suite shower room (no bath)
- Fully double glazed
- Water, sewerage and Wi-Fi included
- Single occupancy only
- Electric heating
- Rural estate location
- Potentially long term

**£750 PCM**

## First Floor

Approx. 39.7 sq. metres (427.2 sq. feet)

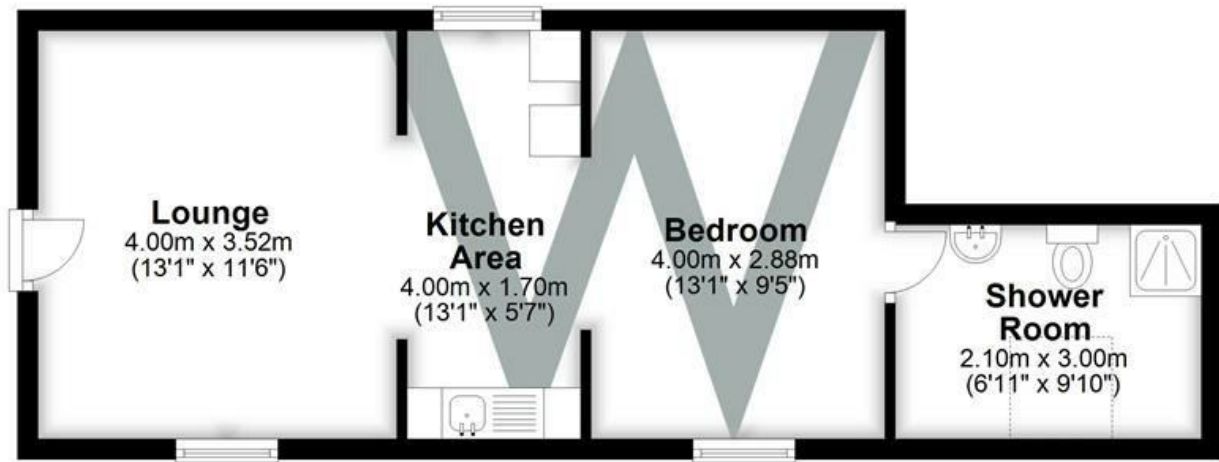

### WHITES

Castle Chambers, 47 Castle Street, Salisbury,  
Wiltshire, SP1 3SP

Tel: 01722 336422/Option 2

[www.hwwhite.co.uk](http://www.hwwhite.co.uk)

email: [lettings-management@hwwhites.co.uk](mailto:lettings-management@hwwhites.co.uk)

Energy Efficiency Rating		
	Current	Potential
Very energy efficient - lower running costs		
(92 plus) <b>A</b>		
(81-91) <b>B</b>		
(69-80) <b>C</b>		
(55-68) <b>D</b>		
(39-54) <b>E</b>		
(21-38) <b>F</b>		
(1-20) <b>G</b>		
Not energy efficient - higher running costs		
	59	71
England & Wales		
	EU Directive 2002/91/EC	

Environmental Impact (CO <sub>2</sub> ) Rating		
	Current	Potential
Very environmentally friendly - lower CO <sub>2</sub> emissions		
(92 plus) <b>A</b>		
(81-91) <b>B</b>		
(69-80) <b>C</b>		
(55-68) <b>D</b>		
(39-54) <b>E</b>		
(21-38) <b>F</b>		
(1-20) <b>G</b>		
Not environmentally friendly - higher CO <sub>2</sub> emissions		
England & Wales		
	EU Directive 2002/91/EC	