



131 Lower Road, Salisbury, Wiltshire, SP2 9NJ

£210,000 Freehold



**Character end terrace house in need of complete modernisation. Garden with rear pedestrian access, workshop and greenhouse.**

### Description

Character end terrace house in need of complete modernisation, situated in the highly sought after area of Lower Bemerton. There is a good garden with rear pedestrian access, workshop and greenhouse. The accommodation consists of entrance hall, sitting/dining room, kitchen, 2 bedrooms and bathroom. Vacant possession.

### Entrance Hall

With stairs to first floor and understairs cupboard.

### Sitting/Dining Room

Two fireplaces with gas fires, central timbers.

### Kitchen

Sink unit, worksurface, base and wall cupboards, door to:

### Sun room

Cupboard with wc, separate store cupboard.

### First floor landing

Hatch to loft space.

### Bedroom One

### Bedroom Two

### Bathroom

Bath, wc and basin. Cupboard housing lagged hot water tank.

### Outside

Small front garden behind rendered wall. Good sized rear garden with workshop and greenhouse. Rear pedestrian access.

### Services

All main services are connected.

### Outgoings

The Council Tax Band is 'C' and the payment for the year 2025/2026 payable to Wiltshire Council is £2350.54.

### Directions

From the city proceed out on the Wilton Road. Pass over Skewbridge and turn left into Church Lane. Take the second left into Lower Road.

### WHAT3WORDS

What3Words reference is: ///armed.album.crust

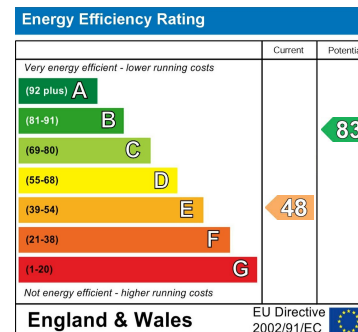

### WHITES

Castle Chambers, 47 Castle Street,  
Salisbury, Wiltshire, SP1 3SP  
Tel: 01722 336422

[www.hwwhite.co.uk](http://www.hwwhite.co.uk)

email: [residential-sales@hwwhite.co.uk](mailto:residential-sales@hwwhite.co.uk)

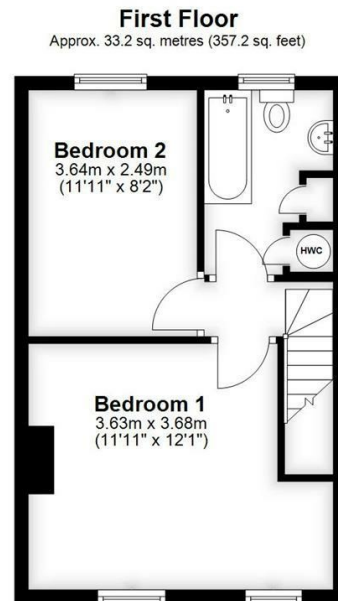
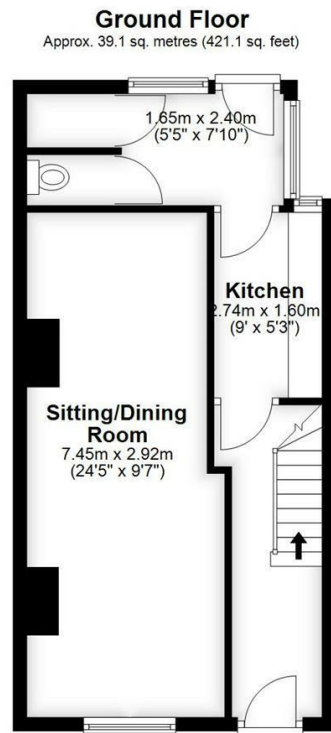

Total area: approx. 72.3 sq. metres (778.4 sq. feet)

