



RESIDENTIAL ESTATE AGENTS
PROPERTY LETTING & MANAGING AGENTS
VALUERS & PROPERTY CONSULTANTS
CHARTERED SURVEYORS

01722 336422
www.hwwhite.co.uk WEB



Shaftesbury Road, Wilton

£975 PCM

15 Shaftesbury Road, Wilton, Salisbury, Wiltshire, SP2 0DT



Energy Efficiency Rating		Current	Potential
Very energy efficient - lower running costs			
(92 plus) A			87
(81-91) B			
(69-80) C		69	
(55-68) D			
(39-54) E			
(21-38) F			
(1-20) G			
Not energy efficient - higher running costs			
England & Wales		EU Directive 2002/91/EC	

This well-maintained terraced house is conveniently located within a short walk of Wilton town centre. The ground floor comprises an entrance hall, a kitchen, and a living room with an ornamental cast iron fireplace, as well as a separate dining room. Refurbished in 2019, the kitchen includes shaker-style units, spaces for a washing machine and fridge-freezer, fitted stainless steel gas hob, single electric oven extractor and splash back and door to outside. Upstairs, there are two bedrooms, each with an original fireplace, and a spacious bathroom which includes a P-shaped bath with a thermostatic shower over and curved glass screen. The property benefits from a long rear garden mainly grass with a shed and a brick outbuilding, and shared access with neighbouring properties from the back. Gas central heating, carpets, and curtain poles/blinds are included throughout.

A Note From the Whites Letting Team

Thank you for considering Whites as your letting agent. As a proud member of the Royal Institution of Chartered Surveyors (RICS), we aspire to uphold its core values by providing a fair, efficient, and transparent service for all prospective tenants. Below we've outlined how we manage property enquiries and applications to help set expectations and guide you through the letting application process.

To begin the process of enquiring about one of our properties, please click the 'Request Further Details/Info' button on the property listing. This will send us your contact information, and we'll get back to you as soon as possible with a short questionnaire to complete. Once we've received your completed questionnaire, your enquiry will be registered with the relevant Property Manager. Please note, only those who complete this step will be considered as having formally enquired about the property.

Due to the high level of interest we often receive, we regret that we aren't often able to offer everyone a viewing. Where possible, we handle enquiries in the order they are received and arrange viewings in groups of up to 4 for the first round. If the property remains available, an additional round of viewings may be scheduled. To manage expectations, we may also temporarily pause viewings to review enquiries. If this happens, we'll do our best to update the property listing accordingly.

Please note that applications are not decided on a first-come, first-served basis. We aim to ensure a fair process for everyone, and all applications will be carefully considered on its merits by us, in conjunction with the landlord, before a final decision is made.

The availability date listed is provisional and will only be confirmed once referencing has been successfully completed.

Ground Floor

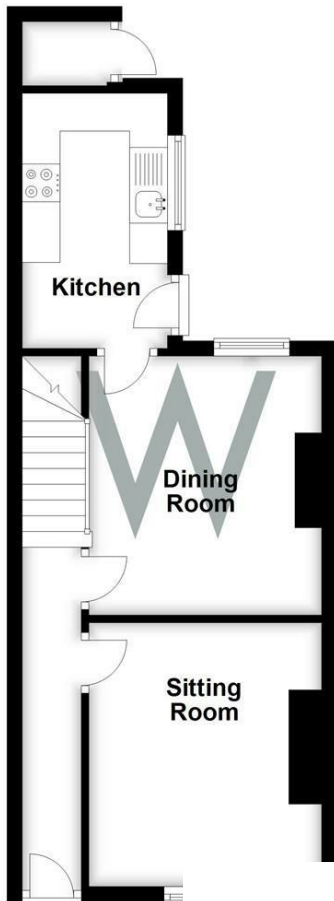

First Floor

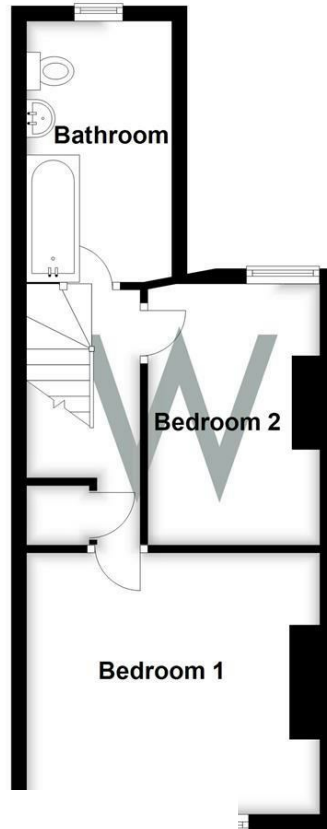

01722 336422