



84 Devizes Road, Salisbury, Wiltshire, SP2 7LN

£1,050 PCM

Modern and spacious terraced house with two bedrooms, located close to the center of Salisbury. The entrance leads to a sitting room with a feature fireplace and a dining room, also with a feature fireplace. The house includes a modern fitted kitchen. Upstairs, there are two double bedrooms with fitted wardrobes, as well as a modern bathroom with a thermostatic waterfall shower and a separate shower handset over the bath. Additionally, there is a small front garden with one parking space on the driveway, as well as a rear garden. The house is UNFURNISHED and available on a long-term basis.



## Ground Floor

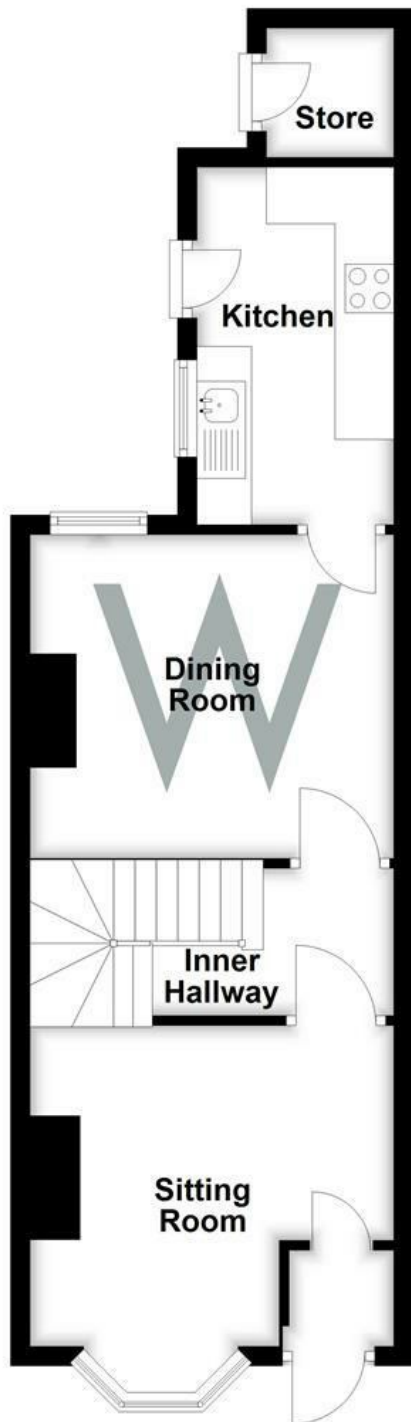

## First Floor



### Energy Efficiency Rating

	Current	Potential
Very energy efficient - lower running costs		
(92 plus) <b>A</b>		<b>88</b>
(81-91) <b>B</b>		
(69-80) <b>C</b>	<b>71</b>	
(55-68) <b>D</b>		
(39-54) <b>E</b>		
(21-38) <b>F</b>		
(1-20) <b>G</b>		
Not energy efficient - higher running costs		
<b>England &amp; Wales</b>	EU Directive 2002/91/EC	

**WHITES**  
 Castle Chambers, 47 Castle Street,  
 Salisbury, Wiltshire, SP1 3SP  
 01722 336422  
[www.hwwhite.co.uk](http://www.hwwhite.co.uk)  
[residential-sales@hwwhite.co.uk](mailto:residential-sales@hwwhite.co.uk)

