



2 School Yard, Fovant, Salisbury, Wiltshire, SP3 5JY

£1,650 PCM

## 2 School Yard, Fovant, Salisbury, Wiltshire, SP3 5JY

- DETACHED HOME
- THREE BEDROOMS
  - WOOD BURNER
- GOOD SIZED GARDEN
- RECENTLY REDECORATED
  - BUILT IN 2019
- LONG TERM TENANCY
- DOUBLE OPEN CAR BARN
  - VILLAGE LOCATION
  - RURAL LOCATION

Built in 2019, a well appointed spacious three bedroom family home situated in the sought after village of Fovant. The accommodation comprises: Spacious entrance hall, fitted kitchen with built in electric hob, extractor over and built in electric oven, plumbing and space for dishwasher, space suitable for fridge/freezer, good range of wall and base units, wood effect work surfaces. Utility/cloakroom with work surface, plumbing and space for washing machine, wall unit and upright cupboard. WC and basin. Sitting room with log burner, double aspect room. Dining room/study with aspect to rear. Landing with access to bedrooms. Master bedroom with access to en suite shower room, twin shower cubicle with thermostatic shower, WC basin. Double bedroom two and single third bedroom. Family bathroom with bath and thermostatic shower over bath, WC and basin. Outside there is a good sized garden to the rear, double open car barn. UNFURNISHED.



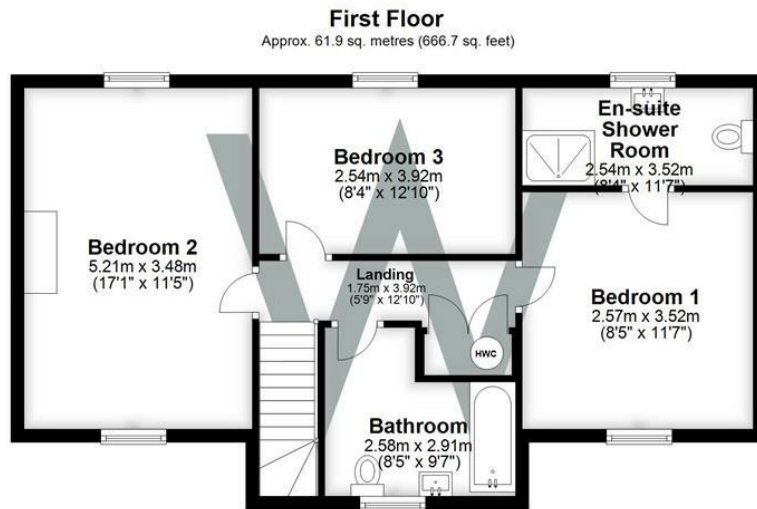
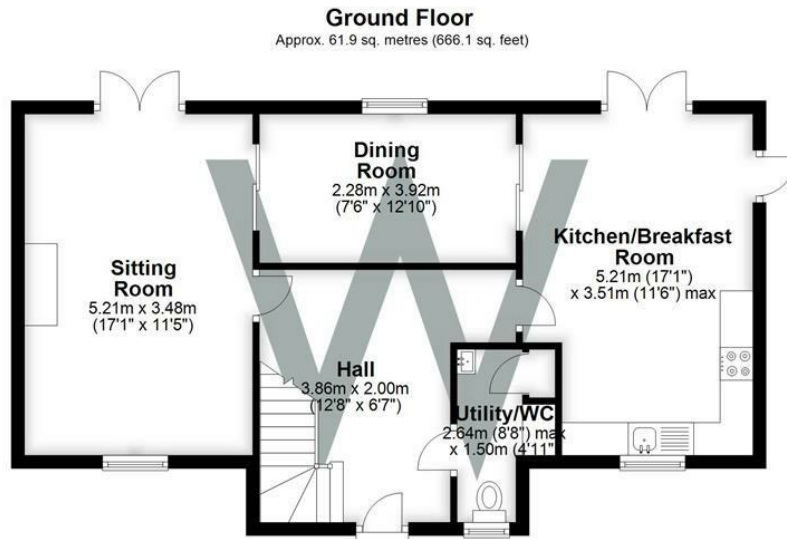

Total area: approx. 123.8 sq. metres (1332.8 sq. feet)



Energy Efficiency Rating		Current	Potential
<i>Very energy efficient - lower running costs</i>			
(92 plus)	<b>A</b>		<b>93</b>
(81-91)	<b>B</b>	<b>83</b>	
(69-80)	<b>C</b>		
(55-68)	<b>D</b>		
(39-54)	<b>E</b>		
(21-38)	<b>F</b>		
(1-20)	<b>G</b>		
<i>Not energy efficient - higher running costs</i>			
<b>England &amp; Wales</b>		EU Directive 2002/91/EC	

**WHITES**  
Castle Chambers, 47 Castle Street,  
Salisbury, Wiltshire, SP1 3SP  
01722 336422  
www.hwwhite.co.uk  
residential-sales@hwwhite.co.uk

