

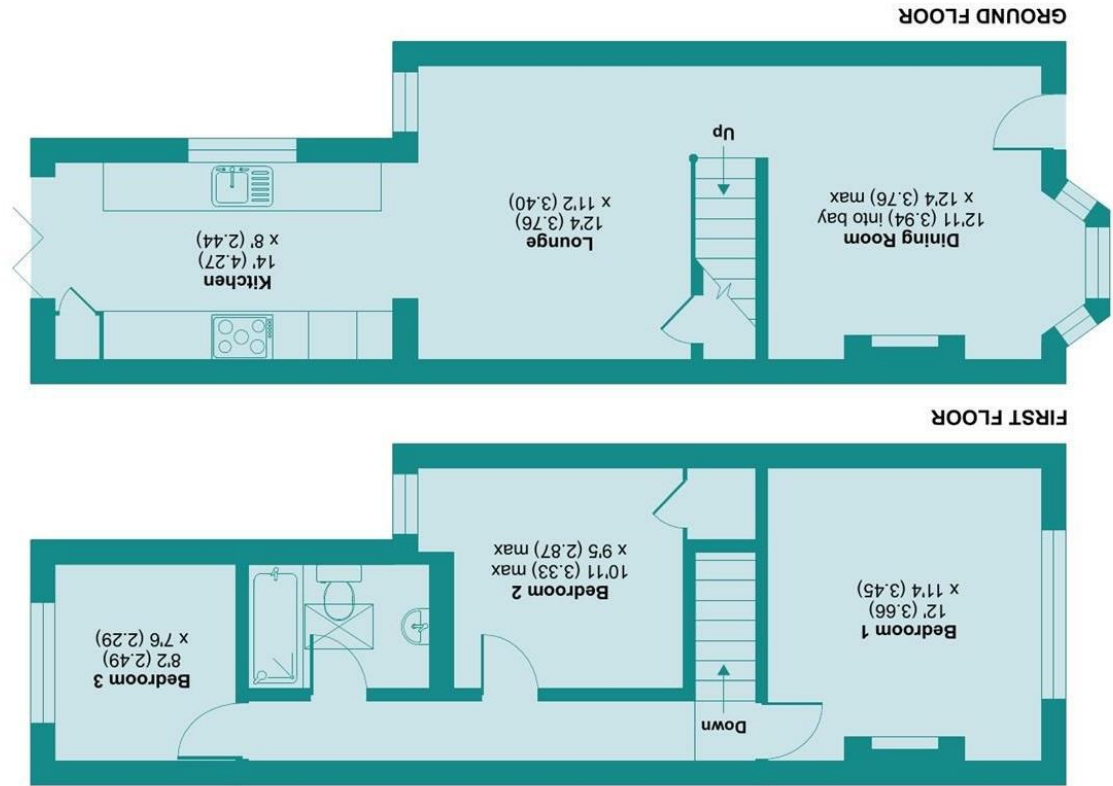

Floor plan produced in accordance with RICS Property Measurement Standards incorporating International Property Measurement Standards (IPMS2 Residential). © nhd.com 2021. Produced for James Estate Agents. REF: 901376



Approximate Area = 881 sq ft / 81.8 sq m
For identification only - Not to scale

New Road, Croxley Green, Rickmansworth, WD3 3EP

LOCAL AUTHORITY
Three Rivers Council

TENURE
Freehold

COUNCIL TAX BAND
D

VIEWS
By prior appointment only

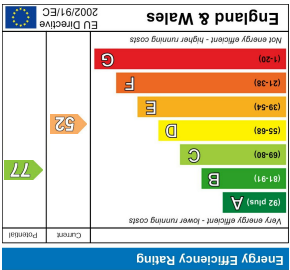

Agents Note: Whilst every care has been taken to prepare these particulars, they are for guidance purposes only. All measurements are approximate and are for general guidance purposes only and whilst every care has been taken to ensure their accuracy, they should not be relied upon and potential buyers/tenants are advised to recheck the measurements



GUIDE PRICE
£585,000
NEW ROAD
CROXLEY GREEN, WD3 3EP

PROPERTY SUMMARY

NO UPPER CHAIN. Welcome to this charming, terraced house located on the popular New Road. Spanning across 881 square feet, this house offers a comfortable living space with a warm and inviting atmosphere. To the ground floor are two spacious reception rooms and generous sized stylish kitchen. Upstairs accommodation consists of three, off landing bedrooms and a contemporary family bathroom. The convenience of having a parking space for one vehicle adds to the appeal of this lovely home.

3



1



2

