

# Cross Keys Estates

Opening doors to your future



Cross Keys Estates

Residential Sales & Lettings



Cross Keys Estates  
Residential Sales & Lettings



Cross Keys Estates  
Residential Sales & Lettings

95C Milehouse Road  
Plymouth, PL3 4AE  
£850 Per Calendar Month



**Cross Keys Estates**  
Residential Sales & Lettings

95C Milehouse Road, Plymouth, PL3 4AE

£850 Per Calendar Month

Cross Keys Estates are delighted to present to the rental market this wonderful top floor apartment which can be found within the popular residential area of Stoke. Having undergone a program of refurbishment in the last couple of years, this stunning home offers accommodation comprising open plan kitchen/sitting room, two spacious double bedrooms, bathroom (please note there is no shower) and a large entrance hallway with boiler cupboard. Externally the property boasts access to an off street parking space with garage door. Situated on the bus route and a short walk to the much loved Stoke Village amenities really are on the doorstep. Available to rent unfurnished immediately this property can be secured with a holding deposit of £196 and a full deposit of £980. Unfortunately this property will not be available to sharers.

- Top Floor Apartment
- Beautifully Refurbished
- Early Viewing Recommended
- Open Plan Kitchen/Living Space
- Bathroom has a bathtub with no shower
- Two Double Bedrooms
- Popular Residential Location
- Available Unfurnished Now
- Allocated Off Street Parking
- Holding Deposit = £196.00



**Cross Keys Estates**  
Residential Sales & Lettings



**Cross Keys Estates**  
Residential Sales & Lettings

## Cross Keys Estates

As one of Plymouth's leading QUALIFIED estate agents for over two decades, we are proud to have been offering our multi award winning customer service since day one. If you are currently on the market or you are thinking of putting your property on the market, why not give us a call, you will not be disappointed. 98% of our clients recommend us to their friends and family and our results, when it comes to sales, are unrivalled.

### Stoke

Stoke is a sought after residential district, much of which is a conservation area due to the high density of Regency and Victorian homes in the area. Located approx. 1 mile from Plymouth centre offering easy access to Plymouth ferry port and within 3 miles of the A38. Primary schools in the area include Stoke Damerel and Stuart Road Primary School, whilst secondary schooling within the area includes Devonport High School for Boys and Stoke Damerel Community College. City College Plymouth is located on the southern fringes of the area. There are a number of large recreational areas including Mount Pleasant Recreation Ground, Victoria Park at Mill Bridge and Devonport Park within the area as well as the Ecological Park located off Milehouse Road.

### Plymouth

Plymouth is a city on the south coast of Devon, about 37 miles south-west of Exeter and 190 miles west-south-west of London, between the mouths of the rivers Plym to the east and Tamar to the west where they join Plymouth Sound to form the boundary with Cornwall, it is also adjacent to one of the most natural harbours in the world. To the North is the Dartmoor National Park extending to over 300 square miles and which provides excellent recreational facilities. The city is home to more than 260,000 people, making it the 30th most populated city in the United Kingdom and the second-largest city in the South West, after Bristol and has a full range of shopping, educational and sporting facilities. There is mainline train service to London (Paddington) and to Penzance in West Cornwall. Plymouth is governed locally by Plymouth City Council and is represented nationally by three MPs. Plymouth's economy remains strongly influenced by shipbuilding and seafaring including ferry links to Brittany and Spain, but has tended toward a university economy since the early 2000's. It has the largest operational naval base in Western Europe – HMNB Devonport.

### Entrance Hall

### Kitchen/Living Space

19'3" x 12'8" (5.87m x 3.87m)

### Bedroom 1

10'2" x 13'4" (3.09m x 4.06m)

### Bedroom 2

9'10" x 12'5" (2.99m x 3.79m)

### Bathroom

Window to rear, door to:

### Financial Services

Cross Keys Estates are proud to work in partnership with Peter Nixon Financial Services, our whole of market mortgage specialists. With over 18 years industry experience, they are able to source the very best deal to meet their customers circumstances. Offering professional and friendly advice on residential and investment mortgages. Please get in touch to arrange a free, no obligation appointment to see how they can help you. Tel. 01752 255905, Email. sarah.millman@pn-fs.co.uk

### Sales Department

Cross Keys Estates also offer a professional, NAEA accredited Residential Property Sales Service. If you are considering selling your property, or are looking at buy a property to let or if you simply would like a free review of your current portfolio then please call Jack Merriott-McMillan-Duncan MNAEA MARLA, Managing Director on 01752 500018



# Top Floor

Approx. 58.0 sq. metres (624.2 sq. feet)

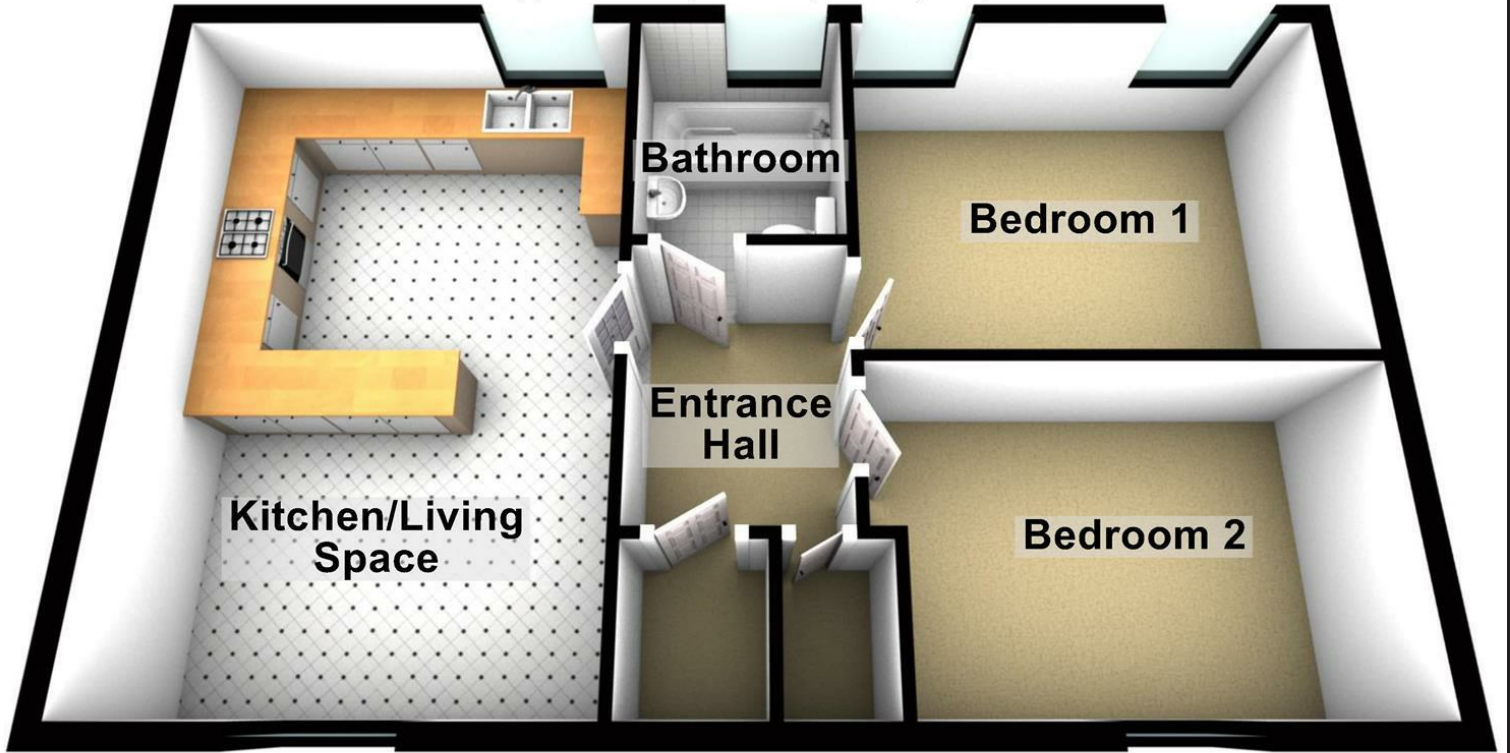

Total area: approx. 58.0 sq. metres (624.2 sq. feet)

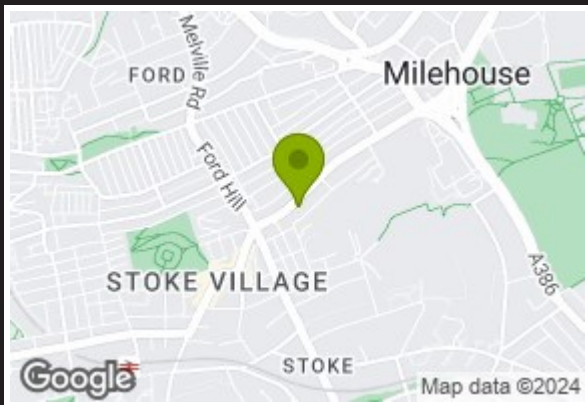

Energy Efficiency Rating		Current	Potential
Very energy efficient - lower running costs			
(92 plus) A			
(81-91) B			
(69-80) C			
(55-68) D			
(39-54) E			
(21-38) F			
(1-20) G			
Not energy efficient - higher running costs			
England & Wales		70	73
		EU Directive 2002/91/EC	

Environmental Impact (CO <sub>2</sub> ) Rating		Current	Potential
Very environmentally friendly - lower CO <sub>2</sub> emissions			
(92 plus) A			
(81-91) B			
(69-80) C			
(55-68) D			
(39-54) E			
(21-38) F			
(1-20) G			
Not environmentally friendly - higher CO <sub>2</sub> emissions			
England & Wales			
		EU Directive 2002/91/EC	

VIEWINGS AND NEGOTIATIONS Strictly through the vendors agents, Cross Keys Estates MONEY LAUNDERING REGULATION 2003 AND PROCEEDS OF CRIME ACT 2002 Cross Keys Estates are fully committed to complying with The Money Laundering Regulations that have been introduced by the government. These regulations apply to everyone buying or selling a property, including companies, businesses and individuals within the United Kingdom or abroad. Should you either purchase or sell a property through this estate agents we will ask for information from you regarding your identity and proof of residence. We would ask for you to co-operate fully to ensure there is no delay in the sales/purchase process. IMPORTANT: we would like to inform prospective purchasers that these sales particulars have been prepared as a general guide only. A detailed survey has not been carried out, nor the services, appliances and fittings tested. Room sizes should not be relied upon for furnishing purposes and are approximate. If floor plans are included, they are for guidance only and illustration purposes only and may not be to scale. If there are any important matters likely to affect your decision to buy, please contact us before viewing the property.



Council Tax Band A



Cross Keys Estates  
Opening doors to your future

Lettings, Cross Keys House 51-53 Devonport Road,  
Stoke, Plymouth, Devon, PL3 4DL  
Tel: 01752 500099 | lettings@crosskeysestates.net  
www.crosskeysestates.net