



LAMB & CO

**Clacton-on-Sea**

52 Station Road  
Clacton-on-Sea  
Essex CO15 1SP

01255 422240

**St Osyth**

11 Clacton Road  
St Osyth  
Essex CO16 8PA

01255 820424

**Thorpe-Le-Soken**

High Street  
Thorpe-Le-Soken  
Essex CO16 0EA

01255 862332

**Harwich**

286 High Street  
Harwich  
Essex CO12 3PD

01255 442505



**BETTS GREEN ROAD, LITTLE CLACTON, CO16 9NH**

**OFFERS IN EXCESS OF £525,000**

**\*\* Guide Price £550,000 - £575,000 \*\*** Welcome to 'The Meadows', a peaceful tucked away mews development of just 7 properties. This high specification detached bungalow offers spacious, light and airy accommodation throughout with luxury detail present behind each door. The bungalow is due for completion this summer and benefits from double garage with electric door and ample off-road parking.

- Three Bedrooms
- Quiet Mews Position
- 1,365 Sq Ft
- Luxury Specification
- NEFF Appliances
- Quartz Worktops
- Double Garage
- South Facing Garden
- En-Suite to Master Bedroom



[enq@lambandcoproperty.co.uk](mailto:enq@lambandcoproperty.co.uk) [www.lambandcoproperty.co.uk](http://www.lambandcoproperty.co.uk)

Residential | Lettings | Financial Services | Land & New Homes

Accommodation comprises with approximate room sizes as follows:

Entrance door to:

### OUTSIDE

Outside the property offers off road parking via a block paved attractive driveway leading to a detached garage. Screened from the road by laurel hedging and timber post and rail fencing.

The rear garden is south facing, predominantly laid to lawn with a good-sized patio area for entertaining and dining in the sun.

### LOCATION

Little Clacton is a rural village around two and a half miles north of Clacton town centre. It is served by its own local thriving amenities which include Post Office, Public house, Good primary school, playing fields and recreational parks, Takeaways and Provides easy access into and out of Clacton on the B1441.

### ENTRANCE HALL

### BEDROOM ONE

14'1 x 11'10 (4.29m x 3.61m)

### ENSUITE

9'2 x 4'2 (2.79m x 1.27m)

### BEDROOM THREE

11'10 x 10'5 (3.61m x 3.18m)

### LOUNGE

16'6 x 14'10 (5.03m x 4.52m)



### KITCHEN/DINER

25'4 x 15' (7.72m x 4.57m)

### UTILITY ROOM

11'3 x 5'2 (3.43m x 1.57m)

### BEDROOM TWO

16'7 x 11'8 (5.05m x 3.56m)

### BATHROOM

7'7 x 6'4 (2.31m x 1.93m)

### OUTSIDE

### FRONT

### DOUBLE GARAGE

Power & Light connected, electric sectional door.



## REAR



purchasers will be asked to produce photographic identification and proof of residence documentation once entering into negotiations for a property.

## SIDE



### Additional Information

Council Tax Band: TBC

Heating: underfloor heating

Seller's Position: no onward chain

Garden Facing: South

### Agents Note Sales

PLEASE NOTE - Although we have not tested any of the Gas/Electrical Fixtures & Fittings, we understand them to be in good working order, however it is up to any interested party to satisfy themselves of their condition before entering into any Legal Contract.

### AML

ANTI-MONEY LAUNDERING REGULATIONS 2017

- In order to comply with regulations, prospective

## Map

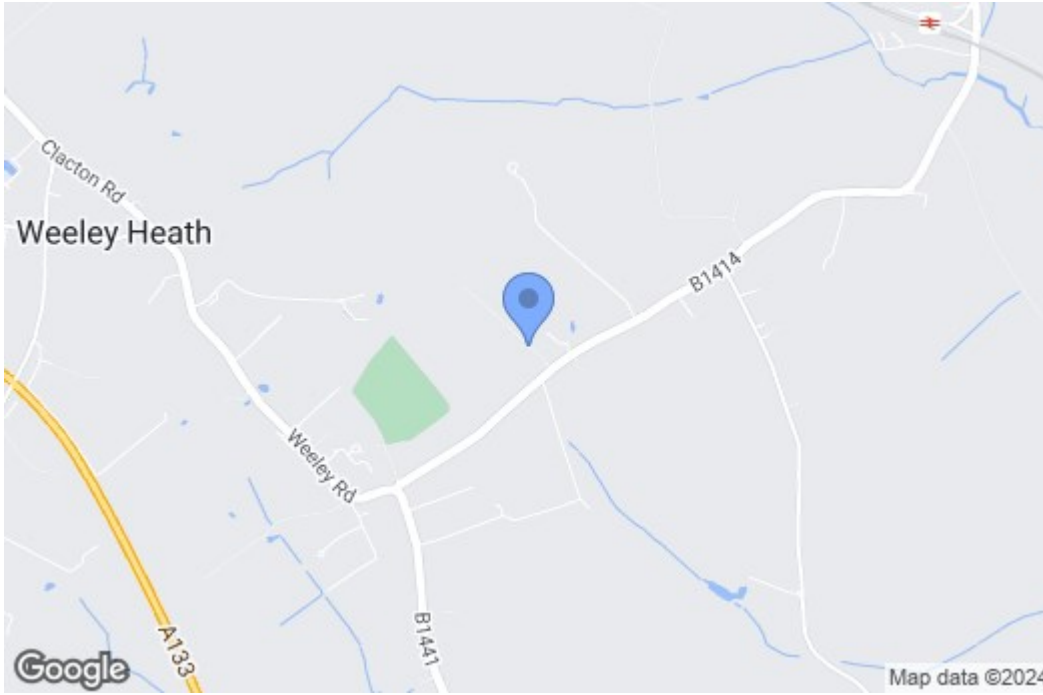

## EPC Graphs

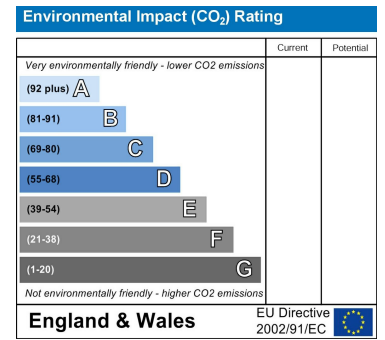
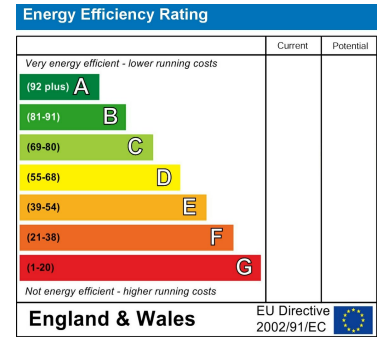

## Floorplan

GROUND FLOOR  
1365 sq.ft. (126.8 sq.m.) approx.

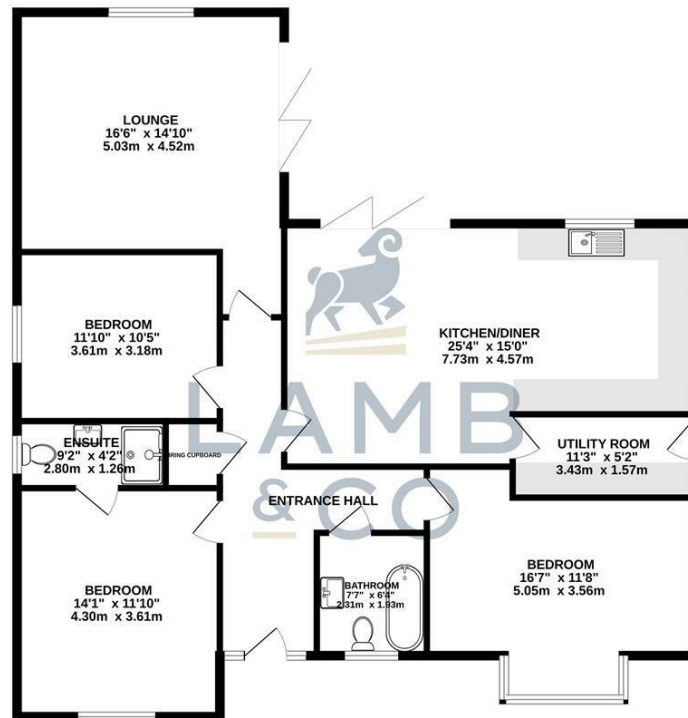

TOTAL FLOOR AREA: 1365 sq.ft. (126.8 sq.m.) approx.  
Whilst every attempt has been made to ensure the accuracy of the floorplan contained here, measurements of doors, windows, rooms and any other items are approximate and no responsibility is taken for any error, omission or mis-statement. This plan is for illustrative purposes only and should be used as such by any prospective purchaser. The services, systems and appliances shown have not been tested and no guarantee as to their operability or efficiency can be given.  
Made with Metrispice ©2023

These particulars, whilst believed to be accurate are set out as a general outline only for guidance and do not constitute any part of an offer or contract. Intending purchasers should not rely on them as statements of representation of fact, but must satisfy themselves by inspection or otherwise as to their accuracy. No person in this firm's employment has the authority to make or give any representation or warranty in respect of the property.