



LAMB & CO

Call us on 01255 422 240
Inspired by property, driven by passion.



QUEENSWAY, HOLLAND-ON-SEA, CO15 5LX

OIEO £475,000

Located in one of Holland-On-Sea's most desirable streets, this impressive family home boasts four bedrooms and three reception rooms, including a 24'10 extended family room with bi-fold doors. The property also benefits from a well-maintained garden, garage and parking for several vehicles.

- Four Bedrooms
- Three Reception Rooms
- Utility Room
- Garage & Parking
- Holland-On-Sea
- EPC: E

Accommodation comprises with approximate room sizes as follows:

Entrance door to:

ENTRANCE HALL

DINING ROOM

12'2" x 11'9" (3.71 x 3.58)



LOUNGE

24'10" x 15'7" (7.57m x 4.75m)



FAMILY ROOM

14'0 x 12'0 (4.27m x 3.66m)

KITCHEN

12'5" x 8'7" (3.78 x 2.62)



BREAKFAST ROOM

8'0" x 7'6" (2.44 x 2.29)



UTILITY AREA

6'9" x 6'0" max (2.06m x 1.83m max)



REAR LOBBY

SHOWER ROOM

8'4 x 5'7 (2.54m x 1.70m)



BEDROOM FOUR

19'1" x 9'1" (5.82 x 2.77)



GARAGE

15'6 x 7'9 (4.72m x 2.36m)

FIRST FLOOR

FIRST FLOOR LANDING

BATHROOM

12'1" x 8'8" (3.68 x 2.64)



BEDROOM ONE

15'6" x 12'1" (4.72 x 3.68)



BEDROOM TWO

12'2" x 11'2" (3.71 x 3.40)



BEDROOM THREE

12'0" x 7'6" (3.66 x 2.29)



OUTSIDE



OUTSIDE REAR

Approx. 18.29 x 12.50



Agents Note Sales

PLEASE NOTE - Although we have not tested any of the Gas/Electrical Fixtures & Fittings, we understand them to be in good working order, however it is up to any interested party to satisfy themselves of their condition before entering into any Legal Contract.

Council Tax Band: E

EPC: E

Heating: Gas Central.

AML

ANTI-MONEY LAUNDERING REGULATIONS 2017 - In order to comply with regulations, prospective purchasers will be asked to produce photographic identification and proof of residence documentation once entering into negotiations for a property.

Additional Information Clacton

Council Tax Band: E
Heating: Gas Central Heating
Seller's Position: Needs To Find



Map



EPC Graphs

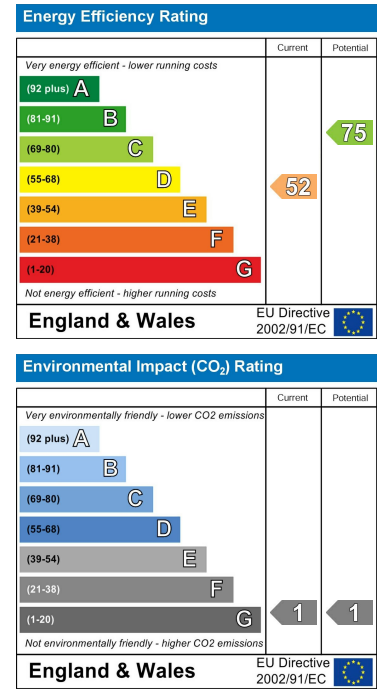

Floorplan

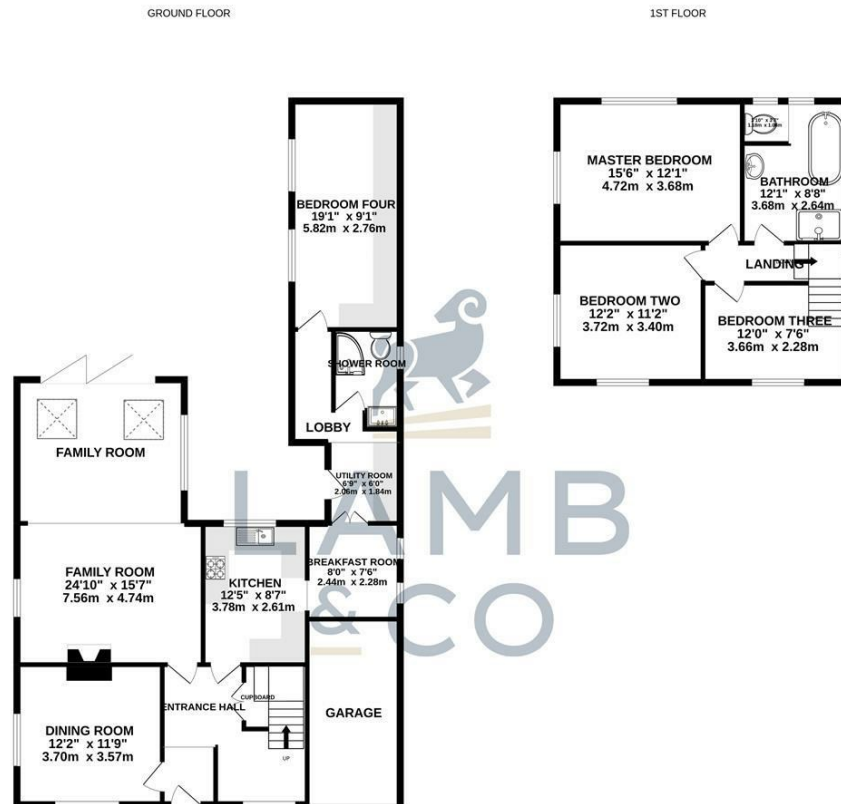

Whilst every attempt has been made to ensure the accuracy of the floorplan contained here, measurements of doors, windows, rooms and any other items are approximate and no responsibility is taken for any error, omission or misstatements. This plan is for illustrative purposes only and should be used as such by any prospective purchaser. The services, systems and appliances shown have not been tested and no guarantee as to their operability or efficiency can be given.
Made with Metropoli ©2022

These particulars, whilst believed to be accurate are set out as a general outline only for guidance and do not constitute any part of an offer or contract. Intending purchasers should not rely on them as statements of representation of fact, but must satisfy themselves by inspection or otherwise as to their accuracy. No person in this firm's employment has the authority to make or give any representation or warranty in respect of the property.