



49 Barcroft Street, Cleethorpes, North East Lincolnshire, DN35 7BG
£89,950

Key Features:

- Three Bedroom Mid Terrace Property
- Spacious & Well Presented
- Modern Fitted Kitchen
- Open Plan Lounge/Dining Room
- Downstairs Bathroom
- Three Good Sized Bedrooms
- Low Maintenance Gardens
- No Forward Chain

A well presented three bedroom mid terrace home located in this established area within close proximity to Cleethorpes seafront, a wide range of local amenities and easy access onto the A180. Offering spacious and well-maintained accommodation, comprising; a front entrance porch, open plan lounge/dining room, a modern fitted kitchen, downstairs bathroom, and to the first floor are three double bedrooms. Externally, the property stands in low maintenance gardens. Offered for sale with No Forward Chain.



LOUNGE/DINING ROOM

27'1" x 12'11" (8.26 x 3.95)

A dual aspect double reception room, having a bay window to the front, and dining space with window to the rear. Staircase with useful understairs cupboard.

KITCHEN

15'9" x 7'1" (4.81 x 2.17)

Fitted with a range of grey shaker style units, contrasting work surfaces incorporating a stainless steel sink, built-in oven, ceramic hob, plumbing for a washing machine and dishwasher. Side aspect window.

REAR ENTRANCE LOBBY

With ideal space for a fridge/freezer.

BATHROOM

7'10" x 5'8" (2.41 x 1.75)

Fitted with a pedestal basin, wc, and panelled bath with overhead shower. Heated towel rail.

FIRST FLOOR LANDING

A split level landing with access to the loft.

BEDROOM 1

12'9" x 12'0" (3.89 x 3.67)

To front aspect.

BEDROOM 2

15'10" x 7'4" (4.83 x 2.24)

To rear aspect, with cupboard housing the gas central heating boiler.

BEDROOM 3

12'3" x 7'8" (3.75 x 2.35)

To rear aspect.

OUTSIDE

The property stands in paved gardens, the rear with garden store and gated access to the passageway.

TENURE

FREEHOLD

COUNCIL TAX

A



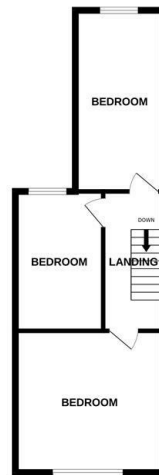
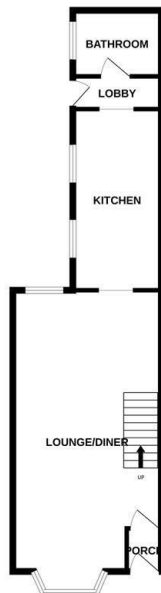

Whilst every attempt has been made to ensure the accuracy of the floorplan contained here, measurements of doors, windows, rooms and any other items are approximate and no responsibility is taken for any error, omission or mis-statement. This plan is for illustrative purposes only and should be used as such by any prospective purchaser. The services, systems and appliances shown have not been tested and no guarantee as to their operability or efficiency can be given.
Made with floorplan 32324

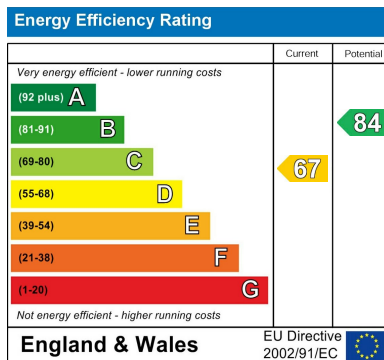

Viewing

By appointment only.

Tenure

We are advised by the vendor that the property is: As Above However, prospective purchasers should have the tenure of this property confirmed by a solicitor.

Additional Information Local Authority: North East Lincolnshire Council Telephone 01472 313 131

Services: All mains services are available or connected subject to the statutory regulations. we have not tested any heating systems, fixtures, appliances or services.

DISCLAIMER - IMPORTANT NOTICE REGARDING SALES PARTICULARS

Although we have taken great care to ensure the accuracy of the information contained in these particulars, we specifically deny liability for any mistakes, omissions or errors and strongly advise that all proposed purchasers should satisfy themselves by inspection or otherwise, as to their correctness, prior to entering into any commitment to purchase. Any references to the condition, use or appearance of the property or appliances therein, are made for guidance only, and no warranties are given or implied by this information. It is not the Agents policy to check the position with regards to any planning permission or building regulation matters and as such all interested parties are advised to make their own enquiries., in order to ensure that any necessary consents have been obtained. Measurements are taken from wall to wall unless otherwise stated, with the metric conversion shown in brackets. Any plans or maps contained are for identification purposes only and are not for any other use but guidance and illustration. The Agents have not tested any apparatus, equipment, fixtures, fittings or services including central heating systems and cannot therefore