





£310,000

Located in Central Bletchley is this three-bedroom semi-detached on Birchfield Grove. The property is in need of re-modernisation and offers off-road parking, a private rear garden and separate reception rooms. Further benefits include being within walking distance to the high street and Bletchley train station.

Property Description

ENTRANCE

Door to:

ENTRANCE HALL

Window to side. Stairs rising to first floor, doors to lounge and kitchen, radiator.

LOUNGE

Window to front aspect. Wall-mounted light, radiator.

DINING ROOM

Window to rear aspect. Door to lean-to, radiator.

KITCHEN

Window to rear and side aspects, door to dining room, door to rear garden. Fitted with a range of wall-mounted and base units with rolled edge work surface over, space for washing machine, space for electric oven with gas hob, complementary tiling, porcelain sink with mixer tap, radiator, wall-mounted boiler.

LANDING

Window to side aspect. Doors to bedrooms and bathroom, loft access, storage cupboard.

BEDROOM ONE

Window to front aspect. Radiator, built-in wardrobe.

BEDROOM TWO

Window to rear aspect. Radiator, built-in wardrobe.

BEDROOM THREE

Windows to front and side aspects. Built-in wardrobe.

BATHROOM

Obscure window to rear aspect. Low level WC, pedestal wash hand basin, panelled bath, complementary tiling, radiator, wood effect flooring.

OUTSIDE

FRONT GARDEN

Path to front door, driveway, low level wooden fence, flower and shrub beds, spotlights.

REAR GARDEN

Lawn area, patio area, pond, greenhouse, flower and shrub beds, outbuildings, spotlights, shingled area.

GROUND FLOOR
459 sq.ft. (42.6 sq.m.) approx.

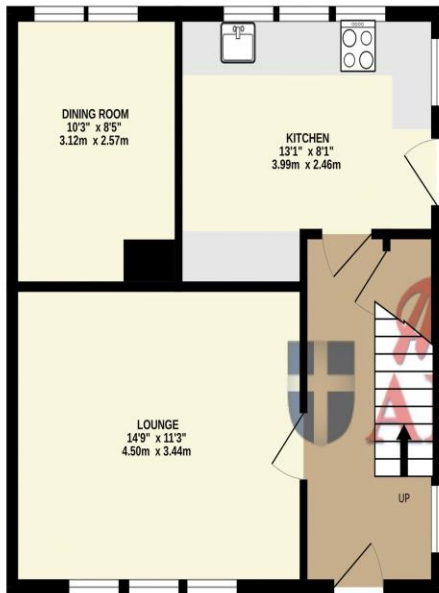

1ST FLOOR
460 sq.ft. (42.7 sq.m.) approx.

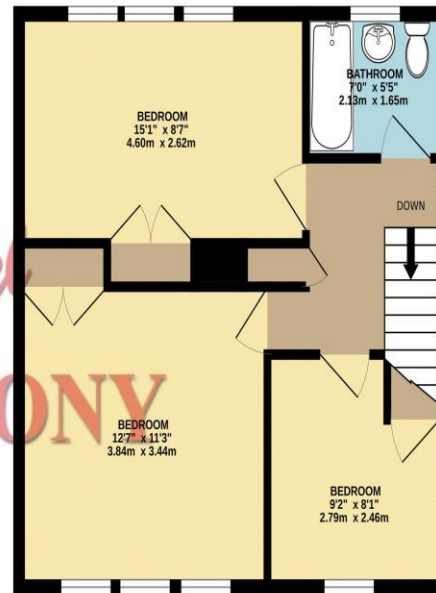

TOTAL FLOOR AREA : 919 sq.ft. (85.4 sq.m.) approx.

Whilst every attempt has been made to ensure the accuracy of the floorplan contained here, measurements of doors, windows, rooms and any other items are approximate and no responsibility is taken for any error, omission or mis-statement. This plan is for illustrative purposes only and should be used as such by any prospective purchaser. The services, systems and appliances shown have not been tested and no guarantee as to their operability or efficiency can be given.
Made with Metropix ©2026

MONEY LAUNDERING REGULATIONS 2017 intending purchasers will be asked to produce identification and proof of financial status when an offer is received. We would ask for your co-operation in order that there will be no delay in agreeing the sale.

THE CONSUMER PROTECTION REGULATIONS 2008 The Agent has not tested any apparatus, equipment, fixtures and fittings or services and so cannot verify that they are in working order or fit for the purpose. A Buyer is advised to obtain verification from their Solicitor or Surveyor. References to the Tenure of a Property are based on information supplied by the Seller. The Agent has not had sight of the title documents. A Buyer is advised to obtain verification from their Solicitor. You are advised to check the availability of this property before travelling any distance to view. We have taken every precaution to ensure that these details are accurate and not misleading. If there is any point which is of particular importance to you, please contact us and we will provide any information you require. This is advisable, particularly if you intend to travel some distance to view the property. The mention of any appliances and services within these details does not imply that they are in full and efficient working order. These particulars are in draft form awaiting Vendors confirmation of their accuracy. These details must therefore be taken as a guide only and approved details should be requested from the agents

190 Queensway Bletchley Milton Keynes MK2 2ST
01908 648 666 | bletchley@maea.co.uk