

**Offers in Excess of
£270,000**

Located in Fenny Stratford in Bletchley is this three-bedroom Victorian end terrace home. The property boasts a cloakroom, utility room, family bathroom and an open planned lounge/diner. Further benefits include a private southerly facing rear garden.

Property Description

ENTRANCE

UPVC door to:

CLOAKROOM

Double glazed window to side aspect. Low level WC, pedestal wash hand basin, tiled floor.

LOUNGE

Two double glazed windows to front aspect, double glazed window to rear aspect. Two radiators, stairs rising to first floor.

KITCHEN

Double glazed window to side aspect. Fitted with a range of wall-mounted and base units with square edge work surface over, space for dishwasher, integrated oven, four-ring gas hob, stainless steel sink with mixer tap.

UTILITY

Double glazed door to side. Work surface with space for fridge freezer, wall-mounted boiler, plumbing for washing machine and tumble dryer, tiled floor.

BEDROOM ONE

Double glazed window to front aspect. Radiator, storage cupboard.

BEDROOM TWO

Double glazed window to rear aspect. Radiator.

BEDROOM THREE

Double glazed window to rear aspect. Radiator.

BATHROOM

Low level WC, pedestal wash hand basin, bath with shower attachment, heated towel rail, tiled floor, part tiled walls.

OUTSIDE

REAR GARDEN

Mainly laid to lawn with patio area, enclosed by wooden fence panels, flower borders, gate to front access.

GROUND FLOOR
420 sq.ft. (39.1 sq.m.) approx.

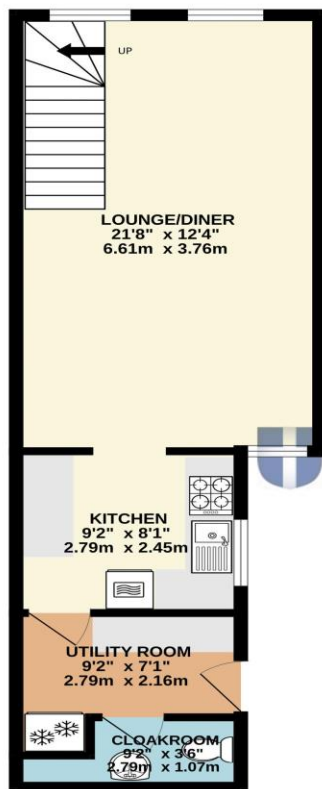

1ST FLOOR
341 sq.ft. (31.7 sq.m.) approx.

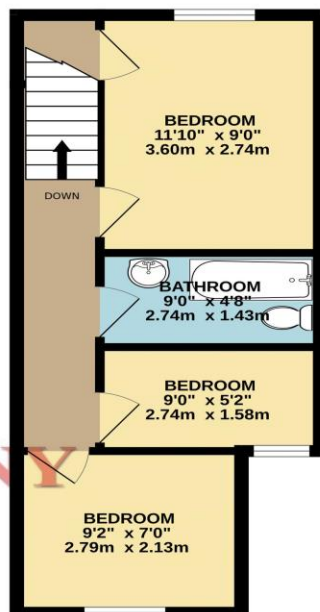

Michael
ANTHONY

TOTAL FLOOR AREA: 762 sq.ft. (70.7 sq.m.) approx.

Whilst every attempt has been made to ensure the accuracy of the floorplan contained here, measurements of doors, windows, rooms and any other items are approximate and no responsibility is taken for any error, omission or mis-statement. This plan is for illustrative purposes only and should be used as such by any prospective purchaser. The services, systems and appliances shown have not been tested and no guarantee as to their operability or efficiency can be given.
Made with Metropix ©2025

MONEY LAUNDERING REGULATIONS 2017 intending purchasers will be asked to produce identification and proof of financial status when an offer is received. We would ask for your co-operation in order that there will be no delay in agreeing the sale.

THE CONSUMER PROTECTION REGULATIONS 2008 The Agent has not tested any apparatus, equipment, fixtures and fittings or services and so cannot verify that they are in working order or fit for the purpose. A Buyer is advised to obtain verification from their Solicitor or Surveyor. References to the Tenure of a Property are based on information supplied by the Seller. The Agent has not had sight of the title documents. A Buyer is advised to obtain verification from their Solicitor. You are advised to check the availability of this property before travelling any distance to view. We have taken every precaution to ensure that these details are accurate and not misleading. If there is any point which is of particular importance to you, please contact us and we will provide any information you require. This is advisable, particularly if you intend to travel some distance to view the property. The mention of any appliances and services within these details does not imply that they are in full and efficient working order. These particulars are in draft form awaiting Vendors confirmation of their accuracy. These details must therefore be taken as a guide only and approved details should be requested from the agents

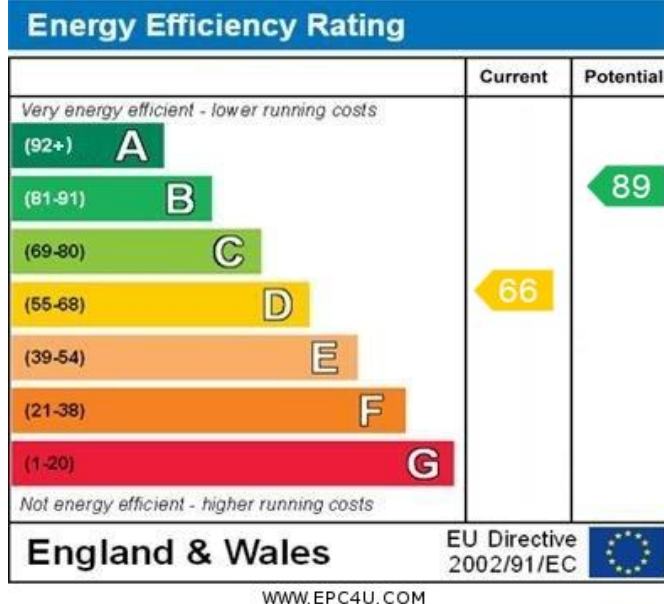

190 Queensway Bletchley Milton Keynes MK2 2ST
01908 648 666 | bletchley@maea.co.uk