







**£260,000**

Located in Furzton is this two-bedroom semi-detached bungalow offered to the market with no chain. The property comprises a kitchen, lounge/diner, two bedrooms, bathroom and rear garden. Further benefits include off-road parking.

# Property Description

## ENTRANCE

Double glazed frosted door to:

## ENTRANCE HALL

Doors to bedrooms, bathroom and lounge/diner, storage heater.

## LOUNGE/DINING ROOM

Double glazed window to front aspect. Storage cupboard, storage heater, door to kitchen.

## KITCHEN

Double glazed window to front aspect. Fitted with a range of base and eye level units with work surface over, space for washing machine and fridge, stainless steel sink with mixer tap, integrated electric hob and oven with extractor hood over, splashback tiling.

## BEDROOM ONE

Double glazed window to rear aspect. Storage heater, loft access.

## BEDROOM TWO

Double glazed double doors to garden. Storage heater.

## BATHROOM

Frosted window with secondary glazing to side aspect. Low level WC, wash hand basin, panelled bath with shower attachment, splashback tiling.

## OUTSIDE

## PARKING

Off-road parking.

## FRONT GARDEN

Laid to lawn with gravel area, shrub/hedge borders.

## REAR GARDEN

Laid to lawn with patio area, shrub/hedge borders, side gated access.

GROUND FLOOR  
437 sq.ft. (40.6 sq.m.) approx.

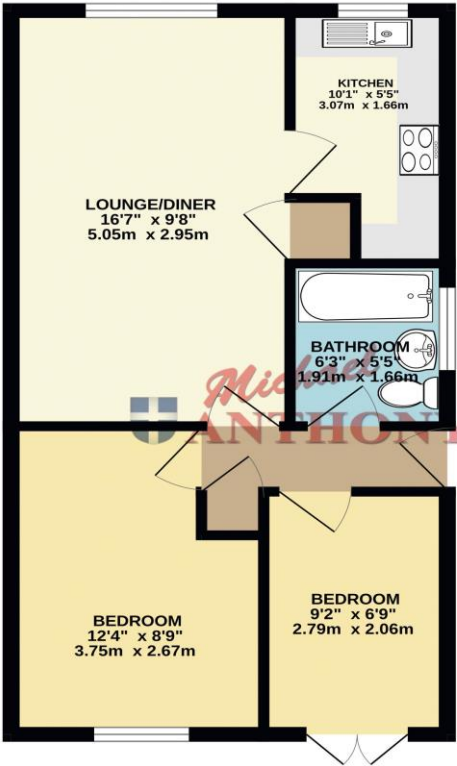

TOTAL FLOOR AREA: 437 sq.ft. (40.6 sq.m.) approx.  
Whilst every attempt has been made to ensure the accuracy of the floorplan contained here, measurements of doors, windows, rooms and any other items are approximate and no responsibility is taken for any error, omission or mis-statement. This plan is for illustrative purposes only and should be used as such by any prospective purchaser. The services, systems and appliances shown have not been tested and no guarantee as to their operability or efficiency can be given.  
Made with Metropix ©2024

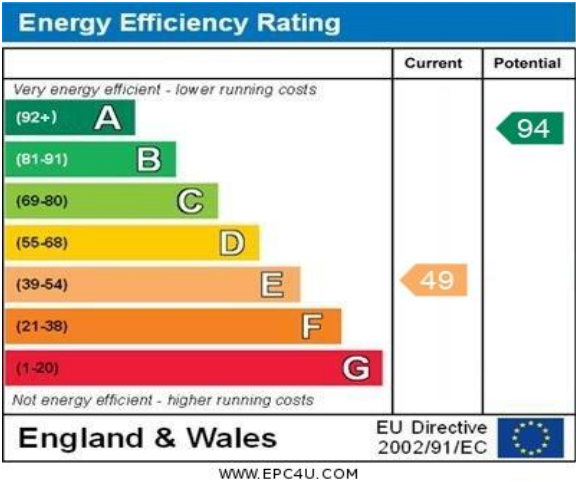

MONEY LAUNDERING REGULATIONS 2017 intending purchasers will be asked to produce identification and proof of financial status when an offer is received. We would ask for your co-operation in order that there will be no delay in agreeing the sale.

THE CONSUMER PROTECTION REGULATIONS 2008 The Agent has not tested any apparatus, equipment, fixtures and fittings or services and so cannot verify that they are in working order or fit for the purpose. A Buyer is advised to obtain verification from their Solicitor or Surveyor. References to the Tenure of a Property are based on information supplied by the Seller. The Agent has not had sight of the title documents. A Buyer is advised to obtain verification from their Solicitor. You are advised to check the availability of this property before travelling any distance to view. We have taken every precaution to ensure that these details are accurate and not misleading. If there is any point which is of particular importance to you, please contact us and we will provide any information you require. This is advisable, particularly if you intend to travel some distance to view the property. The mention of any appliances and services within these details does not imply that they are in full and efficient working order. These particulars are in draft form awaiting Vendors confirmation of their accuracy. These details must therefore be taken as a guide only and approved details should be requested from the agents

190 Queensway Bletchley Milton Keynes MK2 2ST  
01908 648 666 | bletchley@maea.co.uk