





**£425,000**

Located in a quiet cul-de-sac location on the Dovecote estate in Far Bletchley is this extended, four-bedroom detached family home. The property boasts a study, downstairs cloakroom, dining room, lounge, kitchen, utility room, family bathroom and en-suite to main bedroom. Externally the property benefits from a rear garden, garage and off road parking.

# Property Description

## **ENTRANCE**

UPVC door to entrance hall.

## **ENTRANCE HALL**

Doors to study, downstairs cloakroom and dining room.

## **CLOAKROOM**

Frosted double glazed window to rear aspect. Radiator, vanity wash hand basin, low level w.c. tiled splash back.

## **LOUNGE**

Double glazed triple bi-fold doors to garden and rear aspect, double glazed triple bi-fold doors to courtyard garden. Feature fireplace, two radiators, door to dining room.

## **DINING ROOM**

Double glazed window to side aspect. Sliding glass to kitchen, doors to kitchen and lounge, radiator, stairs to first floor.

## **STUDY**

Double glazed windows to front and rear aspects. Radiator.

## **KITCHEN**

Double glazed windows to side and rear aspects. Range of wall mounted and floor standing units with square edge work surface, integrated double oven and four ring gas hob with extractor fan over, space for dishwasher and fridge/freezer, open to utility room.

## **UTILITY ROOM**

Wall mounted boiler, double glazed door to rear garden, space for washing machine, larder cupboard and work surface.

## **LANDING**

Double glazed window to front aspect. Radiator, doors to bedrooms and bathroom, access to loft space.

## **BEDROOM ONE**

Two double glazed windows to side and front aspect. Two radiators, door to en-suite, wardrobes to remain.

## **EN-SUITE**

Low level w.c., wash hand basin, shower cubicle, part tiled walls, skylight.

## **BEDROOM TWO**

Double glazed window to rear aspect. Radiator, built in wardrobe.

## **BEDROOM THREE**

Double glazed window to rear aspect. Radiator.

## **BEDROOM FOUR**

Double glazed window to rear aspect. Radiator.

## **BATHROOM**

Frosted double glazed window to side aspect. Low level w.c., vanity wash hand basin, bath with shower over, heated towel rail.

## **OUTSIDE**

### **GARAGE**

Up and over door, power and light, courtesy door to courtyard garden.

### **COURTYARD GARDEN**

Block paved and enclosed by wooden fencing panels.

### **FRONT GARDEN**

Block paved providing off road parking for two cars.

### **REAR GARDEN**

Mainly laid to lawn with patio area, flower and shrub beds, outside tap, enclosed by wooden fencing panels.

GROUND FLOOR  
692 sq.ft. (64.3 sq.m.) approx.



1ST FLOOR  
672 sq.ft. (62.4 sq.m.) approx.

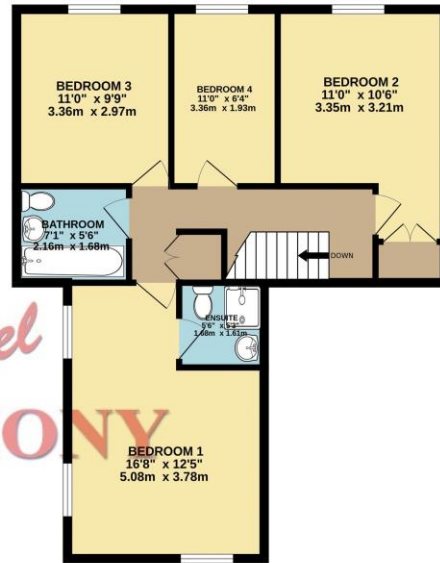

Michael  
ANTHONY

TOTAL FLOOR AREA: 1363 sq.ft. (126.7 sq.m.) approx.

Whilst every attempt has been made to ensure the accuracy of the floorplan contained here, measurements of doors, windows, rooms and any other items are approximate and no responsibility is taken for any error, omission or mis-statement. This plan is for illustrative purposes only and should be used as such by any prospective purchaser. The services, systems and appliances shown have not been tested and no guarantee is given as to their operability or efficiency can be given.  
Made with Metropix ©2024

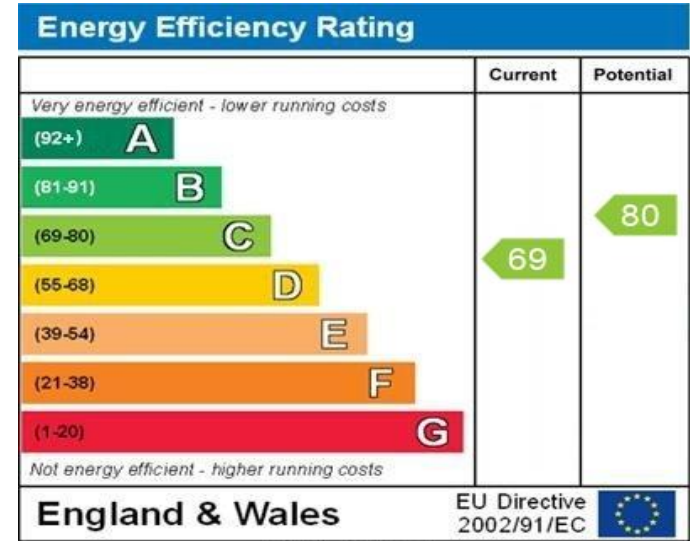

WWW.EPC4U.COM

MONEY LAUNDERING REGULATIONS 2017 intending purchasers will be asked to produce identification and proof of financial status when an offer is received. We would ask for your co-operation in order that there will be no delay in agreeing the sale.

THE CONSUMER PROTECTION REGULATIONS 2008 The Agent has not tested any apparatus, equipment, fixtures and fittings or services and so cannot verify that they are in working order or fit for the purpose. A Buyer is advised to obtain verification from their Solicitor or Surveyor. References to the Tenure of a Property are based on information supplied by the Seller. The Agent has not had sight of the title documents. A Buyer is advised to obtain verification from their Solicitor. You are advised to check the availability of this property before travelling any distance to view. We have taken every precaution to ensure that these details are accurate and not misleading. If there is any point which is of particular importance to you, please contact us and we will provide any information you require. This is advisable, particularly if you intend to travel some distance to view the property. The mention of any appliances and services within these details does not imply that they are in full and efficient working order. These particulars are in draft form awaiting Vendors confirmation of their accuracy. These details must therefore be taken as a guide only and approved details should be requested from the agents

190 Queensway Bletchley Milton Keynes MK2 2ST  
01908 648 666 | bletchley@maea.co.uk