





£310,000

Situated on the Castles estate in Far Bletchley is a two/three bedroom extended semi detached. The property boasts a lounge, kitchen, conservatory and a downstairs bedroom/study leading on to a wet room. Further benefits includes ample off road parking and generous sized rear garden. This property is being sold with no upper chain

Property Description

ENTRANCE

UPVC door to entrance hall.

ENTRANCE HALL

Storage cupboard, radiator, doors to lounge, kitchen and bedroom three.

LOUNGE

Double glazed window to front aspect, sliding patio door to conservatory, serving hatch to kitchen. Radiator, electric feature fireplace.

CONSERVATORY

Half brick with double glazed windows to side and rear aspects, double glazed double doors to garden.

KITCHEN

Double glazed window to rear aspect, double glazed door to garden. Range of wall and floor standing units with roll edge work surface, serving hatch to lounge, space for washing machine and dishwasher, integrated electric oven and hob with extractor fan over, integrated fridge and under counter freezer, one and a half stainless steel sink with mixer tap, tiled splash back, wall mounted boiler, radiator.

BEDROOM THREE

Double glazed window to front aspect. Radiator, sliding door to wetroom.

WETROOM

Frosted double glazed window to rear aspect. Low level w.c., pedestal wash hand basin, shower area.

LANDING

Double glazed window to front aspect. Storage cupboard, doors to bedrooms one and two and family bathroom.

BEDROOM ONE

Double glazed windows to front and rear aspects. Radiator, built in cupboard.

BEDROOM TWO

Double glazed window to rear aspect. Radiator, built in cupboard.

BATHROOM

Frosted double glazed window to rear aspect. Low level w.c., vanity wash hand basin, bath with shower over, tiled walls, radiator.

OUTSIDE

FRONT GARDEN

Block paved providing off road parking for two cars, lawn area with flower and hedge borders.

REAR GARDEN

Mainly laid to lawn with two patio areas, flower and shrub borders, side gated access, hedgerow border and wooden fencing panels.

GROUND FLOOR
635 sq.ft. (59.0 sq.m.) approx.



1ST FLOOR
330 sq.ft. (30.7 sq.m.) approx.

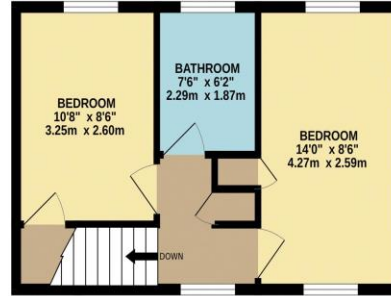

TOTAL FLOOR AREA : 965 sq.ft. (89.6 sq.m.) approx.

Whilst every attempt has been made to ensure the accuracy of the floorplan contained here, measurements of doors, windows, rooms and any other items are approximate and no responsibility is taken for any error, omission or mis-statement. This plan is for illustrative purposes only and should be used as such by any prospective purchaser. The services, systems and appliances shown have not been tested and no guarantee as to their operability or efficiency can be given.
Made with Metropix ©2024

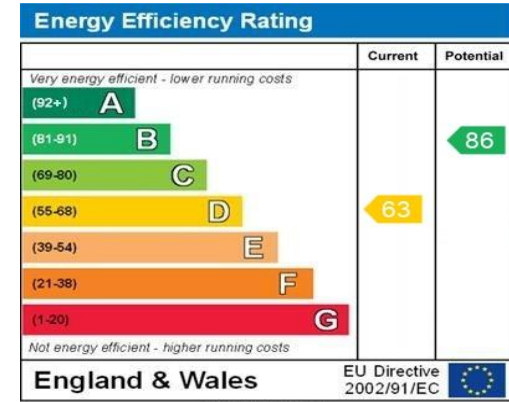

MONEY LAUNDERING REGULATIONS 2017 intending purchasers will be asked to produce identification and proof of financial status when an offer is received. We would ask for your co-operation in order that there will be no delay in agreeing the sale.

THE CONSUMER PROTECTION REGULATIONS 2008 The Agent has not tested any apparatus, equipment, fixtures and fittings or services and so cannot verify that they are in working order or fit for the purpose. A Buyer is advised to obtain verification from their Solicitor or Surveyor. References to the Tenure of a Property are based on information supplied by the Seller. The Agent has not had sight of the title documents. A Buyer is advised to obtain verification from their Solicitor. You are advised to check the availability of this property before travelling any distance to view. We have taken every precaution to ensure that these details are accurate and not misleading. If there is any point which is of particular importance to you, please contact us and we will provide any information you require. This is advisable, particularly if you intend to travel some distance to view the property. The mention of any appliances and services within these details does not imply that they are in full and efficient working order. These particulars are in draft form awaiting Vendors confirmation of their accuracy. These details must therefore be taken as a guide only and approved details should be requested from the agents