

£215,000

Located in Fenny Stratford is this delightful two bedroom house which offers separate lounge and dining room and kitchen with access to the rear garden. The bathroom is upstairs which is accessible via bedroom two. Viewing is advised.

Property Description

ENTRANCE

Wooden door to lounge.

LOUNGE

Double glazed window to front aspect. Radiator, door to dining room, television point.

DINING ROOM

Double glazed window to rear aspect. Radiator, understairs storage, doors to lounge and kitchen.

KITCHEN

Double glazed window to side aspect, wooden door to garden. Range of wall and floor standing units with work surface over, tiled splash back, one and a half stainless steel sink with mixer tap, space for cooker, wall mounted boiler, radiator, door to dining room.

LANDING

Doors to bedrooms.

BEDROOM ONE

Double glazed window to front aspect. Built in wardrobe, radiator.

BEDROOM TWO

Double glazed window to rear aspect. Built in wardrobe, radiator, door to bathroom, television point.

BATHROOM

Double glazed window to rear aspect. Pedestal wash hand basin, electric shower over bath, part tiled walls, radiator, heated towel rail, door to bedroom two.

OUTSIDE

REAR GARDEN

Mainly laid to lawn with flower beds, gravel and patio area, enclosed by wooden fencing panels, rear gated access.

GROUND FLOOR
297 sq.ft. (27.6 sq.m.) approx.

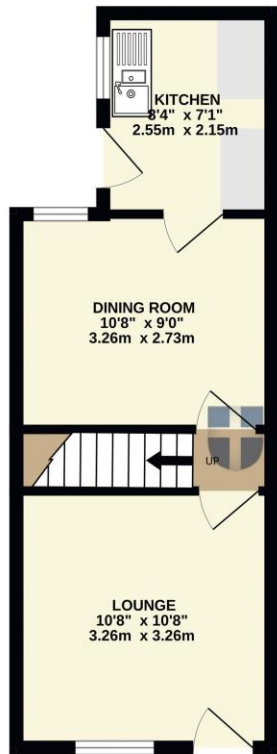

1ST FLOOR
297 sq.ft. (27.6 sq.m.) approx.

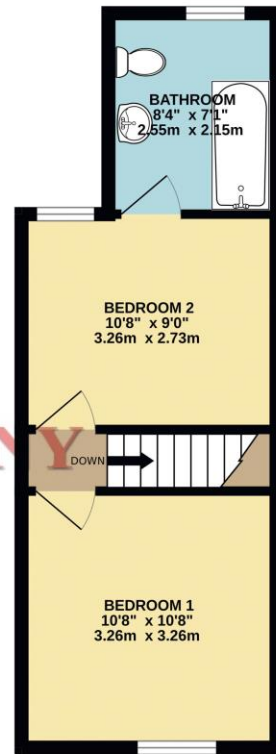

Michael
ANTHONY

TOTAL FLOOR AREA : 594 sq.ft. (55.2 sq.m.) approx.

Whilst every attempt has been made to ensure the accuracy of the floorplan contained here, measurements of doors, windows, rooms and any other items are approximate and no responsibility is taken for any error, omission or mis-statement. This plan is for illustrative purposes only and should be used as such by any prospective purchaser. The services, systems and appliances shown have not been tested and no guarantee is given as to their operability or efficiency can be given.
Made with Metropix ©2023

MONEY LAUNDERING REGULATIONS 2017 intending purchasers will be asked to produce identification and proof of financial status when an offer is received. We would ask for your co-operation in order that there will be no delay in agreeing the sale.

THE CONSUMER PROTECTION REGULATIONS 2008 The Agent has not tested any apparatus, equipment, fixtures and fittings or services and so cannot verify that they are in working order or fit for the purpose. A Buyer is advised to obtain verification from their Solicitor or Surveyor. References to the Tenure of a Property are based on information supplied by the Seller. The Agent has not had sight of the title documents. A Buyer is advised to obtain verification from their Solicitor. You are advised to check the availability of this property before travelling any distance to view. We have taken every precaution to ensure that these details are accurate and not misleading. If there is any point which is of particular importance to you, please contact us and we will provide any information you require. This is advisable, particularly if you intend to travel some distance to view the property. The mention of any appliances and services within these details does not imply that they are in full and efficient working order. These particulars are in draft form awaiting Vendors confirmation of their accuracy. These details must therefore be taken as a guide only and approved details should be requested from the agents

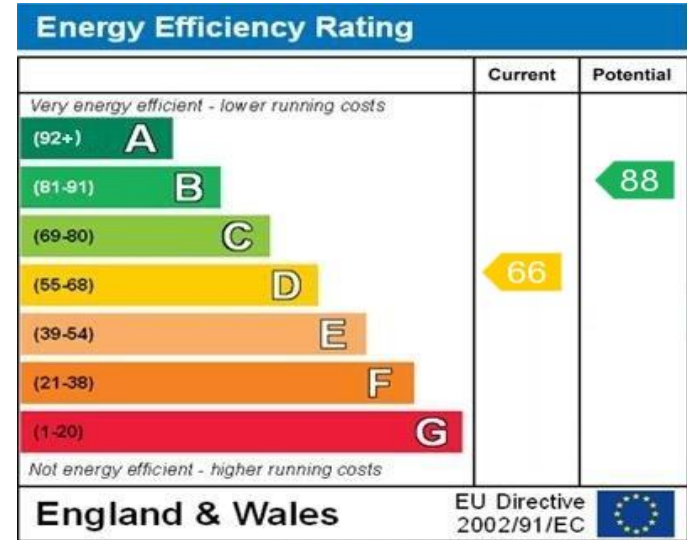

WWW.EPC4U.COM

190 Queensway Bletchley Milton Keynes MK2 2ST
01908 648 666 | bletchley@maea.co.uk