





£160,000

****50% SHARED OWNERSHIP**** Ideally located within the ever sought after location of Whitehouse this two bedroom terraced home is offered to the market on the popular shared ownership scheme. The accommodation comprises a lounge, kitchen/diner, downstairs cloakroom, family bathroom, rear garden and driveway parking.

Property Description

ENTRANCE

Door to:

ENTRANCE HALL

Doors to lounge, kitchen/diner and cloakroom, radiator, stairs rising to first floor.

CLOAKROOM

UPVC double glazed frosted window to front aspect. Low level WC with push button flush, radiator, pedestal wash hand basin, splashback tiling.

LOUNGE

UPVC double glazed window and door to rear. Radiator, television point, under stairs storage cupboard.

KITCHEN/DINER

UPVC double glazed window to front aspect. Fitted with a range of base and eye level units with rolled edge work surface over, one and a half bowl and drainer sink with mixer tap, oven and hob with extractor over, plumbing for dishwasher and washing machine, space for fridge freezer, radiator, wall-mounted combi boiler.

LANDING

Doors to bedrooms and bathroom, airing cupboard, radiator.

BEDROOM ONE

UPVC double glazed window to rear aspect. Radiator, access to loft space.

BEDROOM TWO

UPVC double glazed window to front aspect. Radiator.

BATHROOM

UPVC double glazed frosted window to front aspect. Pedestal wash hand basin, radiator, part tiled walls, panelled bath with mixer tap and shower attachment over, low level WC with push button flush, extractor fan.

OUTSIDE

FRONT GARDEN

Path to front door, flower/shrub beds, outside light, side gated access, driveway parking for two cars.

REAR GARDEN

Laid to lawn with patio area, outside tap, outside light, shed to remain, side gated access, flower and shrub beds, enclosed by timber fence panelling.

GROUND FLOOR
370 sq.ft. (34.3 sq.m.) approx.

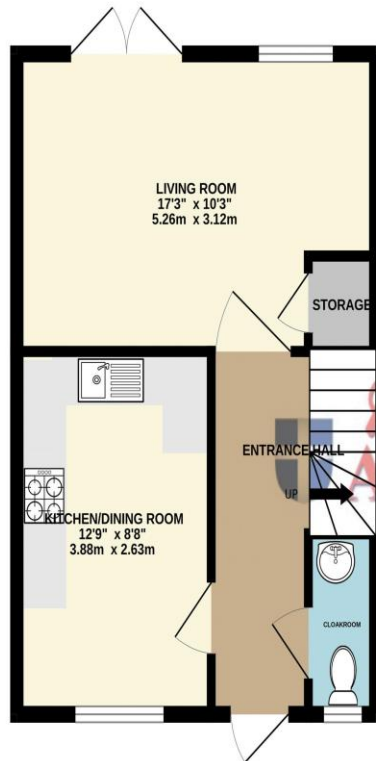

1ST FLOOR
370 sq.ft. (34.3 sq.m.) approx.

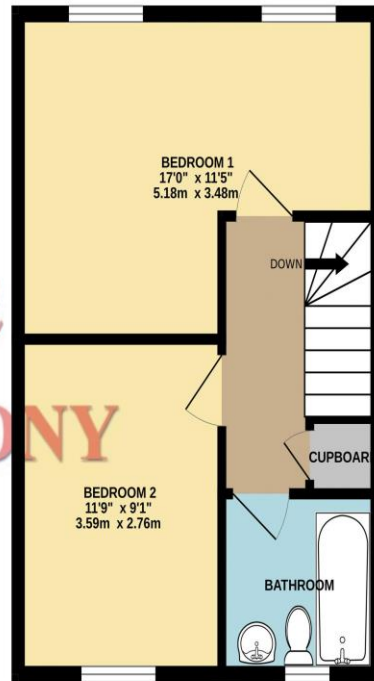

TOTAL FLOOR AREA: 739 sq.ft. (68.7 sq.m.) approx.

Whilst every attempt has been made to ensure the accuracy of the floorplan contained here, measurements of doors, windows, rooms and any other items are approximate and no responsibility is taken for any error, omission or mis-statement. This plan is for illustrative purposes only and should be used as such by any prospective purchaser. The services, systems and appliances shown have not been tested and no guarantee as to their operability or efficiency can be given.
Made with Metropix ©2024

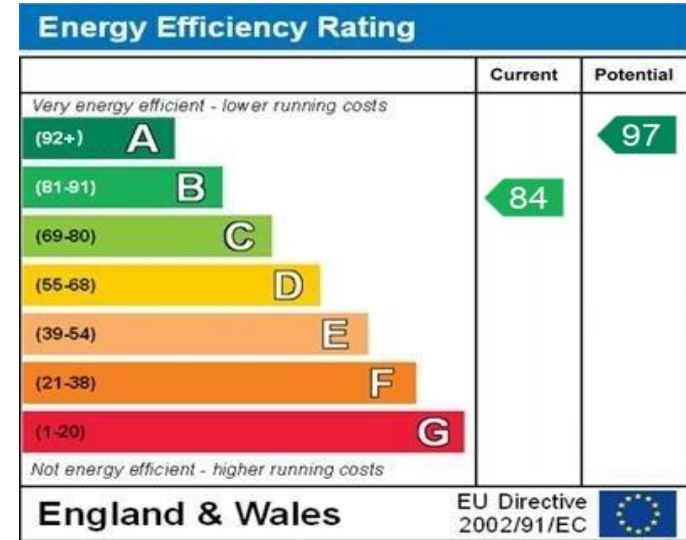

WWW.EPC4U.COM

MONEY LAUNDERING REGULATIONS 2017 intending purchasers will be asked to produce identification and proof of financial status when an offer is received. We would ask for your co-operation in order that there will be no delay in agreeing the sale.

THE CONSUMER PROTECTION REGULATIONS 2008 The Agent has not tested any apparatus, equipment, fixtures and fittings or services and so cannot verify that they are in working order or fit for the purpose. A Buyer is advised to obtain verification from their Solicitor or Surveyor. References to the Tenure of a Property are based on information supplied by the Seller. The Agent has not had sight of the title documents. A Buyer is advised to obtain verification from their Solicitor. You are advised to check the availability of this property before travelling any distance to view. We have taken every precaution to ensure that these details are accurate and not misleading. If there is any point which is of particular importance to you, please contact us and we will provide any information you require. This is advisable, particularly if you intend to travel some distance to view the property. The mention of any appliances and services within these details does not imply that they are in full and efficient working order. These particulars are in draft form awaiting Vendors confirmation of their accuracy. These details must therefore be taken as a guide only and approved details should be requested from the agents

209A Witan Gate Sovereign Court Milton Keynes Buckinghamshire MK9 2HP
01908 393 553 | miltonkeynes@maea.co.uk