







**£272,000**

Tucked away within a cul-de-sac location offering easy access to Milton Keynes City Centre this two bedroom end of terrace home benefits from a garage with driveway parking in front and accommodation comprising a lounge, kitchen/breakfast room, family bathroom and front and rear gardens.

# Property Description

## **ENTRANCE PORCH**

Storage cupboard, UPVC double glazed window to front aspect, UPVC double glazed door to:

## **LOUNGE**

UPVC double glazed windows to front and side aspects. Radiator, television point, flow through to kitchen.

## **KITCHEN/BREAKFAST ROOM**

UPVC double glazed door, UPVC double glazed window to rear aspect. Fitted with a range of base and eye level units with rolled edge work surface over, wall-mounted boiler, space for fridge freezer, plumbing for washing machine, stainless steel single drainer sink unit with mixer tap, oven and hob, part tiled walls, radiator.

## **LANDING**

Airing cupboard housing hot water tank, access to loft space, doors to bedrooms and bathroom.

## **BEDROOM ONE**

UPVC double glazed windows to front and rear aspects. Radiator, built-in cupboard.

## **BEDROOM TWO**

UPVC double glazed window to rear aspect. Radiator.

## **BATHROOM**

UPVC frosted window to rear aspect. Low level WC with push button flush, heated towel rail, panelled bath with mixer tap and shower attachment, pedestal wash hand basin, part tiled walls.

## **OUTSIDE**

### **GARAGE/ PARKING**

Driveway parking. Garage in a block.

### **FRONT GARDEN**

Path to front door, gated side access.

### **REAR GARDEN**

Laid to lawn with outside tap, outside light, rear and side gated access, enclosed by timber fence panelling.

GROUND FLOOR  
301 sq.ft. (28.0 sq.m.) approx.

1ST FLOOR  
280 sq.ft. (26.0 sq.m.) approx.

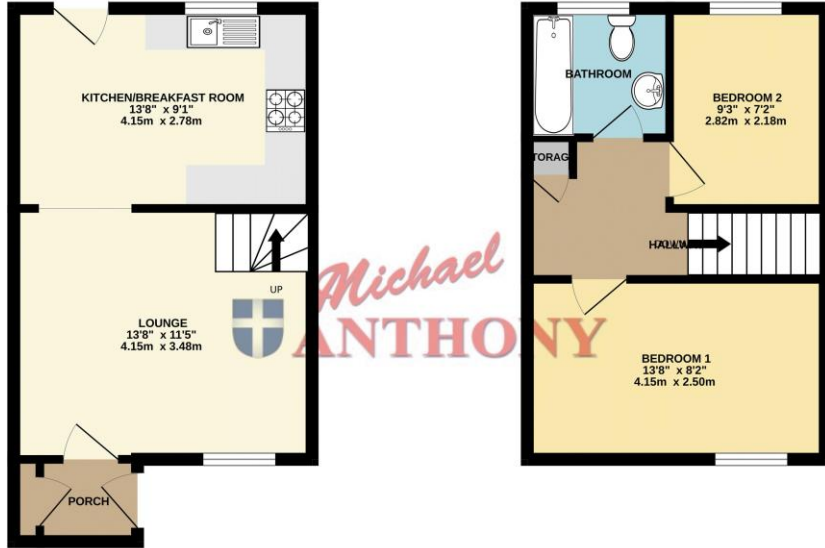

Michael ANTHONY

TOTAL FLOOR AREA: 581 sq.ft. (54.0 sq.m.) approx.

Whilst every attempt has been made to ensure the accuracy of the floorplan contained here, measurements of doors, windows, rooms and any other items are approximate and no responsibility is taken for any error, omission or mis-statement. This plan is for illustrative purposes only and should be used as such by any prospective purchaser. The services, systems and appliances shown have not been tested and no guarantee as to their operability or efficiency can be given.  
Made with Metropix 10/2014

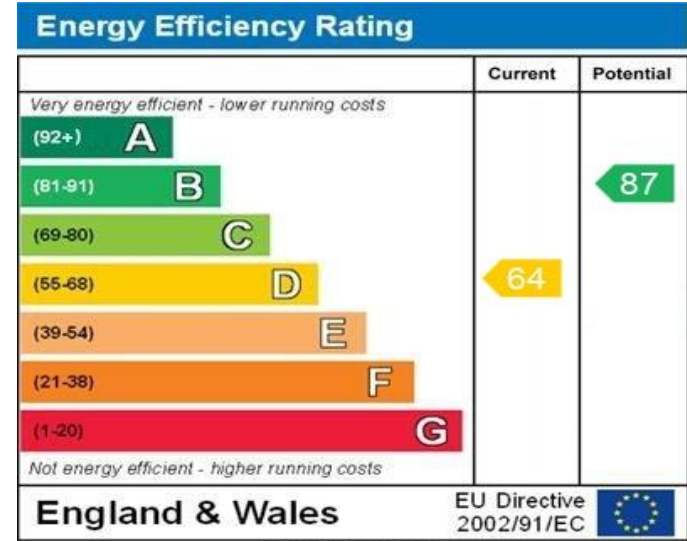

WWW.EPC4U.COM

MONEY LAUNDERING REGULATIONS 2017 intending purchasers will be asked to produce identification and proof of financial status when an offer is received. We would ask for your co-operation in order that there will be no delay in agreeing the sale.

THE CONSUMER PROTECTION REGULATIONS 2008 The Agent has not tested any apparatus, equipment, fixtures and fittings or services and so cannot verify that they are in working order or fit for the purpose. A Buyer is advised to obtain verification from their Solicitor or Surveyor. References to the Tenure of a Property are based on information supplied by the Seller. The Agent has not had sight of the title documents. A Buyer is advised to obtain verification from their Solicitor. You are advised to check the availability of this property before travelling any distance to view. We have taken every precaution to ensure that these details are accurate and not misleading. If there is any point which is of particular importance to you, please contact us and we will provide any information you require. This is advisable, particularly if you intend to travel some distance to view the property. The mention of any appliances and services within these details does not imply that they are in full and efficient working order. These particulars are in draft form awaiting Vendors confirmation of their accuracy. These details must therefore be taken as a guide only and approved details should be requested from the agents

209A Witan Gate Sovereign Court Milton Keynes Buckinghamshire MK9 2HP  
01908 393 553 | miltonkeynes@maea.co.uk