

RIVERHOMES

Airedale Avenue South
Chiswick W4

£1,750,000
Freehold



Airedale Avenue South Chiswick W4

Located within a stone's throw of the fashionable Chiswick Mall is this elegant fully extended four bedroom semi-detached Edwardian home. The property, which has been beautifully refurbished by its current owners, provides a flexible and versatile living space, and is further enhanced by off-street parking and garage/ancillary room which is currently used as a gym. Overlooking and adjacent to Homefield Recreational Grounds, the property is laid out over three floors. To the ground floor is the entrance hall leading onto large kitchen and skylit reception room with French

doors accessing the large, west-facing, mature patio/garden and garage, a separate private reception, living room with fireplace, an east-facing sitting room with bay windows, wooden floors and cast iron fireplace and a downstairs toilet. The first floor provides three double bedrooms (with two enclosed balconies, one facing west the other east) a family bathroom with toilet and a family shower room with toilet. The top floor houses a potential master suite with en suite bathroom and lots of natural lighting provided by three skylights.

KEY FEATURES

Four bedroom semi-detached home

Beautifully refurbished

Off-street parking

Garage/ancillary room

West-facing, mature patio/garden

Fireplace

Two enclosed balconies





ENERGY PERFORMANCE CERTIFICATE

| Score | Energy rating | Current | Potential |
|-------|---------------|---------|-----------|
| 92+ | A | | |
| 81-91 | B | | |
| 69-80 | C | | |
| 55-68 | D | 55 D | 66 D |
| 39-54 | E | | |
| 21-38 | F | | |
| 1-20 | G | | |

KEY INFORMATION

| | |
|------------------|----------------------------|
| Local authority: | London Borough of Hounslow |
| Internal area: | 2,529 sq. ft. / 235 sq. m. |
| No. of bedrooms: | 4 |
| Tax Band: | F |

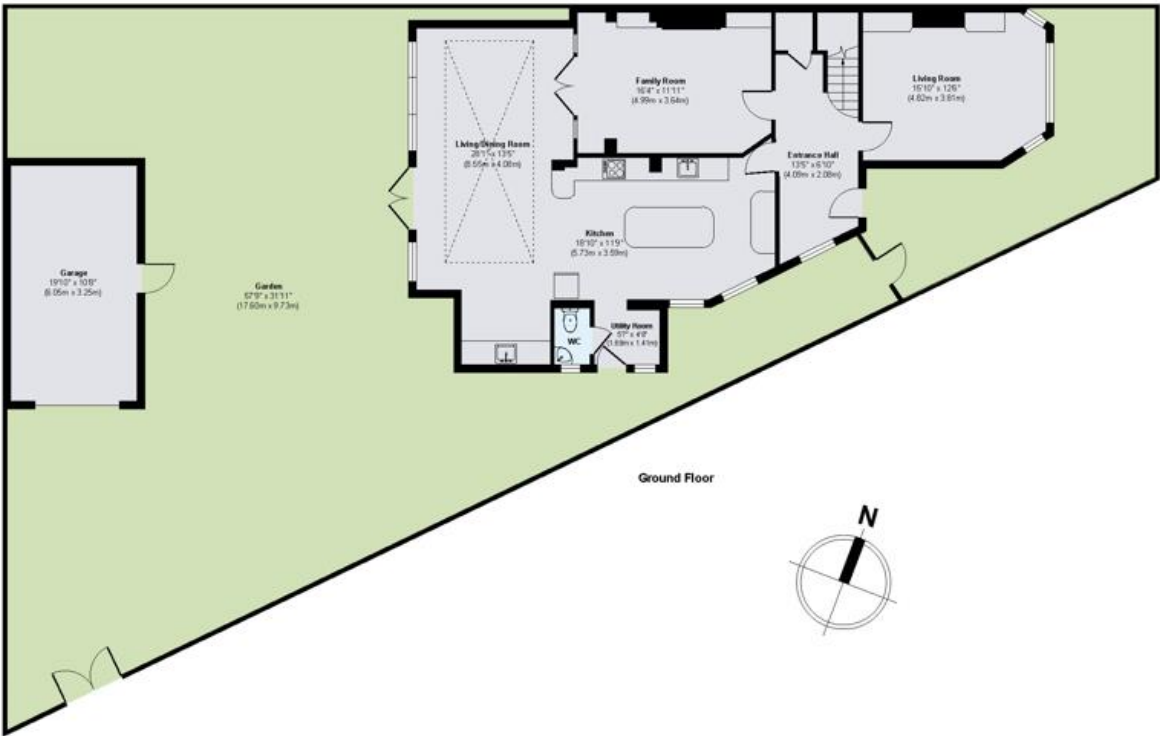
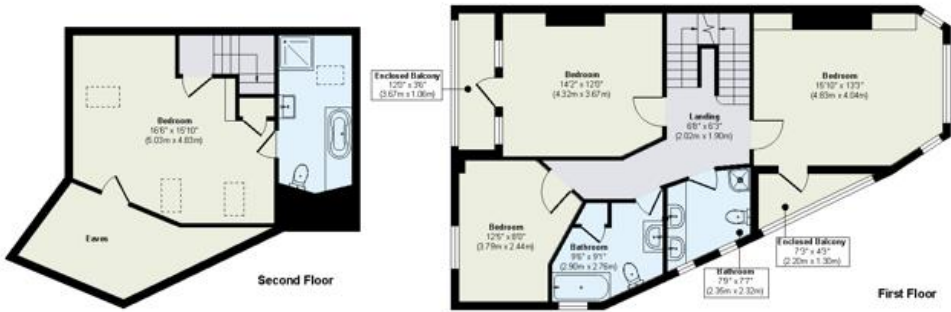

World Waterside Ltd trading as riverhomes for themselves and its clients give notice that 1: They are not authorised to make or give any representations or warranties in relation to the property either here or elsewhere, either on their own behalf or on behalf of their client or otherwise. 2: These particulars do not form part of any offer or contract and must not be relied upon as statements or representations of fact. Any areas, measurements or distances are approximate. The text, photographs and plans are for guidance only and are not necessarily comprehensive. 3: It should not be assumed that the property has all necessary planning, building regulation or other consents and any services, equipment or facilities have not been tested. 4: Lease details, service charges, ground rent (where applicable) and council tax are given as a guide only and should be checked and confirmed by your Solicitor prior to exchange of contracts. 5: They assume no responsibility and any intending purchasers or tenants must satisfy themselves by inspection or otherwise as to the correctness of each of the statements contained within these particulars. If you require clarification of any points please contact us.