

RIVERHOMES

Chiswick Mall
Hammersmith W6

£7,000 per month
Furnished



Chiswick Mall Hammersmith W6

SHORT LET

A truly unique riverside home with the original section of the house dating back to the 19th century, then transformed as part of St Peter's Wharf Scheme in 1971. Upon entering the cottage, you are met by a generous entrance hall & welcoming hallway, off which there are two bedrooms & large shower / utility room. To the first floor, a hallway provides access to a number of rooms, one of the highlights undoubtedly being the river views seen from the 22ft. reception room, which captivates the eye from the moment

the room is entered. Further features of the room itself are open plan, yet recessed kitchen to the rear from where the Thames can still be seen and a private, decked terrace with direct river views. Whilst the principal rooms to the first floor are those that look towards the water, others include a family bathroom and the master bedroom. Additionally benefitting from off-road parking, this is a truly unique and historic home, located in a beautiful setting and offering an occupier the opportunity of living amongst a community of likeminded, appreciative individuals.

KEY FEATURES

SHORT LET

Available from 28th March 2024 to 23rd April 2024

Available from 27th June to 31st August 2024

3 bedrooms

2 bathrooms

Large open-plan reception room

Direct river-facing views

Private decked terrace

Off-road parking

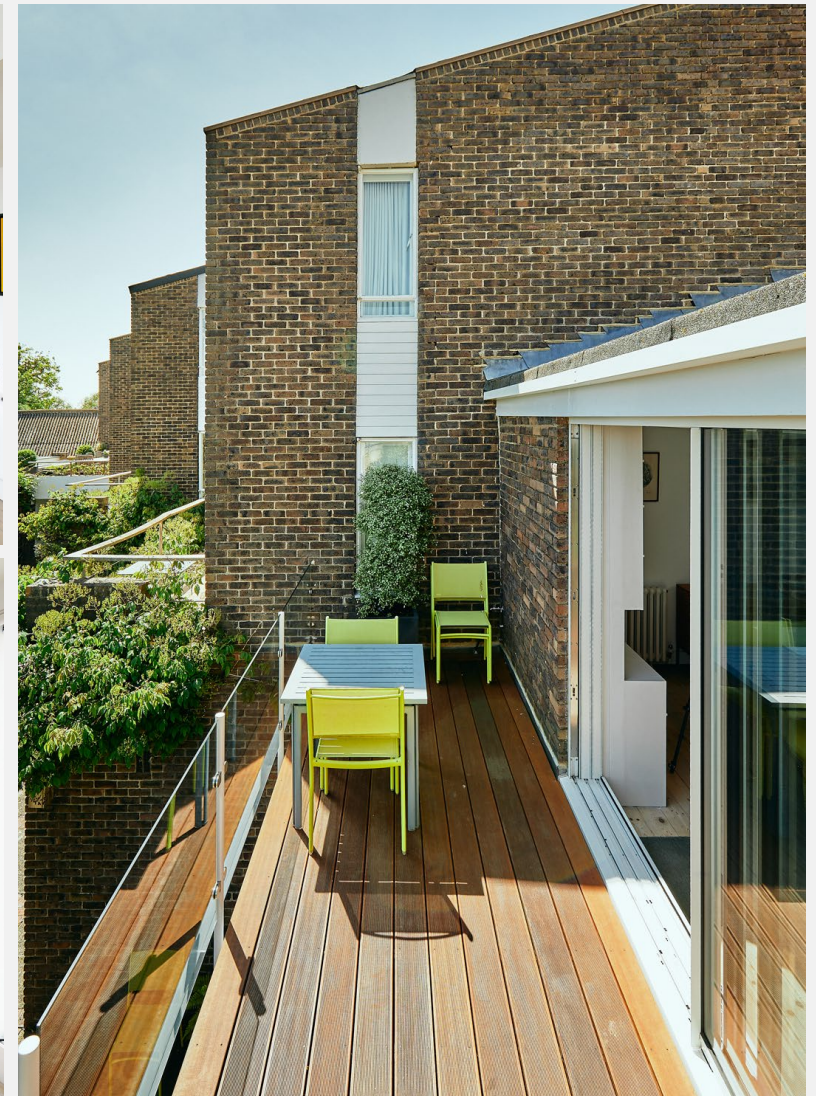



ENERGY PERFORMANCE CERTIFICATE

Score	Energy rating	Current	Potential
92+	A		
81-91	B		
69-80	C		72 C
55-68	D		
39-54	E	52 E	
21-38	F		
1-20	G		

KEY INFORMATION

Local authority:	London Borough of Hammersmith & Fulham
Internal area:	1,333 sq. ft. / 123.92 sq. m.
Council tax band:	G
Available from:	28 th March 2024 to 23 rd April 2024 27 th June 2024 to 31 st August 2024
No. of bedrooms:	3

