



## 10 Charterhouse Drive Solihull, B91 3FH

This immaculately presented unfurnished 3 bedroomed end of terrace home is part of a well-regarded development, offering not just a beautiful home but also an ideal location as it is within walking distance of Solihull Town Centre.

The property is adjacent to a charming communal green with a pond and resident waterfowl.

Solihull Town Centre hosts the renowned Touchwood complex offering residents easy access to upscale retail, dining, and entertainment options including a multi screen cinema theatre and library.

For leisure and outdoor activities, Tudor Grange Leisure Centre and Park are conveniently close by, providing residents with opportunities for recreation, exercise, and enjoying green spaces in the vicinity.

£1,695 PCM







# Floor Plan

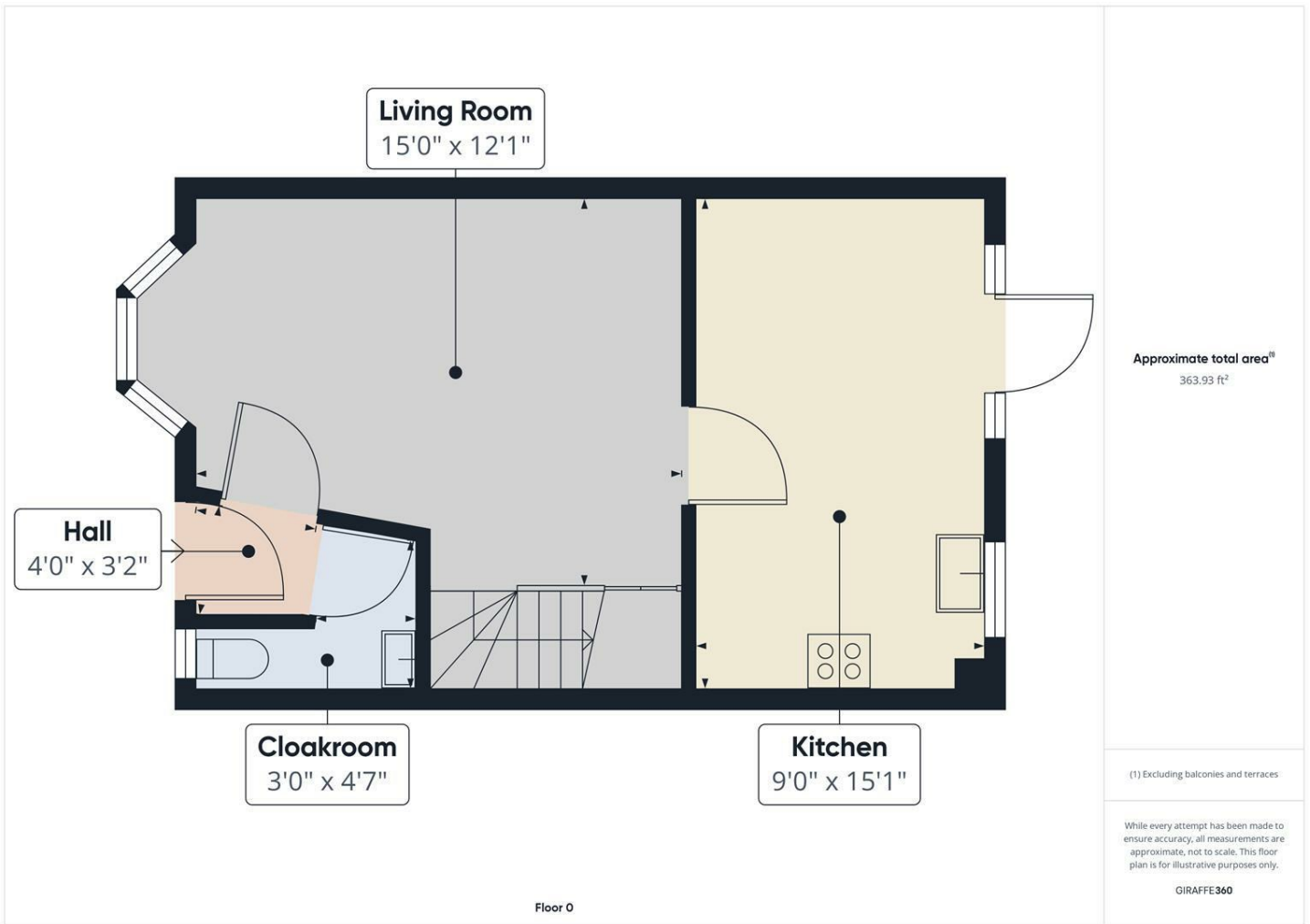

# Area Map



# Energy Efficiency Graph

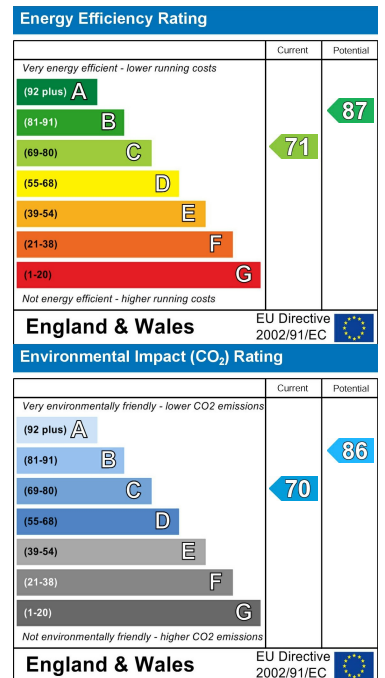

These particulars, whilst believed to be accurate are set out as a general outline only for guidance and do not constitute any part of an offer or contract. Intending purchasers should not rely on them as statements of representation of fact, but must satisfy themselves by inspection or otherwise as to their accuracy. No person in this firm's employment has the authority to make or give any representation or warranty in respect of the property.

Zenith House, Highlands Road, Solihull, B90 4PD

Tel: 01217112222 Email: info@solihullresidential.com www.solihullresidential.com