



**2c Perry Street  
Wendover  
Buckinghamshire  
HP22 6JT**

**Guide Price £475,000 Freehold**

A three bedroom semi detached home located on Perry Street in the centre of Wendover. The property is a lovely home with good accommodation, off road parking and a private enclosed rear garden. To fully appreciate this home we recommend an internal viewing at your earliest opportunity.

The accommodation on offer comprises: entrance hall, sitting room, dining room, kitchen, three bedrooms, with ensuite to the main bedroom, family bathroom. Outside there is driveway parking to the front and the enclosed rear garden is paved for low maintenance.

Wendover is a sought after village at the foot of the Chiltern Hills with a picturesque village centre. There are a variety of interesting shops, many restaurants, a weekly market and schooling for children of all ages. There is a main line railway station with regular trains to London Marylebone taking less than 50 minutes.



**Christopher Pallet**  
Professional advice since 1973



## Ground Floor

Approx. 40.5 sq. metres (435.8 sq. feet)

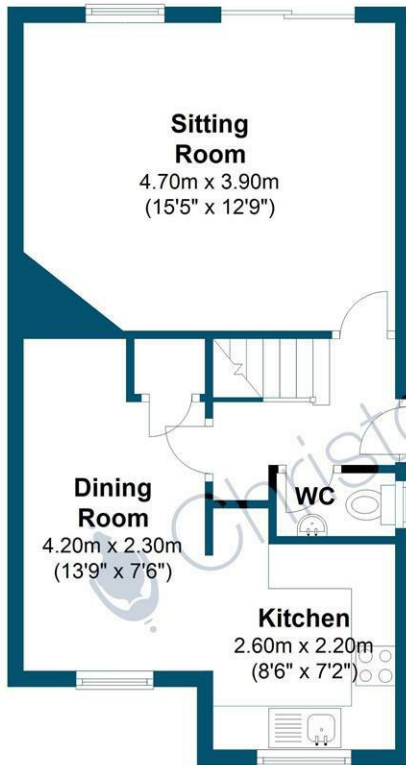

## First Floor

Approx. 40.6 sq. metres (437.2 sq. feet)

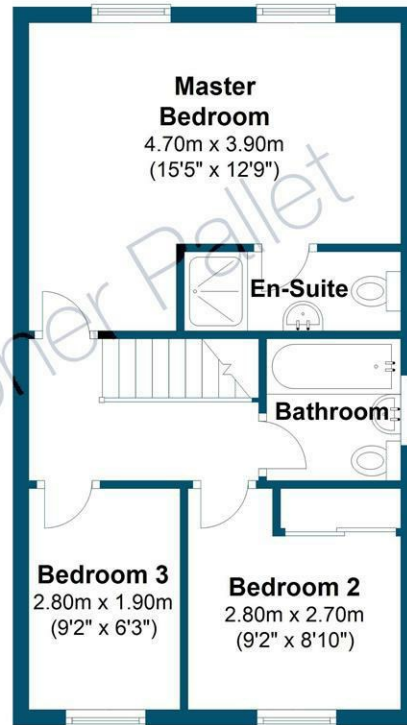

Total area: approx. 81.1 sq. metres (873.0 sq. feet)

For illustration purposes only - not to scale

## Directions

From the clock tower, proceed out on the Aylesbury Road, turn left opposite the petrol station in to Perry Street and the house is on the right.

## Energy Efficiency Rating

	Current	Potential
<i>Very energy efficient - lower running costs</i>		
(92 plus) <b>A</b>		
(81-91) <b>B</b>		<b>82</b>
(69-80) <b>C</b>		
(55-68) <b>D</b>	<b>61</b>	
(39-54) <b>E</b>		
(21-38) <b>F</b>		
(1-20) <b>G</b>		
<i>Not energy efficient - higher running costs</i>		
<b>England &amp; Wales</b>	EU Directive 2002/91/EC 	

## Viewing and Contact Details



### Christopher Pallet

8 High Street  
Wendover  
Bucks  
HP22 6EA

wendover@christopherpallet.com  
www.christopherpallet.com



**Christopher Pallet**  
Professional advice since 1973