

Flat 19, 2, Ashton Court Connington Crescent, London, E4 6LW
£1,750 Per Calendar Month

COMPLETION
SALES & LETTINGS



Flat 19, 2, Ashton Court Connington Crescent, London, E4 6LW

£1,750 Per Calendar Month

Council Tax Band: D

Nestled in the charming area of Chingford, this modern two-bedroom flat on Connington Crescent offers a delightful living experience. With a rental price of £1,750 per calendar month, this property is perfect for those seeking a comfortable and contemporary home.

Spanning an impressive 624 square feet, the flat boasts a well-designed layout that includes a spacious reception room, ideal for both relaxation and entertaining. The two generously sized bedrooms provide ample space for rest, while the presence of two bathrooms ensures convenience for residents and guests alike.

Constructed in 2006, this property reflects modern living with its stylish finishes and thoughtful design. The flat is situated in a desirable location, providing easy access to local amenities and transport links, making it an excellent choice for professionals and families alike.

Whether you are looking to enjoy the vibrant community of Chingford or simply seeking a comfortable retreat, this flat offers a perfect blend of modern convenience and homely charm. Do not miss the opportunity to make this lovely property your new home.

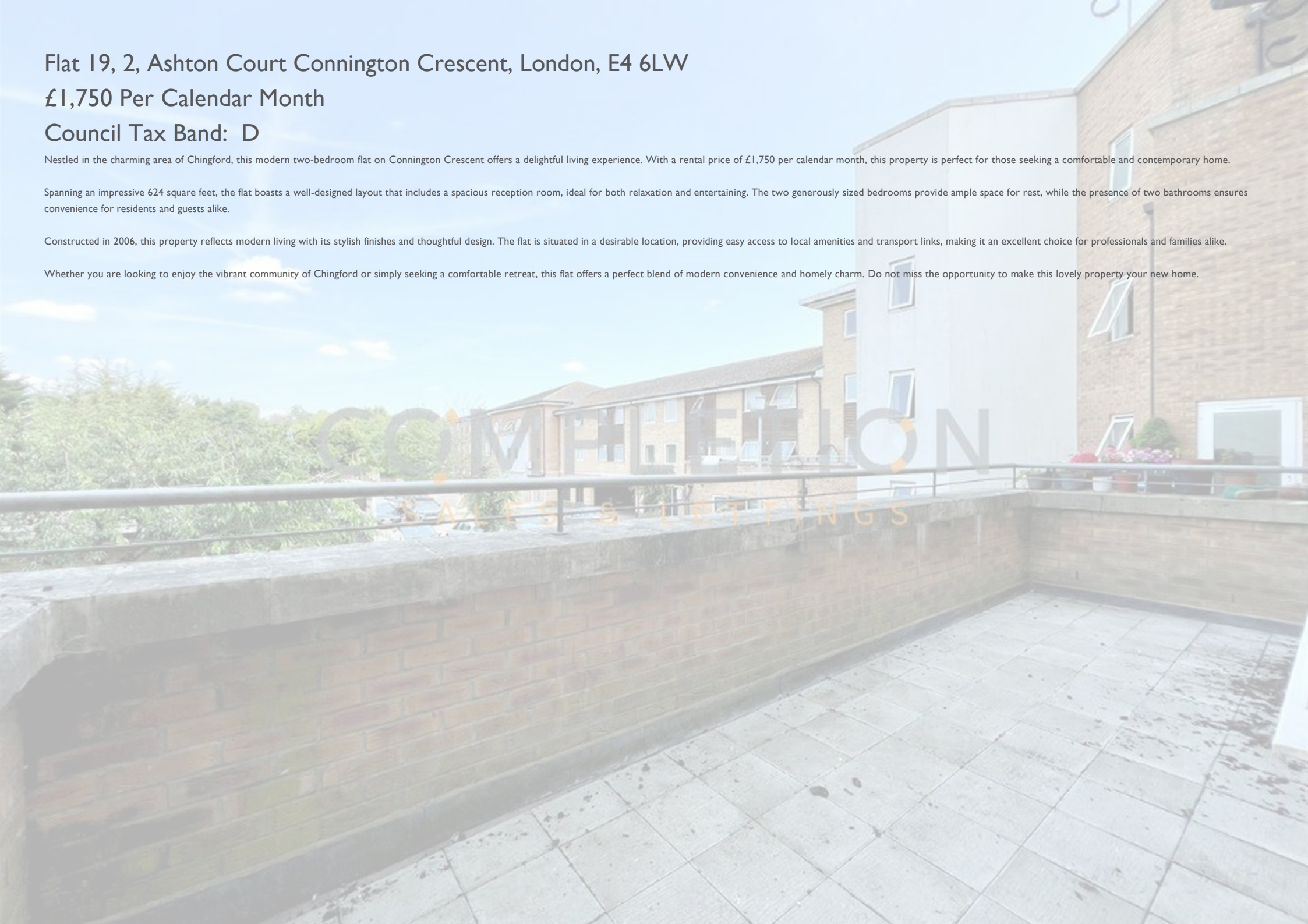



COMPLETION
SALES & LETTINGS

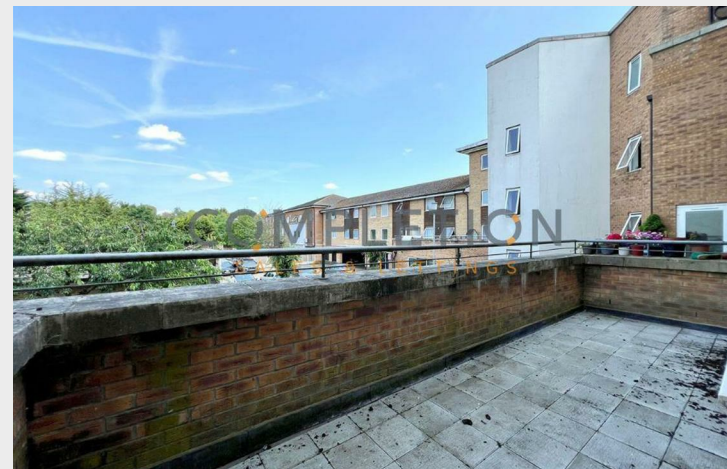

First Floor

Approx. 611.9 sq. feet

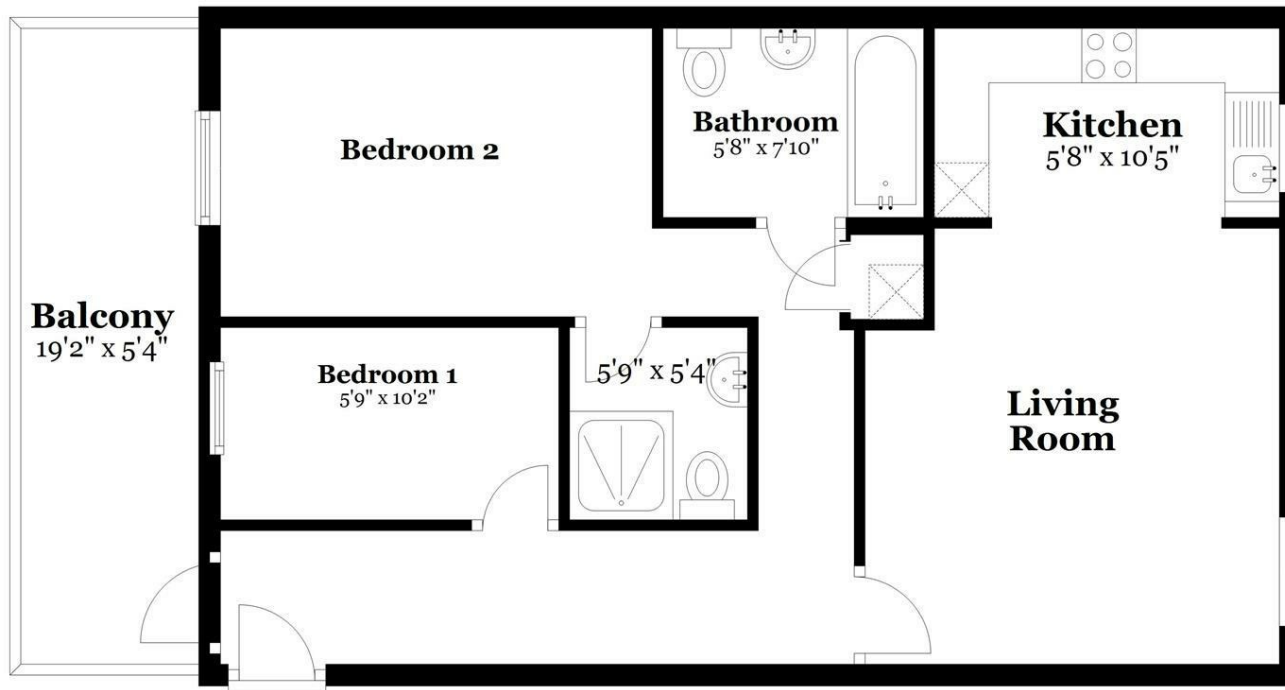

Total area: approx. 611.9 sq. feet

All measurements are appropriate and should not be relied upon.
Plan produced using PlanUp.

337 Forest Road

London

E17 5JR

02085277007

enquiries@completion.co.uk

completion.co.uk

Energy Efficiency Rating		
	Current	Potential
Very energy efficient - lower running costs		
(92 plus) A		
(81-91) B	81	84
(69-80) C		
(55-68) D		
(39-54) E		
(21-38) F		
(1-20) G		
Not energy efficient - higher running costs		
England & Wales EU Directive 2002/91/EC		