

40 Frith Road, London, E11 4EY
 Price Guide £850,000

FOR SALE

- Prime Walthamstow Location
- Brand New Refurbished
- Four Bedrooms
- Large Receptions
- Open Plan Kitchen
- Two Bathrooms
- Guest W.C.
- High Standard Built Quality
- Private Garden

Frith Road E17

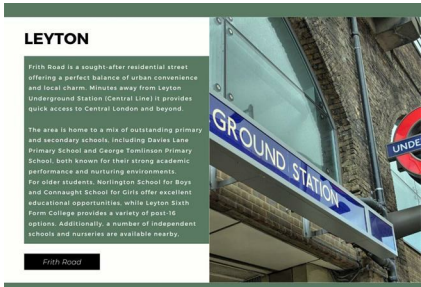
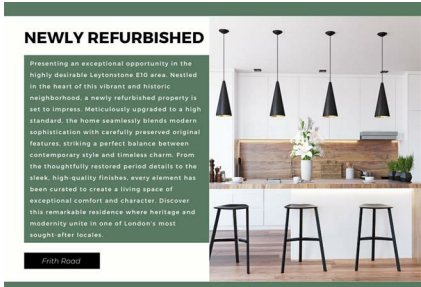

LOCATION

Shopping and entertainment, residents are just minutes away from the renowned Old Stratford City, one of Europe's largest shopping centers, offering a wide range of retail, dining, and leisure options. The local area is rich in amenities, including independent shops, cafés, and eateries, creating a vibrant community atmosphere.

Locally, Leytonstone offers green spaces like Wanstead Flats and Hollow Ponds, perfect for outdoor activities and relaxation. Frith Road combines the benefits of a historic neighborhood with unbeatable connectivity, making it an ideal choice for professionals, and investors alike.

Frith Road



IMAGES FOR ILLUSTRATION ONLY

INTERESTED?

If you would like to know more about this property or other similar houses, please feel free to contact us.

Frith Road

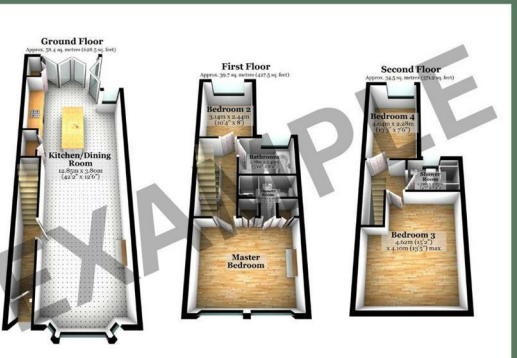

Ground Floor
 Kitchen/Dining Room
 14.0m x 4.0m (46'2" x 13'2")

First Floor
 Bedroom 2
 3.2m x 3.0m (10'6" x 9'8")

Second Floor
 Bedroom 4
 4.0m x 3.0m (13'2" x 9'8")

40 Frith Road, London, E11 4EY

Price Guide £850,000

Council Tax Band:

Coming Soon – Stunning 4-Bedroom Home on Frith Road, Leytonstone E10

Prepare to be captivated by this beautifully refurbished 4-bedroom, 2-bathroom family home on the sought-after Frith Road in Leytonstone. Offering a perfect blend of modern living and timeless charm, this property is a rare find in a prime East London location.

Step inside to discover a spacious and light-filled interior, including a generously extended kitchen designed for both cooking and entertaining. The heart of the home boasts high-quality finishes, modern appliances, and ample storage, making it a dream for any family. The expansive lounge area offers a warm and inviting space to relax or gather with loved ones.

Ground Floor

Approx. 58.4 sq. metres (628.5 sq. feet)



First Floor

Approx. 39.7 sq. metres (427.5 sq. feet)

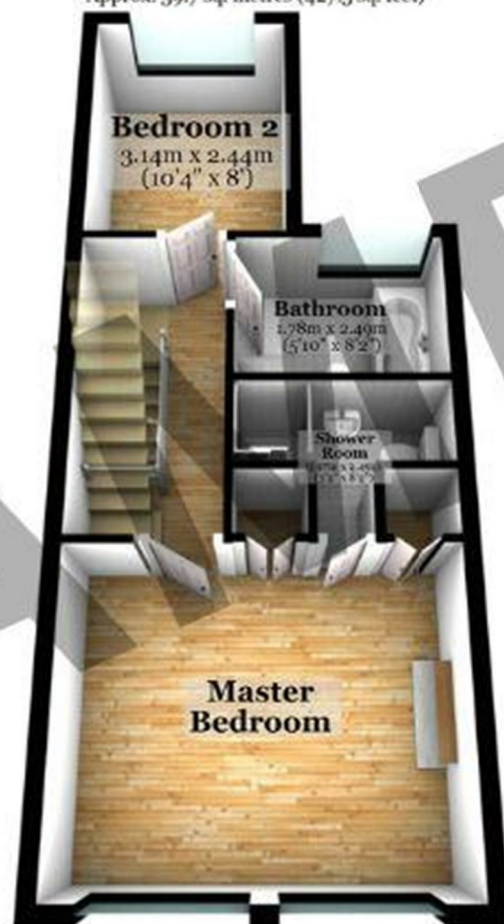

Second Floor

Approx. 34.5 sq. metres (371.2 sq. feet)



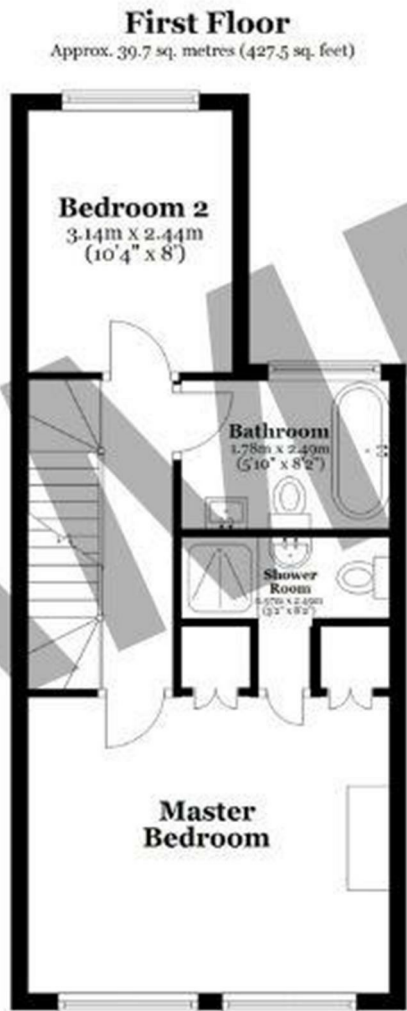

INTERESTED?

If you would like to know more about this property or other similar houses, please feel free to contact us.

Frith Road

Call us!



337 Forest Road

London

E17 5JR

02085277007

enquiries@completion.co.uk

completion.co.uk



Energy Efficiency Rating		
	Current	Potential
Very energy efficient - lower running costs		
(92 plus) A		
(81-91) B		
(69-80) C		
(55-68) D		
(39-54) E		
(21-38) F		
(1-20) G		
Not energy efficient - higher running costs		
	58	
England & Wales		EU Directive 2002/91/EC