

Flat 1, 200 Ruckholt Road, London, Greater London, E10 5FA
Guide Price £400,000
Council Tax Band:

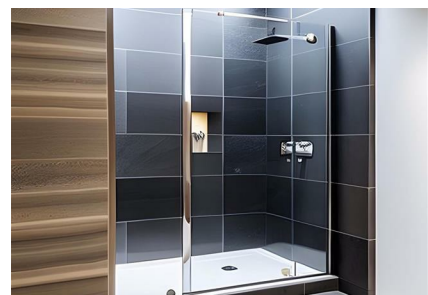

NEW BUILD | LONG LEASE | 1 - 3 BEDROOMS | COMMUNAL GARDEN | CYCLE STORAGE | PRIVATE BALCONIES | CLOSE TO LEYTON STATION | CLOSE TO STRATFORD WESTFIELD SHOPPING CENTRE | CLOSE TO OLYMPIC PARK STRATFORD | SERVICE CHARGE UPON APPLICATION | 999 YEARS LEASE

Welcome to this stylish and contemporary purpose-built apartment, situated in the upcoming and sought after part of Leyton E10. This modern residence offers a perfect combination of comfort, convenience, and sleek design.

337 Forest Road, London, E17 5JR
02085277007
enquiries@completion.co.uk
completion.co.uk

Third Floor
Approx. 62.7 sq. metres (675.0 sq. feet)

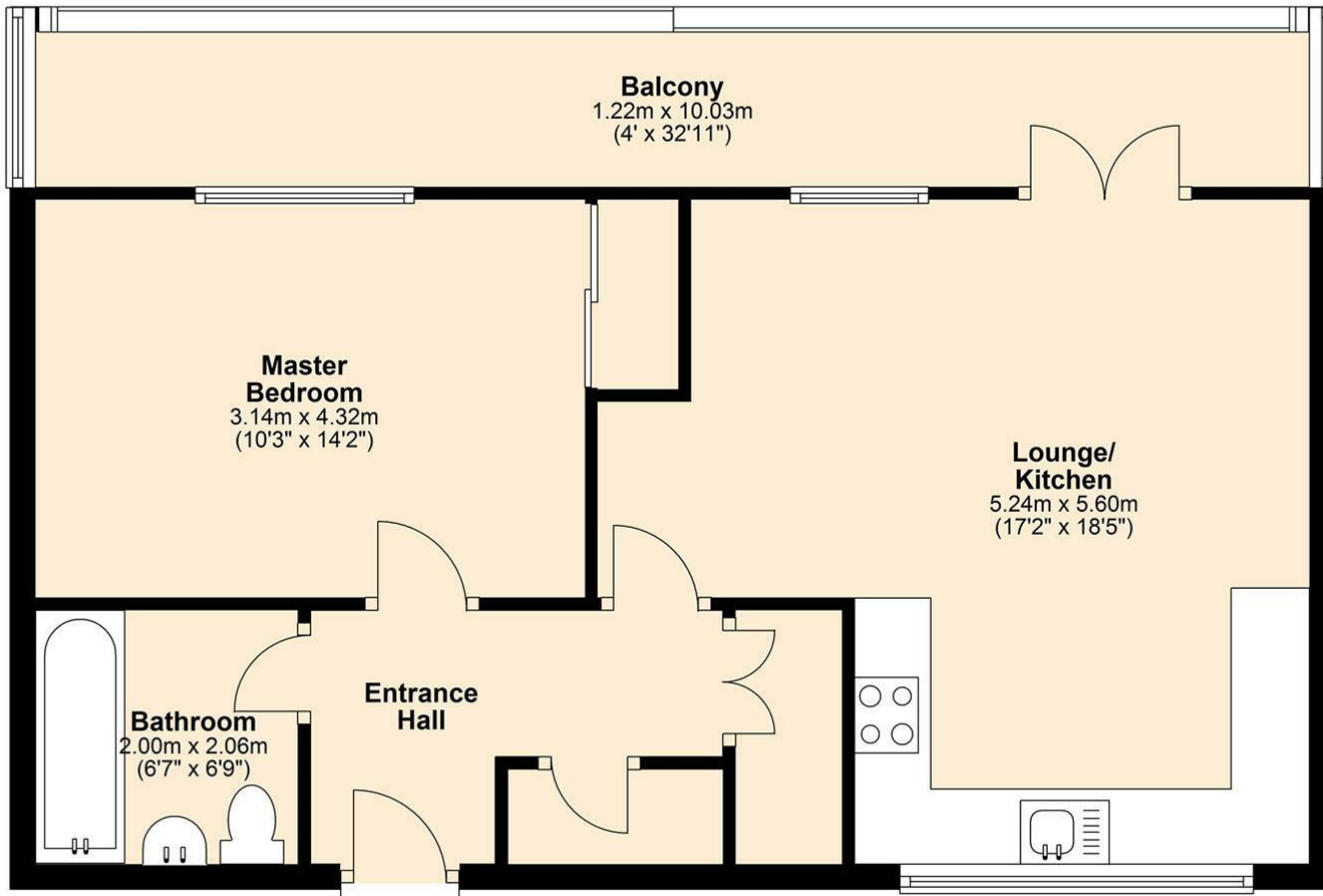

Energy Efficiency Rating		Current	Potential
Very energy efficient - lower running costs			
(92 plus) A			
(81-91) B			
(69-80) C			
(55-68) D			
(39-54) E			
(21-38) F			
(1-20) G			
Not energy efficient - higher running costs			
England & Wales		EU Directive 2002/91/EC	