



Midholm Close, Hampstead Garden Suburb, NW11

£1,550 Per Week -

A charming 1 bedroom ground floor maisonette situated within this close on the North side of Hampstead Garden Suburb. Benefits include parquet flooring to most rooms, a large South facing private front garden, a private rear garden, an external storage cupboard and gas central heating. The kitchen and bathroom are both in fantastic condition. The flat comes unfurnished and is available immediately.

Deposit £1788.46
Council tax band D

- One bedroom
- Ground floor
- Beautiful garden, front and rear
- Parquet flooring
- Modern kitchen
- Council tax band D
- Unfurnished
- Available immediately

Floor Plan

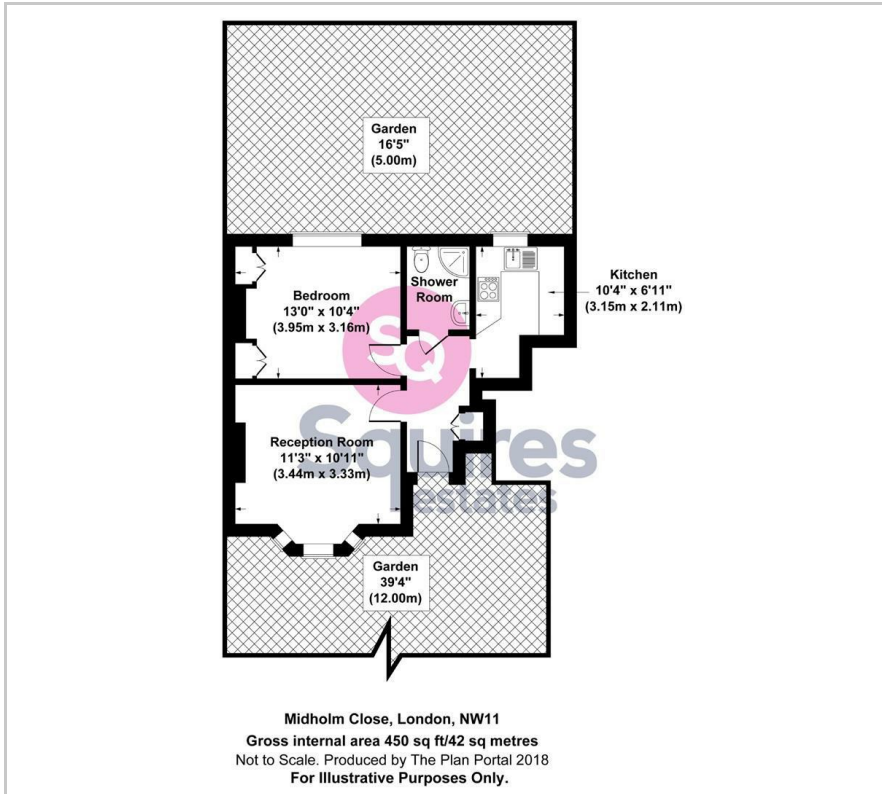

Area Map



Energy Efficiency Graph

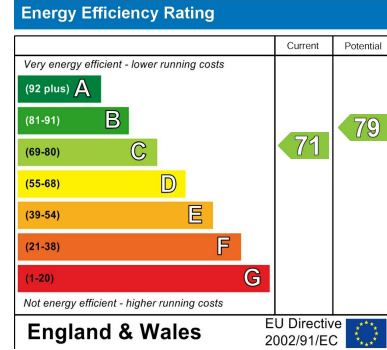

These particulars, whilst believed to be accurate are set out as a general outline only for guidance and do not constitute any part of an offer or contract. Intending purchasers should not rely on them as statements of representation of fact, but must satisfy themselves by inspection or otherwise as to their accuracy. No person in this firm's employment has the authority to make or give any representation or warranty in respect of the property.

Finchley Branch

181a Squires Lane,
 Finchley,
 London N3 2QS
 Tel 020 8343 2111

Hendon Branch

16 Central Circus Parade,
 Queens Road, Hendon,
 London NW4 3AS
 Tel 020 8202 0808

Mill Hill Branch

7 Thornfield Parade,
 Holders Hill Road, Mill Hill,
 London NW7 1LN
 Tel 020 8349 3030

