



## Manor View, London, N3 2SR

£525,000 - Leasehold

**\*\*CHAIN FREE\*\*** A charming 3 bedroom first floor flat in the heart of Finchley, London. This period conversion boasts high ceilings, creating a bright and airy atmosphere flooded with natural light.

Situated just 0.35 miles from Finchley Central Underground Station, making this location ideal for those who value convenience. Additionally, being close to amenities and within easy reach of several parks including Stephens House and Gardens add to its appeal.

The flat features a large reception, 2 spacious double bedrooms and a single bedroom that could also serve as a study, offering flexibility to suit your needs. The modern kitchen and family bathroom provide both style and functionality, perfect for daily living.

One of the standout features of this property is the private section of rear garden, allowing you to enjoy outdoor space right at your doorstep. Furthermore, it is in the catchment area for outstanding schools such as Akiva and Manorside. The property would be ideal for first time buyers and rental investors.

Lease: Approx. 89 years  
Ground Rent: £250 per annum  
Building Insurance: £598 per annum

- 3 Bedrooms
- Period Conversion
- First Floor
- Garden
- Short walk from Finchley Central Underground
- Catchment for popular schools
- Modern Kitchen
- Council tax band D



## Floor Plan

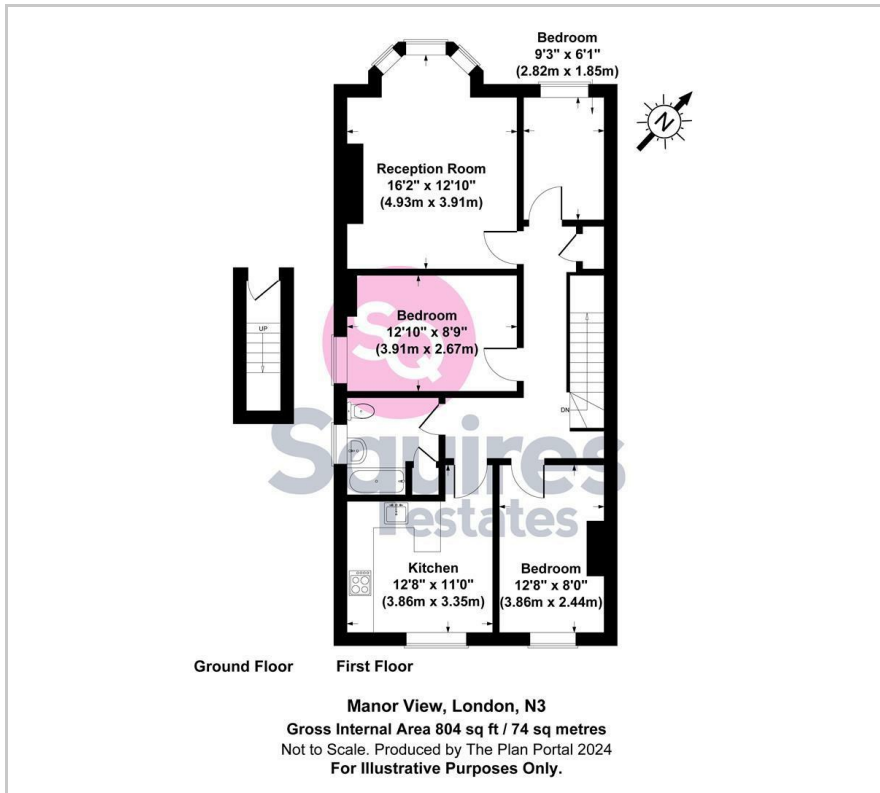

## Area Map



## Energy Efficiency Graph

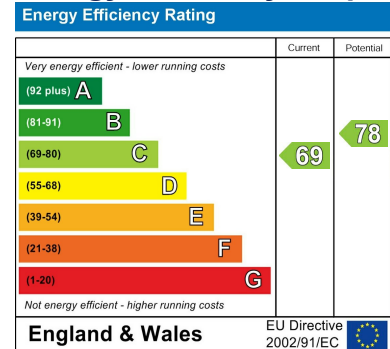

These particulars, whilst believed to be accurate are set out as a general outline only for guidance and do not constitute any part of an offer or contract. Intending purchasers should not rely on them as statements of representation of fact, but must satisfy themselves by inspection or otherwise as to their accuracy. No person in this firm's employment has the authority to make or give any representation or warranty in respect of the property.

### Finchley Branch

181a Squires Lane,  
 Finchley,  
 London N3 2QS  
 Tel 020 8343 2111

### Hendon Branch

16 Central Circus Parade,  
 Queens Road, Hendon,  
 London NW4 3AS  
 Tel 020 8202 0808

### Mill Hill Branch

7 Thornfield Parade,  
 Holders Hill Road, Mill Hill,  
 London NW7 1LN  
 Tel 020 8349 3030

