



Lodge Lane, London, N12 8JG

£2,000 Per Week -

Fantastic 2 double bedroom flat located on second floor of this modern purpose built block. En suite to master bedroom. Large reception room with open plan kitchen. Excellent condition throughout. Located next to North Finchley High Road. Offered part furnished and available immediately.

Council tax band E
Deposit £2307.69

- Two double bedrooms
- Two bathrooms
- 2nd floor
- Modern block
- Large reception area
- Council tax band E
- Available immediately
- Part furnished

Floor Plan

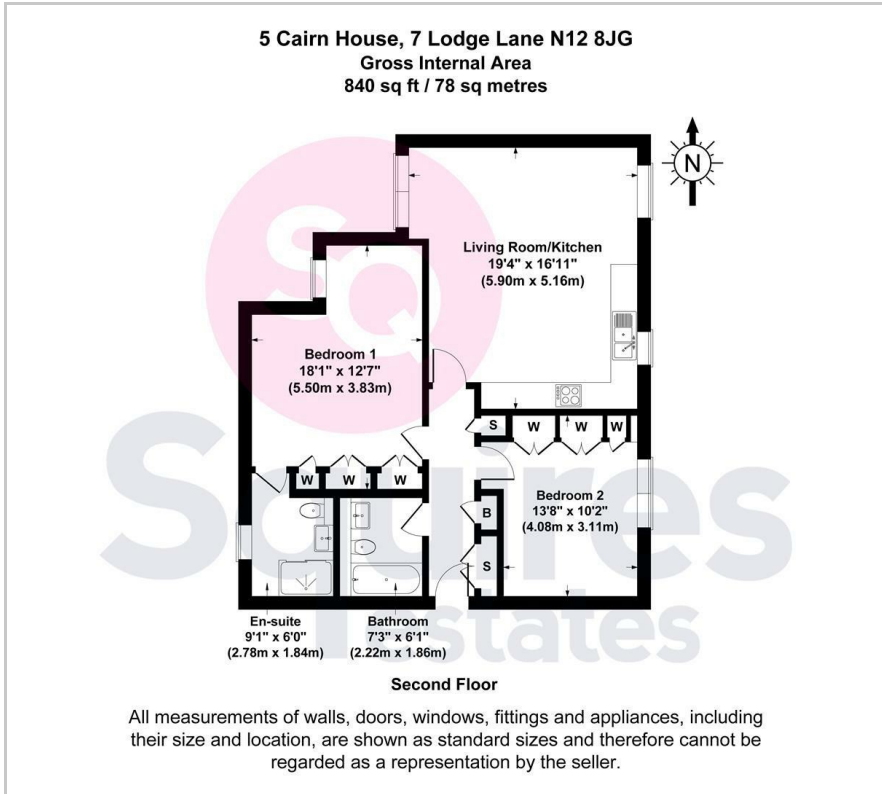

Area Map



Energy Efficiency Graph

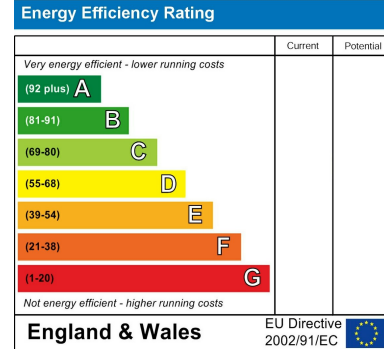

These particulars, whilst believed to be accurate are set out as a general outline only for guidance and do not constitute any part of an offer or contract. Intending purchasers should not rely on them as statements of representation of fact, but must satisfy themselves by inspection or otherwise as to their accuracy. No person in this firm's employment has the authority to make or give any representation or warranty in respect of the property.

Finchley Branch

181a Squires Lane,
 Finchley,
 London N3 2QS
 Tel 020 8343 2111

Hendon Branch

16 Central Circus Parade,
 Queens Road, Hendon,
 London NW4 3AS
 Tel 020 8202 0808

Mill Hill Branch

7 Thornfield Parade,
 Holders Hill Road, Mill Hill,
 London NW7 1LN
 Tel 020 8349 3030

