



## Nether Street, London, N3 1JD

£380,000 - Leasehold

A split-level, 603 sq ft 1 bedroom flat situated in this period conversion. The property features a 17ft reception room and benefits include an off street parking space, a section of garden and fitted wardrobes. The flat is located only 0.3 miles from West Finchley Tube station and 0.5 miles from Finchley Central Tube station and would make an ideal first time purchase.

Lease: Approx. 115 years

Ground Rent: £250 per annum

Service Charge: Approx. £900 per annum inclusive of building insurance

- Period conversion
- 1 bedroom
- Off street parking space
- Close to Tube
- Ideal first time purchase
- 603 sq ft
- Section of garden
- Barnet council tax band D

## Floor Plan

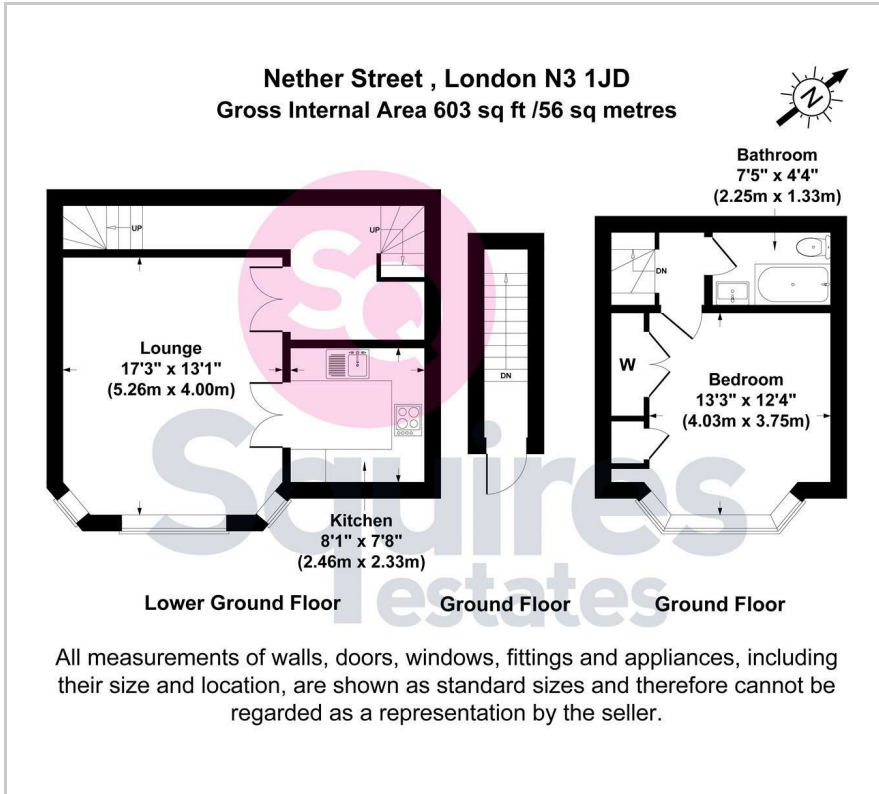

## Area Map

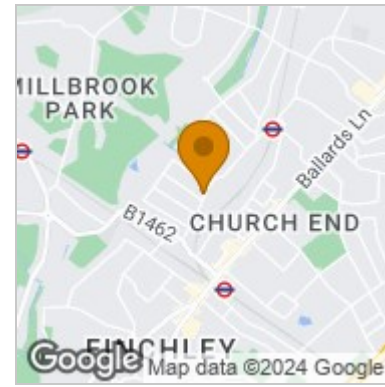

## Energy Efficiency Graph

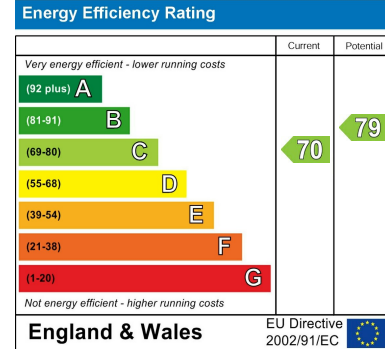

These particulars, whilst believed to be accurate are set out as a general outline only for guidance and do not constitute any part of an offer or contract. Intending purchasers should not rely on them as statements of representation of fact, but must satisfy themselves by inspection or otherwise as to their accuracy. No person in this firm's employment has the authority to make or give any representation or warranty in respect of the property.

**Finchley Branch**  
181a Squires Lane,  
Finchley,  
London N3 2QS  
Tel 020 8343 2111

**Hendon Branch**  
16 Central Circus Parade,  
Queens Road, Hendon,  
London NW4 3AS  
Tel 020 8202 0808

**Mill Hill Branch**  
7 Thornfield Parade,  
Holders Hill Road, Mill Hill,  
London NW7 1LN  
Tel 020 8349 3030

