

£475,000
15 Hulbert Road
Bedhampton, PO9 3TA

PROPERTY SUMMARY

This substantial detached family home is situated in the ever popular location of Hulbert Road, Bedhampton, close to Barncroft Primary School. The property offers fantastic family accommodation and benefits include - three double bedrooms, a family bathroom, a downstairs shower/bath room, a spacious lounge/diner, an extended family room, kitchen, utility room and an approx. 70' west facing rear garden. A garage and a driveway are added benefits and viewing is highly advised.





ENTRANCE HALL 16' 5" x 6' 1" (5m x 1.85m)

LOUNGE AREA 15' 4" into bay x 12' 0" (4.67m x 3.66m)

DINING AREA 10' 5" x 10' 5" (3.18m x 3.18m)

FAMILY ROOM 30' 10" into bay x 8' 0" (9.4m x 2.44m)

KITCHEN 14' 1" x 10' 6" (4.29m x 3.2m)

UTILITY ROOM 7' 7" x 6' 8" (2.31m x 2.03m)

BATHROOM 7' 7" x 6' 8" (2.31m x 2.03m)

STORAGE ROOM 7' 7" x 6' 8" (2.31m x 2.03m)

LEAN TO 8' 0" x 6' 9" (2.44m x 2.06m)

BEDROOM ONE 18' 9" x 14' 1" (5.72m x 4.29m)

BEDROOM TWO 18' 9" x 10' 5" (5.72m x 3.18m)

BEDROOM THREE 12' 5" x 12' 0" (3.78m x 3.66m)

BATHROOM 6' 0" x 5' 7" (1.83m x 1.7m)

REAR GARDEN 70' 0" x 45' 0" (21.34m x 13.72m) West facing.

GARAGE 24' 4" x 10' 6" (7.42m x 3.2m)

PARKING Own driveway providing ample off road parking.

GROUND FLOOR

1ST FLOOR

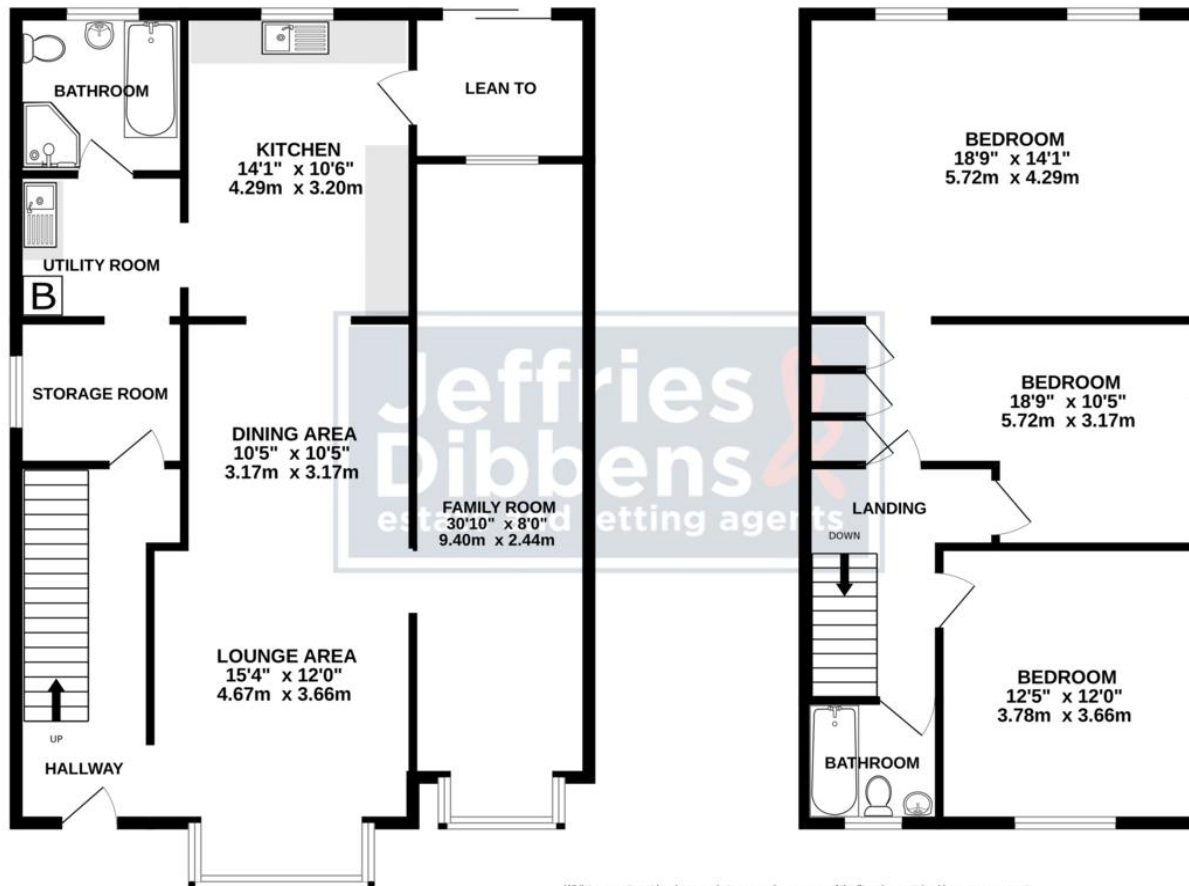

Whilst every attempt has been made to ensure the accuracy of the floorplan contained here, measurements of doors, windows, rooms and any other items are approximate and no responsibility is taken for any error, omission or mis-statement. This plan is for illustrative purposes only and should be used as such by any prospective purchaser. The services, systems and appliances shown have not been tested and no guarantee as to their operability or efficiency can be given.
Made with Metropix ©2025

LOCAL AUTHORITY
Havant Borough Council

TENURE
Freehold

COUNCIL TAX BAND
Band E

VIEWINGS
By prior appointment only

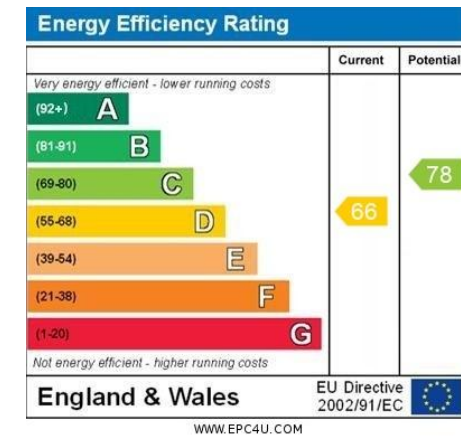

**Jeffries
Dibbensen**
estate and letting agents

OFFICE ADDRESS
13 North Street, Havant,
Hampshire, PO9 1PW

CONTACT
023 9247 4737
havant@jeffries.co.uk
www.jdea.co.uk

Agents Note: Whilst every care has been taken to prepare these particulars, they are for guidance purposes only. All measurements are approximate and are for general guidance purposes only and whilst every care has been taken to ensure their accuracy, they should not be relied upon and potential buyers/tenants are advised to recheck the measurements.