



£239,950
160 Blendworth Crescent
Leigh Park, PO9 2BH

PROPERTY SUMMARY

This lovely three bedroom home is located in Blendworth Crescent, Leigh Park and is well located with easy access to local amenities and schools making it an ideal family home. The accommodation consists of an entrance hall with stairs to first floor, kitchen, lounge and rear lobby, whilst upstairs there are three bedrooms, a bathroom and a cloakroom. Outside there are neat lawn gardens to the front and rear. The property is beautifully presented throughout although would benefit from a degree of updating. An internal viewing is highly recommended.

- 3 
- 1 
- 2 





HALL

KITCHEN 12' 8" x 7' 9" (3.86m x 2.36m)

LOUNGE 14' 6" x 12' 2" (4.42m x 3.71m)

LANDING

BATHROOM

WC

BEDROOM ONE 13' 2" x 10' 5" (4.01m x 3.18m)

BEDROOM TWO 11' 5" x 7' (3.48m x 2.13m)

BEDROOM THREE 9' 6" x 7' 6" (2.9m x 2.29m)



GROUND FLOOR
359 sq.ft. (33.4 sq.m.) approx.

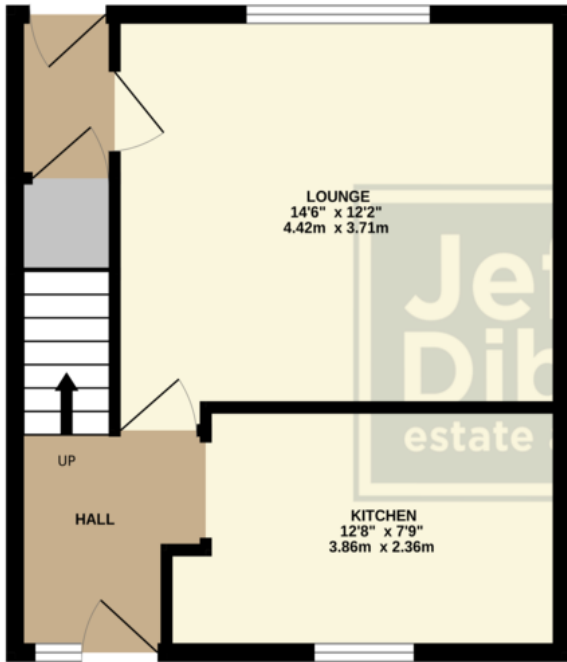

1ST FLOOR
379 sq.ft. (35.2 sq.m.) approx.

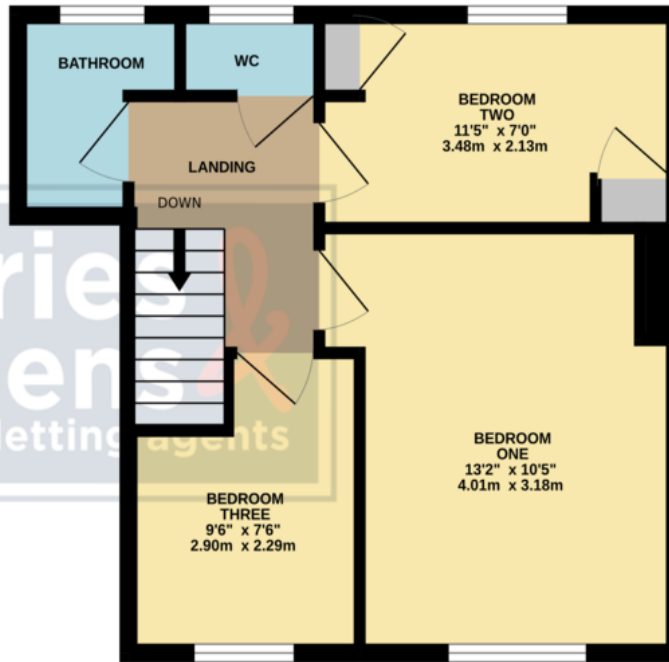

TOTAL FLOOR AREA : 739 sq.ft. (68.6 sq.m.) approx.

Whilst every attempt has been made to ensure the accuracy of the floorplan contained here, measurements of doors, windows, rooms and any other items are approximate and no responsibility is taken for any error, omission or mis-statement. This plan is for illustrative purposes only and should be used as such by any prospective purchaser. The services, systems and appliances shown have not been tested and no guarantee as to their operability or efficiency can be given.
Made with Metropix ©2024

LOCAL AUTHORITY
Havant Borough Council

TENURE
Freehold

COUNCIL TAX BAND
Band B

VIEWINGS
By prior appointment only

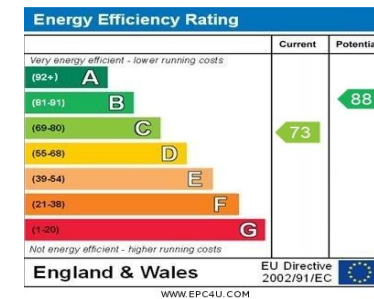

Agents Note: Whilst every care has been taken to prepare these particulars, they are for guidance purposes only. All measurements are approximate and are for general guidance purposes only and whilst every care has been taken to ensure their accuracy, they should not be relied upon and potential buyers/tenants are advised to recheck the measurements



OFFICE ADDRESS
13 North Street, Havant,
Hampshire, PO9 1PW

CONTACT
023 9247 4737
havant@jeffries.co.uk
www.jdea.co.uk