



**£360,000**  
**8 Ingledene Close**  
Bedhampton, PO9 1DG

## PROPERTY SUMMARY

We are delighted to bring to the market this stunning two bedroom bungalow tucked away in this quiet cul-de-sac less than a mile from Havant Town Centre. This property has been greatly enhanced by the current owners and features a breath taking open plan kitchen/dining/living space that opens onto the landscaped rear garden. Also comprising a spacious master bedroom with ensuite and walk in wardrobe, a second bedroom and a contemporary shower room. Ample off road parking is available to the front. An internal viewing is essential to appreciate the size and quality of accommodation on offer here, contact us at your soonest opportunity to arrange your appointment.

2 

2 

1 





**HALLWAY**

**BEDROOM ONE 14' 2" x 10' (4.32m x 3.05m)**

**BEDROOM TWO 10' 2" x 7' 11" (3.1m x 2.41m)**

**ENSUITE**

**WALK IN WARDROBE**

**SHOWER ROOM**

**OPEN PLAN KITCHEN/DINING/LIVING SPACE**

**23' 1" x 20' 2" (7.04m x 6.15m)**



GROUND FLOOR  
809 sq.ft. (75.2 sq.m.) approx.

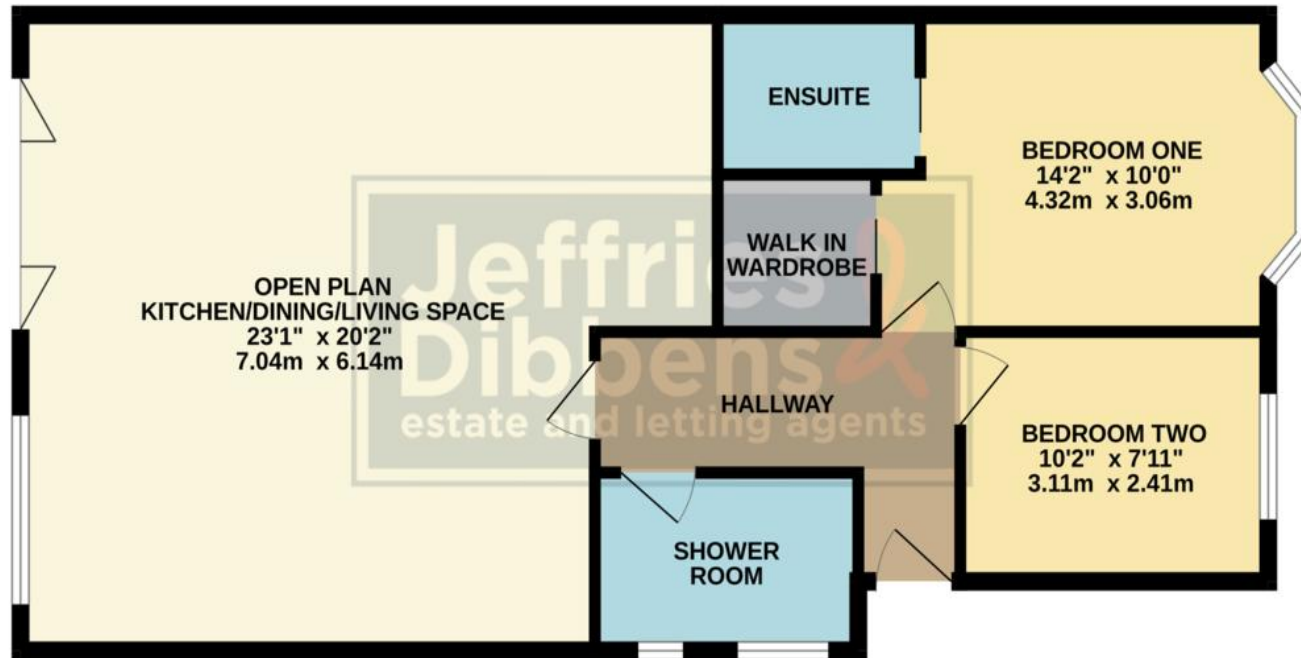

TOTAL FLOOR AREA : 809 sq.ft. (75.2 sq.m.) approx.

Whilst every attempt has been made to ensure the accuracy of the floorplan contained here, measurements of doors, windows, rooms and any other items are approximate and no responsibility is taken for any error, omission or mis-statement. This plan is for illustrative purposes only and should be used as such by any prospective purchaser. The services, systems and appliances shown have not been tested and no guarantee as to their operability or efficiency can be given.  
Made with Metropix ©2024

**LOCAL AUTHORITY**  
Havant Borough Council

**TENURE**  
Freehold

**COUNCIL TAX BAND**  
Band C

**VIEWINGS**  
By prior appointment only

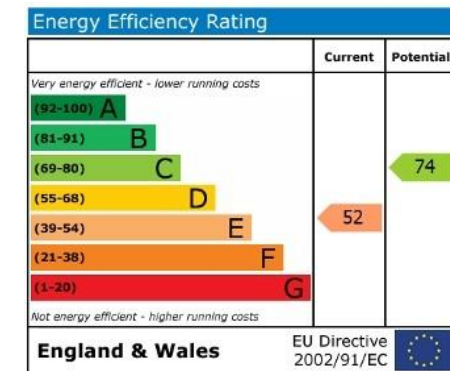

Agents Note: Whilst every care has been taken to prepare these particulars, they are for guidance purposes only. All measurements are approximate and are for general guidance purposes only and whilst every care has been taken to ensure their accuracy, they should not be relied upon and potential buyers/tenants are advised to recheck the measurements

**Jeffries  
Dibbens &**  
estate and letting agents

**OFFICE ADDRESS**  
13 North Street, Havant,  
Hampshire, PO9 1PW

**CONTACT**  
023 9247 4737  
havant@jeffries.co.uk  
www.jdea.co.uk