



£120,000

Flat 39 Gorseway, 354 Sea Front

Hayling Island, PO11 0BA

PROPERTY SUMMARY

This ground floor apartment is situated in Gorseway Retirement Village which is located just across the road from the foreshore of Hayling's beautiful West Beach. The village of West Town is nearby and there are a couple of idyllically located pubs just a short distance away, ideal for a drink and meal overlooking the Solent and watching the sunset. The property itself has a spacious lounge/dining room, kitchenette and shower room, whilst the communal laundry room is adjacent to the apartment. No forward chain.





HALLWAY

BEDROOM 10' 7" x 10' (3.23m x 3.05m)

SHOWER ROOM

LOUNGE/DINER 24' 3" x 10' (7.39m x 3.05m)

KITCHEN 7' 7" x 5' (2.31m x 1.52m)

AGENTS NOTE

We understand the Service Charges are approx. £1680 and Ground Rent is £210

There are approximately 65 years remaining on the lease.



GROUND FLOOR

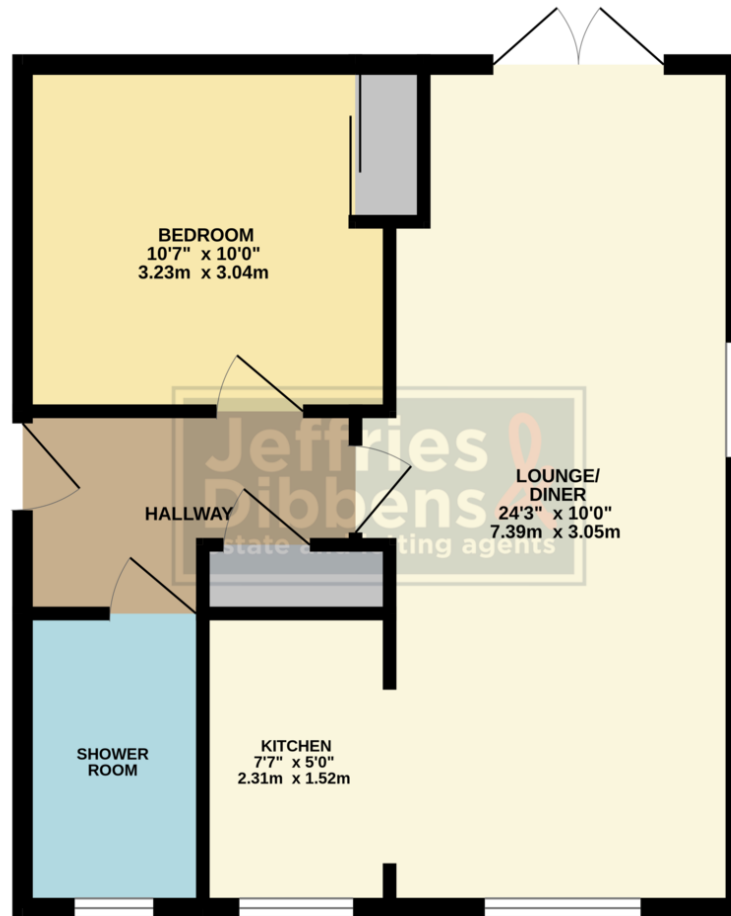

Whilst every attempt has been made to ensure the accuracy of the floorplan contained here, measurements of doors, windows, rooms and any other items are approximate and no responsibility is taken for any error, omission or mis-statement. This plan is for illustrative purposes only and should be used as such by any prospective purchaser. The services, systems and appliances shown have not been tested and no guarantee as to their operability or efficiency can be given.
Made with Metropix ©2023

LOCAL AUTHORITY
Havant Borough Council

TENURE
Leasehold

COUNCIL TAX BAND
Band B

VIEWINGS
By prior appointment only

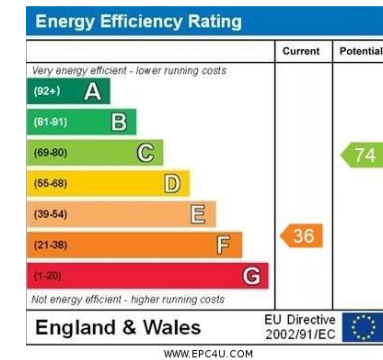

Agents Note: Whilst every care has been taken to prepare these particulars, they are for guidance purposes only. All measurements are approximate and are for general guidance purposes only and whilst every care has been taken to ensure their accuracy, they should not be relied upon and potential buyers/tenants are advised to recheck the measurements



OFFICE ADDRESS
13 North Street, Havant,
Hampshire, PO9 1PW

CONTACT
023 9247 4737
havant@jeffries.co.uk
www.jdea.co.uk