



15, Seaforth Grove,
Southend-On-Sea, Essex SS2 4EW

Monthly Rental Of £1,350

****Newly Refurbished**** This three bedroom house is abundant in benefits from the newly fitted kitchen, new carpets and fresh coat of paint throughout. On the ground floor you have the entrance hall leading you to the newly fitted kitchen diner with access to the rear garden. On the first floor you have the spacious lounge and third bedroom. On the second floor you will find the master bedroom with en-suite on your right, the three piece suite family bathroom and second bedroom to your left. Double glazing and gas central heating throughout, available now to working tenants only, no pets.



Ground floor WC
6' 3" x 2' 4" (1.90m x 0.71m)

Kitchen
14' 9" x 9' 0" (4.49m x 2.74m)

Lounge
15' 4" x 14' 9" (4.67m x 4.49m)

Bedroom 3
9' 10" x 8' 6" (2.99m x 2.59m)

Bedroom 1
14' 9" x 9' 10" (4.49m x 2.99m)

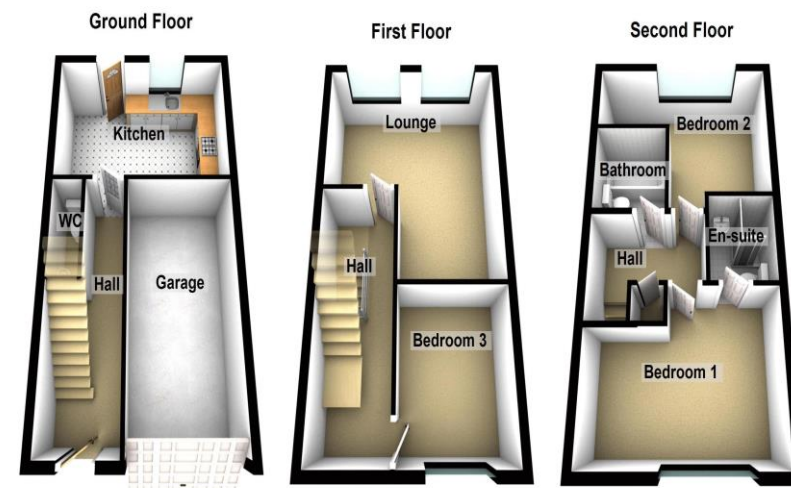

Floor Plan measurements are approximate and are for illustrative purposes only. While we do not doubt the floor plans accuracy, we make no guarantee, warranty or representation as to the accuracy and completeness of the floor plan. You or your advisors should conduct a careful, independent investigation of the property to determine to your satisfaction as to the suitability of the property for your space requirements.
Plan produced using PlanUp.

Crowstone Estates Ltd Office
Tel: 01702 333555

516 London Road Westcliff-On-Sea Essex SS0 9LD
admin@crowstoneestates.com
www.crowstoneestates.com