



Cony Walk

Grange Park, Northampton

oriordanbond
SALES & LETTINGS



Cony Walk

Grange Park
NN4 5DJ

OFFERS OVER £270,000

A modern four bedroom town house, in this sought after location, with parking to the front and garage to the side. Offered for sale with no onward chain, the property provides good access to Woodland View Primary School, Foxfield Country Park and Junction 15 for the M1 and A45.

Accommodation comprises entrance hall, cloakroom/WC and two storage cupboards, fitted kitchen, sitting/dining room with French doors to rear garden, first floor landing, two double bedrooms and family bathroom, second floor landing, two further bedrooms and a shower room. Outside is an enclosed rear garden, a driveway to the front providing off road parking and a single garage. Further benefits include uPVC double glazing and gas radiator heating. (B/1073/S)

Additional information

- Council Tax Band: D
- Energy Efficiency Rating: C

Viewing

Viewing strictly by appointment – details below

Disclaimer

O’Riordan Bond Estate Agents Limited has not tested apparatus, equipment, fittings or services and so cannot verify they are in working order. The buyer is advised to obtain verification from their solicitor or surveyor.

O’Riordan Bond Grange Park Sales
01604 432007

grangepark@oriordanbond.co.uk



GROUND FLOOR

1ST FLOOR

2ND FLOOR

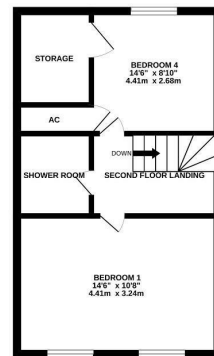
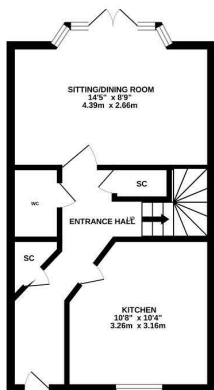

TOTAL FLOOR AREA - 1073 sq.ft. (99.7 sq.m.) approx.
Whilst every attempt has been made to ensure the accuracy of the floorplans contained here, measurements of doors, windows, rooms and any other items are approximate and no responsibility is taken for any error, omission or mis-statement. This plan is for illustrative purposes only and should be used as such by any prospective purchaser. The services, systems and appliances shown have not been tested and no guarantee as to their operability or efficiency can be given.
Made with Metropix ©2024