



Harlow's only family run independent estate agent



Rectory Lane, Harlow, CM19 4HA

**£1,500,000
Freehold**

"...Generous Accommodation Set Within Almost An Acre With Office-Studio & Entertaining Area..."

Former Rectory • Five Bedrooms • Four Bathrooms • Three Receptions • Outbuildings With Garden Kitchen • Carriage Driveway • Almost An Acre of Gardens • Buckets Of Potential • EPC Rating :- TBC • Council Tax Band :- TBC



hbproperty.co.uk 01279 418888 sales@hbproperty.co.uk

Howick & Brooker Partnership Gothic House Old Harlow CM17 0DN

Rectory Lane, Harlow, CM19 4HA

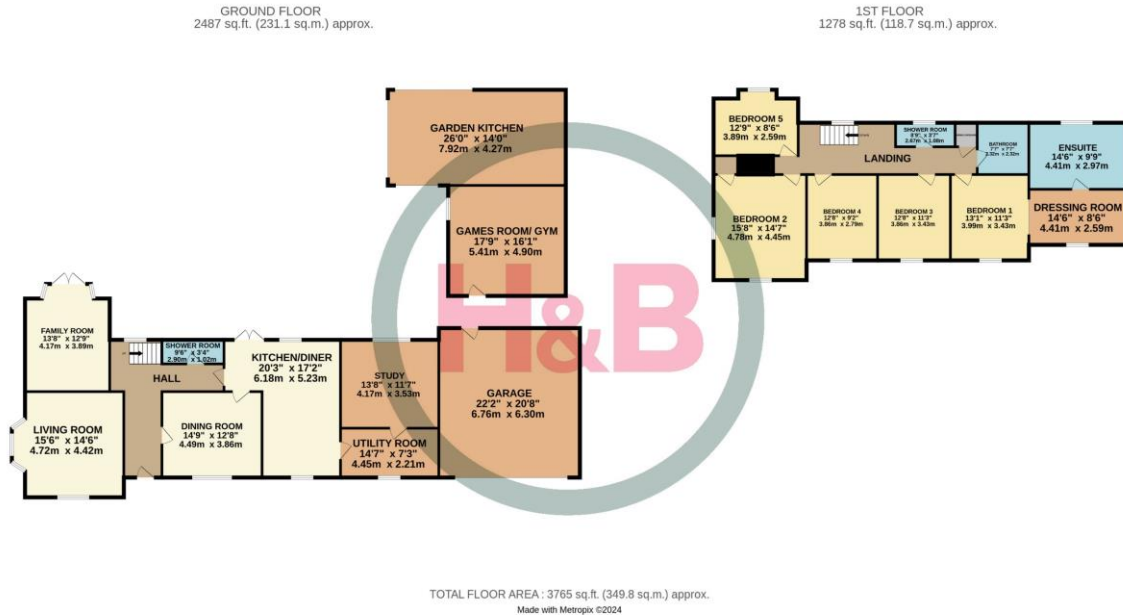

THE PROPERTY

"...Generous Accommodation Set Within Almost An Acre With Office-Studio & Entertaining Area..."

A former rectory built in the late 1930's for ecclesiastical use for the former St Marys Church in the then known Gt Parndon village. Over the last forty years or so has been in private ownership with just two families. Considerable investment in the last decade has restored and created interesting and generous five bedroom family home with private lawned grounds extending to almost an acre. This a real property for entertaining, as alongside a vast decked area the rear garden also features a games room/ gym with an enclosed garden kitchen. Gt Parndon is a pretty suburb to the southwest part of Harlow still retaining much of its original village atmosphere and The Old Rectory enjoys a little known quiet tucked away location.

Ground floor

Entrance Hall

Living Room
15' 6" x 14' 6"
(4.72m x 4.42m)

Family Room
14' 1" x 13' 8"
(4.29m x 4.16m)

Dining Room
14' 9" x 12' 8"
(4.49m x 3.86m)

Kitchen/ Diner
20' 3" x 17' 2"
(6.17m x 5.23m)

Shower Room
9' 6" x 3' 4"
(2.89m x 1.02m)

Utility Room
14' 7" x 7' 3"
(4.44m x 2.21m)

Study
13' 8" x 11' 7"
(4.16m x 3.53m)

First floor

Landing

Bedroom 1
13' 1" x 11' 3"
(3.98m x 3.43m)

Dressing Room
14' 6" x 8' 6"
(4.42m x 2.59m)

En-suite
14' 0" x 9' 8"
(4.26m x 2.94m)

Bedroom 2
15' 8" x 14' 7"
(4.77m x 4.44m)

Bedroom 3
12' 8" x 11' 3"
(3.86m x 3.43m)

Bedroom 4
12' 8" x 9' 2"
(3.86m x 2.79m)

Bedroom 5
12' 9" x 8' 6"
(3.88m x 2.59m)

Bathroom
7' 8" x 7' 7"
(2.34m x 2.31m)

Shower Room
8' 8" x 3' 6"
(2.64m x 1.07m)

Outside

Double Garage
22' 2" x 20' 8"
(6.75m x 6.29m)

Outbuildings

Games Room/ Gym
17' 9" x 16' 1"
(5.41m x 4.90m)

Garden Kitchen
26' 0" x 14' 0"
(7.92m x 4.26m)

