



Harlow's only family run independent estate agent



Milestone Road, Newhall Harlow, CM17 9NW

**£550,000
Freehold**

'...A Fantastic Home That Caters for A Multiple Number of Living Lifestyles...'

Three Bedrooms • Study Home Office/Bedroom Four • Wc & Shower Room • Townhouse • Southerly Facing Sun Terrace • EPC Rating: C • Landscaped Garden • Southerly Facing • Parking to Front & Rear • Two Bathrooms • Council Tax Band: F



hbproperty.co.uk 01279 418888 sales@hbproperty.co.uk

Howick & Brooker Partnership Gothic House Old Harlow CM17 0DN

Milestone Road Harlow, CM17 9NW

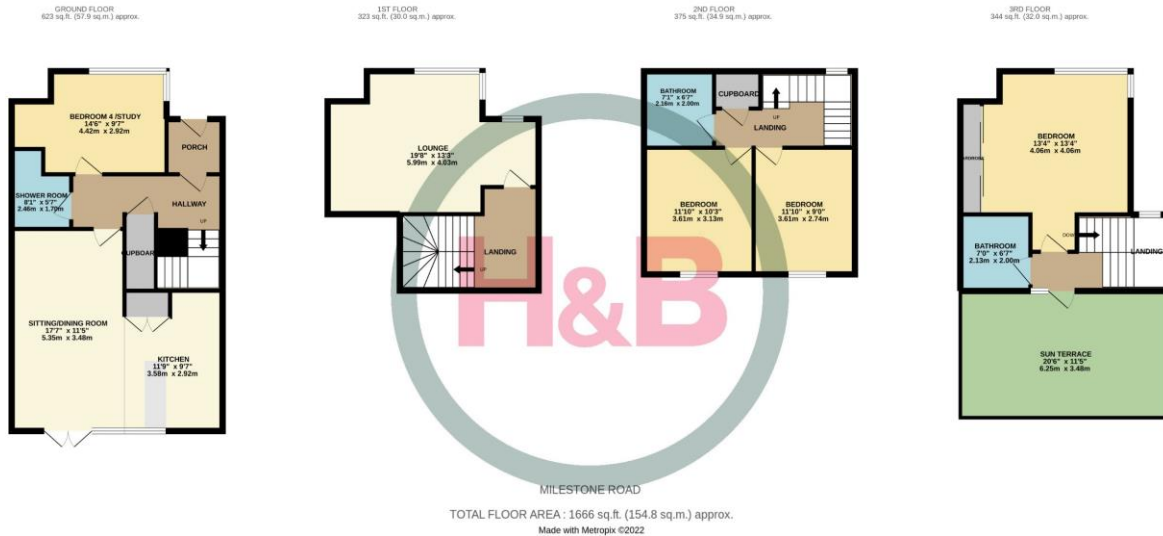

THE PROPERTY

'...A Fantastic Home That Caters for A Multiple Number of Living Lifestyles...'

This award winning three/four-bedroom townhouse is presented to a high standard throughout and offers a flexible downstairs lay out with feature open plan kitchen with breakfast bar, dining Tv snug area with French doors that lead out to a southerly facing low maintenance garden ideal for entertaining. There is a downstairs bedroom that can double as a study or home office and is complimented with a separate Wc with shower. On the first floor is the formal lounge which enjoy high ceilings and floor to ceiling windows. The second floor offers two double bedrooms and a separate family bathroom with stairs that take you to the principal bedroom suite. This bedroom offers vaulted ceilings and full length fitted wardrobes which in turn enjoys its own bathroom and landing with access out to a southerly facing sun deck ideal for those warm sunny afternoon evenings. The property enjoys allocated parking and is well located for Primary, Secondary and Private schooling with new Harlow M11 junction 7a, Harlow Town & Mill train stations a short distance away.

Ground floor

Entrance Porch

Hallway

Wc & Shower Room
8' 2" x 5' 7"
(2.49m x 1.70m)

Bedroom Four / Study
9' 7" x 14' 6"
(2.92m x 4.42m)

Kitchen
Breakfast Bar
11' 9" x 9' 7"
(3.58m x 2.92m)

Sitting / Dining Room
17' 7" x 11' 5"
(5.36m x 3.48m)

First floor

Landing

Lounge
13' 3" x 19' 8"
(4.04m x 5.99m)

Second floor

Landing

Bedroom Two
11' 10" x 10' 3"
(3.60m x 3.12m)

Bedroom Three
11' 10" x 9' 0"
(3.60m x 2.74m)

Bathroom
7' 1" x 6' 7"
(2.16m x 2.00)

Third floor

Bedroom One
13' 4" x 13' 4"
(4.06m x 4.06m)

Bathroom
7' 1" x 6' 7"
(2.16m x 2.00)

Sun Terrace
20' 6" x 11' 5"
(6.24m x 3.48m)

Outside

Parking

Southerly Facing
Landscaped
Gardens

