

Hamilton Avenue

Uttoxeter, ST14 7FE



50% ownership.

Improved modern mid terrace home still providing scope for personalisation, offering an ideal first step onto the property ladder.

£80,000

John German 

For sale with no upward chain involved, viewing is highly recommended to appreciate the works done by the current owner, including a refitted kitchen and impressive shower room, plus the scope to put your own touches into it to make it your own. Situated within close proximity of local amenities including a convenience shop and first school, the town centre and its wide range of amenities is also easily reached.

A composite door opens to the entrance hall where stairs rise to the first floor and access leads to the ground floor accommodation. The well proportioned lounge has a front facing window and laminated wooden floor, plus doors to the refitted dining kitchen and to the downstairs WC. The refitted dining kitchen extends to the width of the property and has a range of base and eye level units with work surfaces and inset sink unit set below the window overlooking the garden, space for a gas cooker with extractor hood over, space for further appliances and a double glazed door giving direct access to the garden.

To the first floor, the landing has access to the loft and doors leading to the two good sized bedrooms. The front facing master extends to the width of the home with a range of fitted furniture including wardrobes, dressing table and a double bed recess unit with cupboards and shelving plus a fitted headboard. Completing the accommodation is the full tiled shower room having a modern three piece white suite incorporating a corner double shower cubicle with a mixer shower over.

Outside to the rear, there is an enclosed low maintenance block paved garden with space for a shed and gated access to the rear. To the front is a small gravelled forecourt. To the side of the terrace is designated parking for two cars plus the use of additional shared visitor spaces.

What3words: anchorman.identity.polo

Agents note: There are covenants appertaining to this property, a copy of the Land Registry Title is available to view upon request.

Tenure: Leasehold (purchasers are advised to satisfy themselves as to the tenure via their legal representative). 99 year Lease from 1st April. We are advised by the vendor that the service charge is approx. £29.09 per month and rent of approx. £239.24 per month payable to Trent & Dove Housing.

Property construction: Brick

Parking: Drive

Electricity supply: Mains

Water supply: Mains

Sewerage: Mains

Heating: Gas central heating

(Purchasers are advised to satisfy themselves as to their suitability).

Broadband type: See Ofcom link for speed: <https://checker.ofcom.org.uk/>

Mobile signal/coverage: See Ofcom link <https://checker.ofcom.org.uk/>

Local Authority/Tax Band: East Staffordshire Borough Council / Tax Band A

Useful Websites: www.gov.uk/government/organisations/environment-agency

www.eaststaffsbc.gov.uk

Our Ref: JGA/30012024

The property information provided by John German Estate Agents Ltd is based on enquiries made of the vendor and from information available in the public domain. If there is any point on which you require further clarification, please contact the office and we will be pleased to check the information for you, particularly if contemplating travelling some distance to view the property. Please note if your enquiry is of a legal or structural nature, we advise you to seek advice from a qualified professional in their relevant field.

GROUND FLOOR

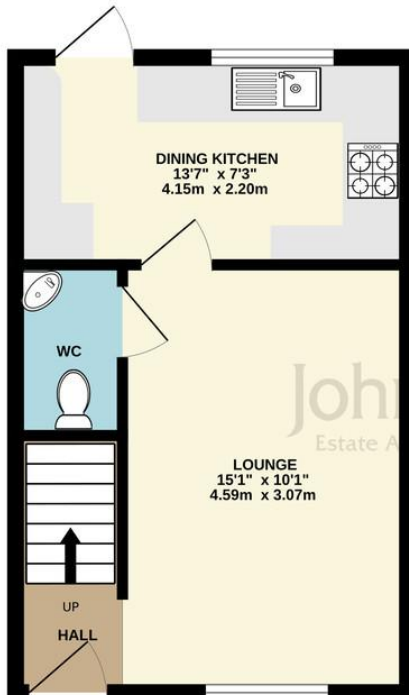

1ST FLOOR

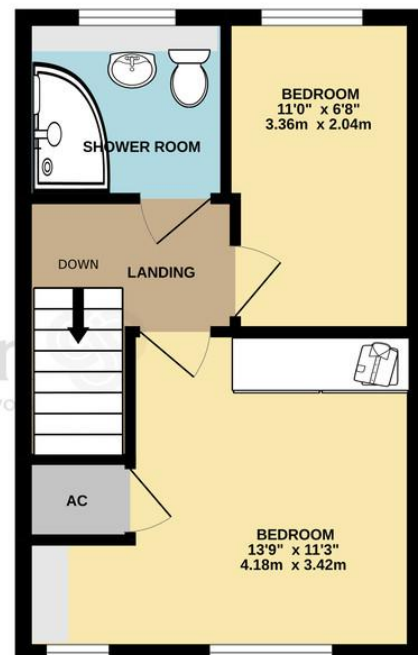





Score	Energy rating	Current	Potential
92+	A		92 A
81-91	B		
69-80	C	76 C	
55-68	D		
39-54	E		
21-38	F		
1-20	G		



John German
 9a Market Place, Uttoxeter, Staffordshire, ST14 8HY
 01889 567444
 uttoxeter@johngerman.co.uk

Agents' Notes
 These particulars do not constitute an offer or a contract neither do they form part of an offer or contract. The vendor does not make or give and Messrs. John German nor any person employed has any authority to make or give any representation or warranty, written or oral, in relation to this property. Whilst we endeavour to make our sales details accurate and reliable, if there is any point which is of particular importance to you, please contact the office and we will be pleased to check the information for you, particularly if contemplating travelling some distance to view the property. None of the services or appliances to the property have been tested and any prospective purchasers should satisfy themselves as to their adequacy prior to committing themselves to purchase.

Referral Fees
Mortgage Services - We routinely refer all clients to APR Money Limited. It is your decision whether you choose to deal with APR Money Limited. In making that decision, you should know that we receive on average £60 per referral from APR Money Limited.
Conveyancing Services - If we refer clients to recommended conveyancers, it is your decision whether you choose to deal with this conveyancer. In making that decision, you should know that we receive on average £150 per referral.
Survey Services - If we refer clients to recommended surveyors, it is your decision whether you choose to deal with this surveyor. In making that decision, you should know that we receive up to £90 per referral.

Ashbourne | Ashby de la Zouch | Barton under Needwood
 Burton upon Trent | Derby | East Leake | Lichfield
 Loughborough | Stafford | Uttoxeter

JohnGerman.co.uk Sales and Lettings Agent