

Fairway

Branston, Burton-on-Trent, DE14 3EH



Offered with NO ONWARD CHAIN, this well-positioned home on Fairway in Branston is ideal for first-time buyers. Just a short walk from Branston Golf Club and local amenities, it's the perfect opportunity to step onto the property ladder.

£175,000

John German

If you're a first-time buyer looking to step onto the property ladder, this could be the perfect place to start. Handily situated just a stroll away from Branston Golf Club & Spa together with schools for all ages close by and a Sainsbury's Local just around the corner, plus excellent transport links provided by the A38 and A50.

To the front of the property, you will find off road parking for at least two vehicles extending to the side of the property. A pathway then leads to the front door, which opens up into the entrance hallway.

The hallway follows onto the spacious living room with stairs leading to the first floor landing and the kitchen to the rear.

The fitted kitchen features matching wall and base units with worktops above, base level electric oven, induction hob with cooker hood above, plumbing for washing machine, stainless steel sink and drainer and an external door leading to the rear garden.

The first floor enjoys two spacious bedrooms. Both bedrooms share a family bathroom, which has a bath with mixer taps and shower above, w/c and wash hand basin.

One of the stand out features of this lovely home has to be the rear garden. A fantastic size in comparison to other similar properties in the area, which is mainly laid to lawn and enclosed to the perimeter by wooden fencing. Due to the tree line to the back of the garden, the garden isn't particularly overlooked by neighbouring properties.

Tenure: Freehold (purchasers are advised to satisfy themselves as to the tenure via their legal representative).

Please note: It is quite common for some properties to have a Ring doorbell and internal recording devices.

Property construction: Standard

Parking: Drive

Electricity supply: Mains

Water supply: Mains

Sewerage: Mains

Heating: Gas

(Purchasers are advised to satisfy themselves as to their suitability).

Broadband type: See Ofcom link for speed: <https://checker.ofcom.org.uk/>

Mobile signal/coverage: See Ofcom link <https://checker.ofcom.org.uk/>

Local Authority/Tax Band: East Staffordshire Borough Council / Tax Band B

Useful Websites: www.gov.uk/government/organisations/environment-agency

Our Ref: JGA/16062025

The property information provided by John German Estate Agents Ltd is based on enquiries made of the vendor and from information available in the public domain. If there is any point on which you require further clarification, please contact the office and we will be pleased to check the information for you, particularly if contemplating travelling some distance to view the property. Please note if your enquiry is of a legal or structural nature, we advise you to seek advice from a qualified professional in their relevant field.

We are required by law to comply fully with The Money Laundering Regulations 2017 and as such need to complete AML ID verification and proof / source of funds checks on all buyers and, where relevant, cash donors once an offer is accepted on a property. We use the Checkboard app to complete the necessary checks, this is not a credit check and therefore will have no effect on your credit history. With effect from 1st March 2025 a non-refundable compliance fee of £30.00 inc. VAT per buyer / donor will be required to be paid in advance when an offer is agreed and prior to a sales memorandum being issued.



Ground Floor

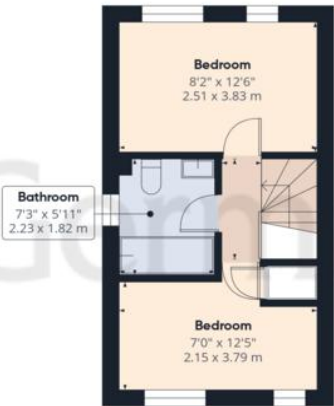

Floor 1

John German

Approximate total area[®]

553 ft²
51.4 m²

Reduced headroom

15 ft²
1.4 m²

(1) Excluding balconies and terraces

Reduced headroom
Below 5 ft/1.5 m

Calculations reference the RICS IPMS 3C standard. Measurements are approximate and not to scale. This floor plan is intended for illustration only.

GIRAFFE360





Score	Energy rating	Current	Potential
92+	A		
81-91	B		85 B
69-80	C		
55-68	D	67 D	
39-54	E		
21-38	F		
1-20	G		

 OnTheMarket

 rightmove

 RICS

 aria
propertymark
PROTECTED

 naea
propertymark
PROTECTED

 The Property
Ombudsman

 APPROVED CODE
TRADING STANDARDS UK

John German

129 New Street, Burton-On-Trent, Staffordshire, DE14 3QW

01283 512244

burton@johngerman.co.uk

Agents' Notes

These particulars do not constitute an offer or a contract neither do they form part of an offer or contract. The vendor does not make or give any Messrs. John German nor any person employed has any authority to make or give any representation or warranty, written or oral, in relation to this property. Whilst we endeavour to make our sales details accurate and reliable, if there is any point which is of particular importance to you, please contact the office and we will be pleased to check the information for you, particularly if contemplating travelling some distance to view the property. None of the services or appliances to the property have been tested and any prospective purchasers should satisfy themselves as to their adequacy prior to committing themselves to purchase.

Referral Fees

Mortgage Services - We routinely refer all clients to APR Money Limited. It is your decision whether you choose to deal with APR Money Limited. In making that decision, you should know that we receive on average £60 per referral from APR Money Limited.

Conveyancing Services - If we refer clients to recommended conveyancers, it is your decision whether you choose to deal with this conveyancer. In making that decision, you should know that we receive on average £150 per referral.

Survey Services - If we refer clients to recommended surveyors, it is your decision whether you choose to deal with this surveyor. In making that decision, you should know that we receive up to £90 per referral.

Ashbourne | Ashby de la Zouch | Barton under Needwood
Burton upon Trent | Derby | East Leake | Lichfield
Loughborough | Stafford | Uttoxeter

JohnGerman.co.uk Sales and Lettings Agent