

austin gray
first floor office 123-125 dyke road, hove, bn3 1tj
Tel: 01273 232232
residential@austingray.co.uk
www.austingray.co.uk

austin gray



25 Westfield Crescent

Brighton, BN1 8JB

£400,000

A three bedroom, semi-detached, family home in need of modernisation with a west facing rear garden with far reaching views towards the South Downs being sold with no onward chain.

Westfield Crescent lies Wilmington Way close to Carden Avenue where bus services provide access into Brighton City centre and seafront. Located off Carden Avenue are various shops including a large Asda superstore and a Marks and Spencer food hall with a new Dunelm recently having been opened. Carden Avenue also provides easy access onto the A273 and A27 nearby road links providing access in all directions.

Steps lead down to the front door to an enclosed porch and through to the entrance hall where there is useful under stairs storage. The dual aspect living and dining room has views towards the South Downs and out to the west facing rear garden. The kitchen also looks out to the rear garden and lends itself to be knocked through into the dining room. A side door opens into an enclosed porch and out to the side access to the garden. On the first floor are two double bedrooms and a single third bedroom along with a bathroom and separate WC. The rear garden takes full advantage of its westerly direction and from the patio steps lead down to a lawned and established rear garden with fabulous far reaching views.

Council tax band D

Viewing

Please contact our Austin Gray Residential Office on 01273 232232

if you wish to arrange a viewing appointment for this property or require further information.

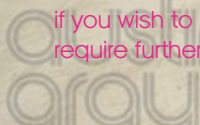

Floor Plan

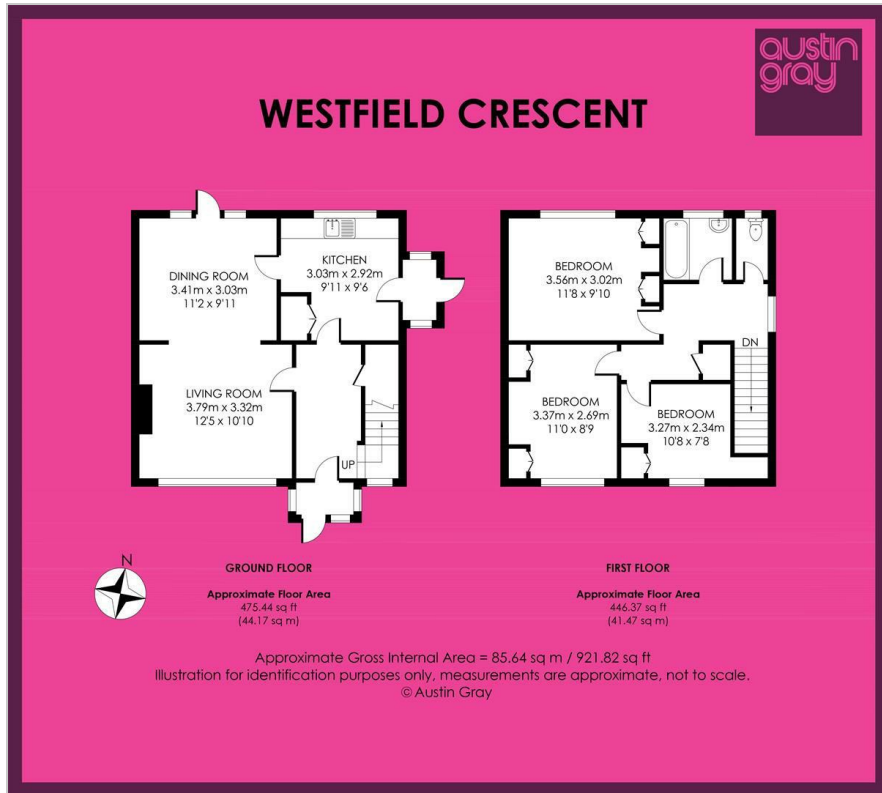

Area Map



Energy Efficiency Graph

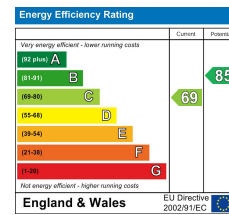

These particulars, whilst believed to be accurate are set out as a general outline only for guidance and do not constitute any part of an offer or contract. Intending purchasers should not rely on them as statements of representation of fact, but must satisfy themselves by inspection or otherwise as to their accuracy. No person in this firm's employment has the authority to make or give any representation or warranty in respect of the property.

austin gray
 first floor office 123-125 dyke road, hove, bn3 1tj
 Tel: 01273 232232
 residential@austingray.co.uk
 www.austingray.co.uk

austin gray