



Ibbett Mosely



Lunar Close, Biggin Hill, Kent, TN16 3DY

Asking Price £435,000 Freehold

**** VACANT POSSESSION AND NO ONWARD CHAIN ****

In a small residential cul-de-sac in the top part of Biggin Hill this inner terraced town house with accommodation over three floors

- 3 Bedrooms (1 Ground Floor)
- Bathroom
- Ground Floor Shower/Cloakroom
- Study Area off Bedroom 3
- Living Room
- Kitchen/Dining Room
- Gas Central Heating
- Double Glazed
- Small Garage/Store Room
- Garden

**** AVAILABLE FOR SALE FREE OF CHAIN ****

Located in the top of Biggin Hill this modern inner terraced town house offers spacious three bedroom (one ground floor with adjoining study/office and shower/cloakroom) family accommodation extending to about 1062 sq ft over three floors

LOCATION

To the north of the main shopping area but still close to all the shops and amenities. There is a Waitrose supermarket and Tesco Express. There is a library and swimming pool as well as a medical centre and schools for all ages.

Bus connections to Hayes, Orpington and Bromley for a wider choice of shops and stations to London, the bus service also goes to the Croydon Tram Link at Addington. M25 access from junction 4.

GROUND FLOOR

ENTRANCE PORCH

With outside store and double glazed door to the entrance hall.

ENTRANCE HALL

With radiator, laminate flooring and double glazed door to the rear garden. Utility cupboard with plumbing for a washing machine.

SHOWER/CLOAKROOM

With shower cubicle, W.C. and hand basin. Chrome ladder style towel rail, part tiled walls, laminate flooring, extractor fan and double glazed window.

BEDROOM

With radiator, double glazed window and arch to STUDY AREA with radiator and wardrobe cupboard. Door to Small Garage/Store Room.

FIRST FLOOR

KITCHEN/DINING ROOM

Fitted with a range of base and wall units. Built in hob, oven, extractor, dishwasher, fridge and freezer. Wall mounted gas boiler, stainless steel sink unit, part tiled walls, double glazed window and opening to the reception room.

RECEPTION ROOM

With radiator, double glazed window, fireplace with fitted gas fire and stairs to the second floor.

SECOND FLOOR

LANDING

With shelved cupboard and hatch to the loft.

BEDROOM

With radiator, double glazed windows and mirror fronted wardrobe cupboards.

BEDROOM

With radiator, double glazed window and mirror fronted wardrobe cupboards.

BATHROOM

With enclosed bath with separate shower over, W.C. and hand basin. Tiled walls and floor, extractor fan, chrome towel rail and double glazed window.

OUTSIDE

Small garage/store room with up and over door, light and power. Parking to the front.

The garden to the rear of the house includes a patio area and lawn.

COUNCIL TAX

The property is in Band "D" for council tax payments.

SERVICES

Mains gas, water, electricity and drainage are connected to the property.

DIRECTIONS

Leave Biggin Hill on the A233 towards Bromley, Lunar Close will be on the right just after the Black Horse Pub



EPC Rating- C

Lunar Close, Biggin Hill, TN16

Total Floor Area: 98.7 m² ... 1062 ft²

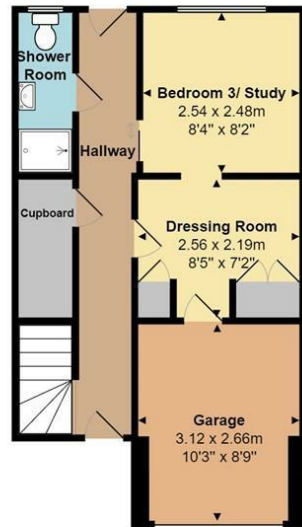

Ground Floor
Total Floor Area 33.1 m² ... 356 ft²

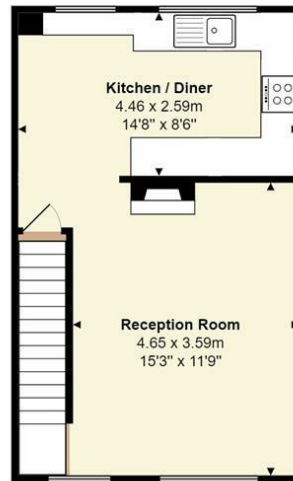

1st Floor
Total Floor Area 32.8 m² ... 353 ft²

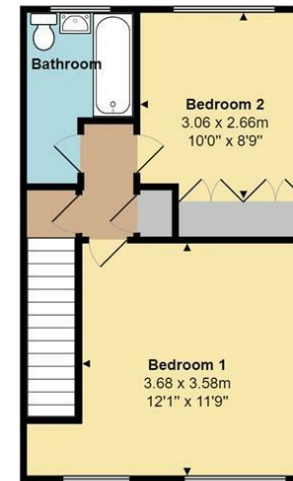

2nd Floor
Total Floor Area 32.8 m² ... 353 ft²

Measurements are approximate, not to scale and for illustrative purposes only.
www.essentialpropertymarketing.com

Ibbett Mosely

Westerham 01959 563265

Offices at - BOROUGH GREEN - OTFORD - SEVENOAKS - SOUTHWARK
TONBRIDGE - WESTMINSTER - WESTERHAM - WEST MALLING

www.ibbettmosely.co.uk

IMPORTANT - Ibbett Mosely, for themselves and for the vendors or lessors of this property whose agents they are give notice that (i) these particulars are set out as a general outline only for guidance of intending purchasers or lessees, and do not constitute, nor constitute part of an offer or contract; (ii) all descriptions, dimensions references to condition and necessary permissions for use and occupation, and other details are given without responsibility and any intending purchasers or tenants should not rely on them as statements or representations of fact but must satisfy themselves by inspection or otherwise as to the correctness of each of them; (iii) no person in the employment of Ibbett Mosely, has any authority to make or give any representation or warranty whatever in relation to this property. ver 3.0.

...a name you can trust
offices in Kent and London