



Ibbett Mosely

Marlowe Road, Larkfield, Aylesford ME20 6TE
Offers In Excess Of £330,000



Marlowe Road, Aylesford, ME20 6TE

FANTASTIC TWO BEDROOM SEMI DETACHED HOME WITH ENCLOSED REAR GARDEN, SINGLE GARAGE AND ALLOCATED PARKING SPACE. LOCATED IN QUIET CUL DE SAC, CLOSE TO LOCAL AMENITIES.

- Semi Detached Property
- Two Bedrooms
- Single Garage & Allocated Parking Space
- Sitting Room
- Family Bathroom
- Enclosed Rear Garden
- Fitted Kitchen
- Conservatory
- Cul-de-Sac Location

An ideal two bedroom home for a first time buyer or down sizer, situated in a cul de sac location and within walking distance of many local amenities. This lovely home has a fitted kitchen, bright sitting room and conservatory on the ground floor. There are two bedrooms and the family bathroom on the first floor. Outside, the enclosed rear garden has a paved patio area. The property has the added benefit of a single garage and allocated parking space.

LARKFIELD

Larkfield village is part of the civil parish of East Malling and Larkfield. Larkfield has a fantastic selection of local amenities including a doctors surgery, pharmacy and Post Office at Martin Square. As well as Morrisons, Lidl and B&Q, there is a Tesco Extra supermarket. Larkfield Leisure Centre has excellent recreational facilities and Brookfield Infant and Junior Schools and Lunsford Primary School prove popular with local residents. There is easy access to the M20's Junction 4 which links to the M26/M25 Motorway network, Dartford Tunnel, Channel Tunnel Terminus and ports, Heathrow and Gatwick International Airports, London and suburbs.

ACCOMMODATION

The property comprises a sitting room, fitted kitchen and conservatory on the ground floor. Upstairs there are two bedrooms and a modern family bathroom.

ENCLOSED REAR GARDEN

The rear garden is fully enclosed and has a paved patio area for outdoor dining.

GARAGE & PARKING

The property has the added benefit of single garage and allocated parking space.

TONBRIDGE & MALLING BOROUGH COUNCIL

Council Tax Band C

EPC RATING C

<https://find-energy-certificate.service.gov.uk/energy-certificate/2031-1122-2216-9816-1913>

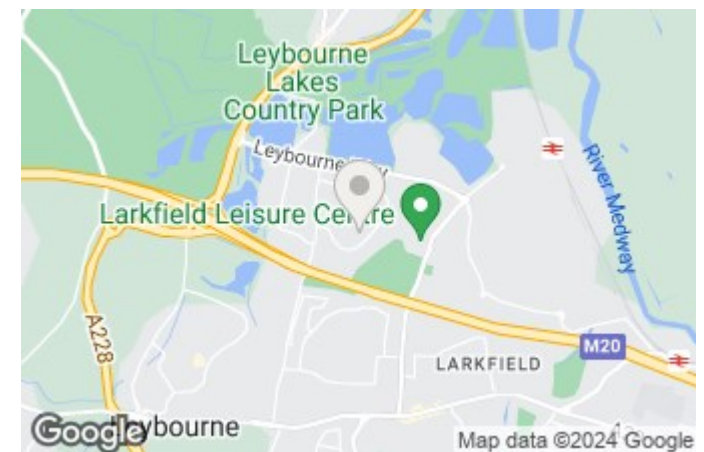



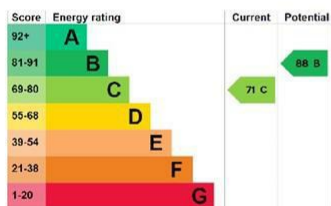
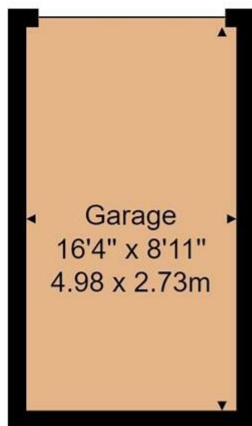

House Approx. Gross Internal Area
624 sq. ft / 57.9 sq. m

Garage Approx. Internal Area
146 sq. ft / 13.6 sq. m

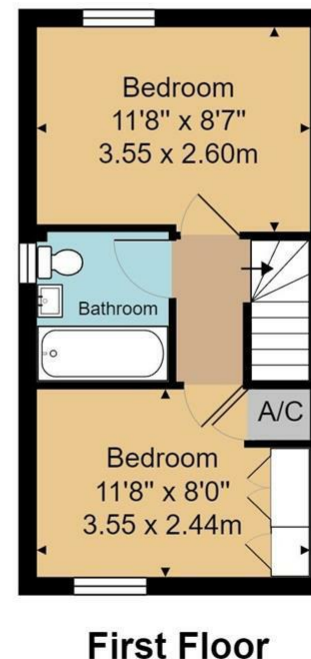

Whilst every attempt has been made to ensure the accuracy of the floor plan contained here, measurements of doors, windows, rooms and any other items are approximate and no responsibility is taken for any error, omission, or mis-statement. This plan is for illustrative purposes only and should be used as such by any prospective purchaser or tenant. The services, systems and appliances shown have not been tested and no guarantee as to their operability or efficiency can be given.

Ibbett Mosely

West Malling 01732 842668

Offices at - BOROUGH GREEN - OTFORD - SEVENOAKS - SOUTHWARK
TONBRIDGE - WESTMINSTER - WESTERHAM - WEST MALLING

www.ibbettmosely.co.uk

IMPORTANT - Ibbett Mosely, for themselves and for the vendors or lessors of this property whose agents they are give notice that (i) these particulars are set out as a general outline only for guidance of intending purchasers or lessees, and do not constitute, nor constitute part of an offer or contract; (ii) all descriptions, dimensions references to condition and necessary permissions for use and occupation, and other details are given without responsibility and any intending purchasers or tenants should not rely on them as statements or representations of fact but must satisfy themselves by inspection or otherwise as to the correctness of each of them; (iii) no person in the employment of Ibbett Mosely, has any authority to make or give any representation or warranty whatever in relation to this property ver 3.0.

...a name you can trust
offices in Kent and London