



HARVEY ROBINSON

Guide Price

£350,000

Harrier Close

Hartford, PE29 1XA

## PROPERTY SUMMARY

Harvey Robinson estate agents in Huntingdon are delighted to bring to market this three bedroom detached home in the highly sought after 'Bird Estate' in Hartford, Huntingdon. In brief, the property comprises entrance hall, cloakroom, lounge, open plan fitted kitchen/diner and conservatory completing the ground floor. Upstairs, you will find three double bedrooms with the master offering it's own ensuite shower room and the family bathroom serving the other two bedrooms. Outside benefits from a front and enclosed back garden, single integral garage with parking in front. The property benefits from no onward chain. For further information or to arrange a viewing, please contact our Huntingdon Office.





GROUND FLOOR  
646 sq.ft. (60.0 sq.m.) approx.

1ST FLOOR  
491 sq.ft. (45.6 sq.m.) approx.

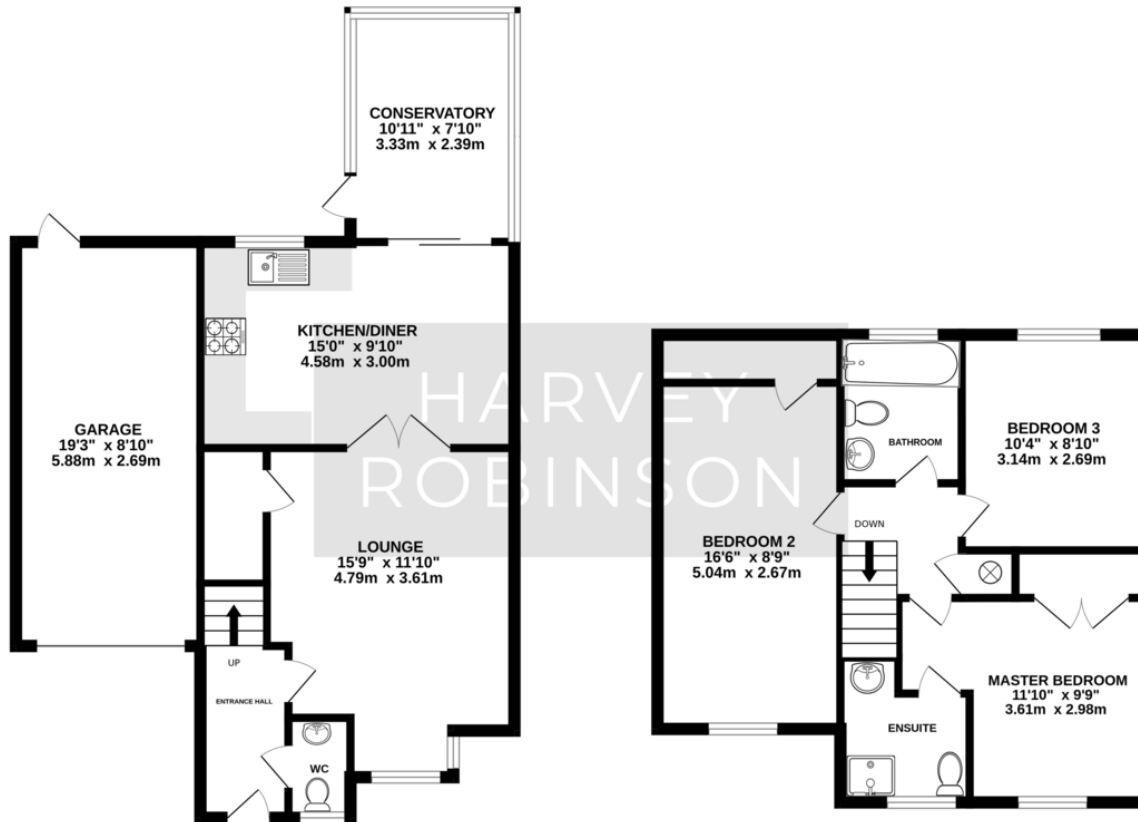

TOTAL FLOOR AREA : 1137 sq.ft. (105.6 sq.m.) approx.  
Made with Metropix ©2024

## FAQs

Tenure: Freehold  
Council Tax Band: D  
Vendors Onward Chain: No chain  
Water Meter: Yes  
Loft: Boarded with light & ladder  
What3Words Location:  
///behind.compacts.alleyway

Score	Energy rating	Current	Potential
92+	A		
81-91	B		84 B
69-80	C	72 C	
55-68	D		
39-54	E		
21-38	F		
1-20	G		

Agents Note: Whilst every care has been taken to prepare these particulars, they are for guidance purposes only. All measurements are approximate and are for general guidance purposes only and whilst every care has been taken to ensure their accuracy, they should not be relied upon and potential buyers/tenants are advised to recheck the measurements

HARVEY ROBINSON

### OFFICE ADDRESS

91 High Street, Huntingdon,  
Cambridgeshire, PE29 3DP

### CONTACT

01480 454040  
huntingdon@harveyrobinson.co.uk  
www.harveyrobinson.co.uk