



*jordanfishwick*

26-28 Whitelow Road  
Chorlton



**26-28 Whitelow Road  
Chorlton M21 9HQ**  
£1,350 Per Calendar Month



## The Property

\*\*\*\* AVAILABLE NOW \*\*\*\* A superbly presented two double bedroom ground floor apartment situated in an exclusive development in Chorlton, only a short walk to local shops & bars and the Metrolink. The accommodation briefly comprises; tidy communal areas with secure entrance, interior hallway with storage, good sized living room, separate modern kitchen, master double bedroom with en-suite shower room, second double bedroom, modern main bathroom. Externally there are maintained communal gardens, secure off-road parking and secure bicycle storage lockers with availability to store two bikes. Part furnished.

\*\*\*\*\* To arrange a viewing please call 0161 860 4444 \*\*\*\*\*

## Directions

- Council Tax Band B - EPC C
- Top Floor Apartment
- 2 Bathrooms
- 2 Bedrooms
- Secure off road parking
- Popular Development
- Available Now

Postcode - M21 9HQ

EPC Rating - B

Floor Area - sq ft

Local Authority - Manchester City Council

Council Tax - B



GROUND FLOOR

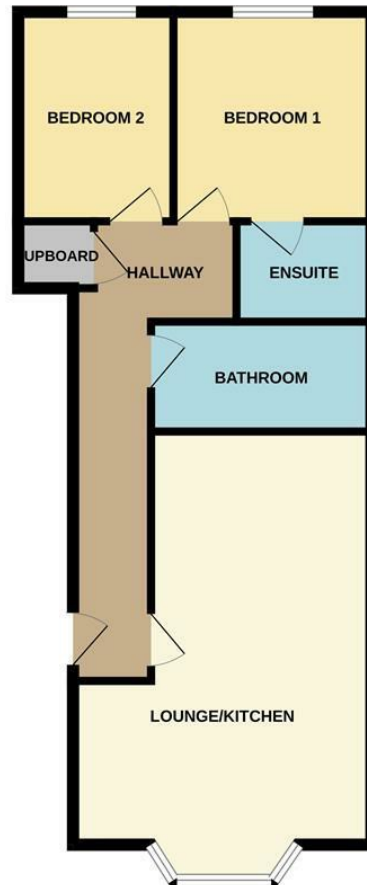

Whilst every attempt has been made to ensure the accuracy of the floorplan contained here, measurements of doors, windows, rooms and any other items are approximate and no responsibility is taken for any error, omission or mis-statement. This plan is for illustrative purposes only and should be used as such by any prospective purchaser. The services, systems and appliances shown have not been tested and no guarantee as to their operability or efficiency can be given.  
Made with Metropix ©2025



These particulars are believed to be accurate but they are not guaranteed and do not form a contract. Neither Jordan Fishwick nor the vendor or lessor accept any responsibility in respect of these particulars, which are not intended to be statements or representations of fact and any intending purchaser or lessee must satisfy himself by inspection or otherwise as to the correctness of each of the statements contained in these particulars. Any floorplans on this brochure are for illustrative purposes only and are not necessarily to scale.

Offices at: Offices at Chorlton, Didsbury, Disley, Hale, Glossop, Macclesfield, Manchester Deansgate, Manchester Whitworth Street, New Mills, Sale, Wilmslow and Withington

410-412 Barlow Moor Road, Chorlton, Manchester, M21

8AD  
**01618604444**

chorlton@jordanfishwick.co.uk  
www.jordanfishwick.co.uk