



jordanfishwick

Wilbraham Road
Chorlton



Wilbraham Road Chorlton M21 0SD

£825 Per Calendar Month



The Property

**** AVAILABLE NOW **** A bright and spacious second floor studio apartment in a converted period property (approx. 440sq ft) with separate fitted gallery kitchen - new washing machine being supplied, entrance hall, bathroom with three piece suite including electric shower over bath and a spacious lounge/bedroom including access to private boarded loft space . Positioned in the heart of Chorlton and conveniently placed for supermarkets, bars and restaurants and one minute walk to Metro link station and a ten minute drive to motorway links. Benefits include gas fired central heating. Double glazed throughout with private parking to the rear of the property. The accommodation comprises briefly: good sized lounge/bedroom, a fitted breakfast kitchen and a bathroom with a three piece white suite and over bath shower. Part-Furnished. INCLUDES GAS & WATER RATES .

***** To arrange a viewing please call 0161 393 7539 *****

Directions

- Council Tax band A - EPC - D
- Second Floor Studio Apartment
- Gas central heating & Water included
- Private parking to the rear
- Loft storage space
- Close to Chorlton Metro links & shops
- Available Now

Postcode - M21 0SD

EPC Rating - D

Floor Area - sq ft

Local Authority - Manchester City Council

Council Tax - A



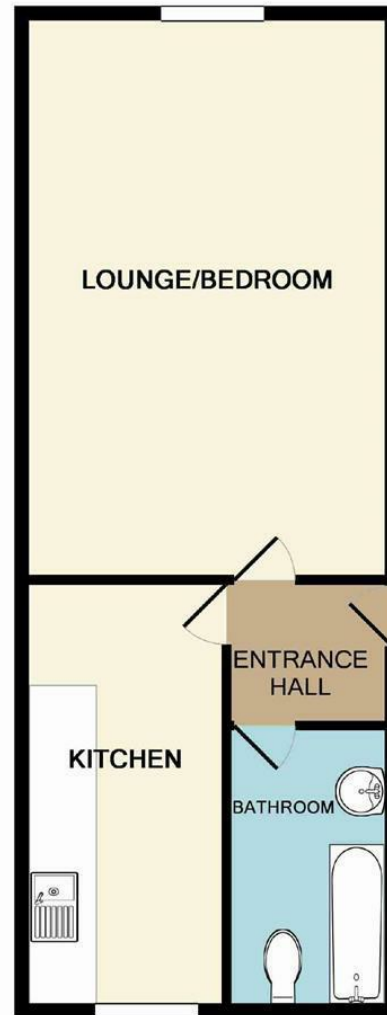

Measurements are approximate. Not to scale. Illustrative purposes only
Made with Metropix ©2015



These particulars are believed to be accurate but they are not guaranteed and do not form a contract. Neither Jordan Fishwick nor the vendor or lessor accept any responsibility in respect of these particulars, which are not intended to be statements or representations of fact and any intending purchaser or lessee must satisfy himself by inspection or otherwise as to the correctness of each of the statements contained in these particulars. Any floorplans on this brochure are for illustrative purposes only and are not necessarily to scale.

Offices at: Offices at Chorlton, Didsbury, Disley, Hale, Glossop, Macclesfield, Manchester Deansgate, Manchester Whitworth Street, New Mills, Sale, Wilmslow and Withington

410-412 Barlow Moor Road, Chorlton, Manchester, M21
8AD

www.jordanfishwick.co.uk