



Jordan fishwick

23, 105 Chorlton Villas, Hardy Lane, M21
£2,550 Per Calendar Month



Chorlton Villas, Hardy Lane Chorlton M21 8DN

£2,550 Per Calendar Month



The Property

***** AVAILABLE AUGUST ***** A superbly presented modern and beautiful property located within a highly sought after gated community Chorlton Villas. The property offers spacious and versatile family accommodation over three floors. Comprises briefly: entrance hall, cloakroom/wc, large lounge, fitted dining kitchen, utility room. To the first floor there are three double bedrooms, one with an en suite shower room and a family bathroom. To the top floor there is a large main bedroom, a dressing room, en suite shower room and decked balcony. Gas central heating and double glazing are installed. There is a lawned large private garden to the rear as well as a driveway and garage with electric up and over door. This property has an impressive specification. Viewing of this fine home is highly recommended.

***** To arrange a viewing please call 0161 393 7539 *****

- Council Tax band F - EPC B
- Chorlton Villas
- 4 Bedrooms & 3 Bathrooms
- Garage & Off road parking
- Beautiful Development
- Large private rear garden
- Available August



Energy Efficiency Rating		
	Current	Potential
Very energy efficient - lower running costs		
(92 plus) A		
(81-91) B	87	87
(69-80) C		
(55-68) D		
(39-54) E		
(21-38) F		
(1-20) G		
Not energy efficient - higher running costs		
England & Wales	EU Directive 2002/91/EC	



GROUND FLOOR



1ST FLOOR

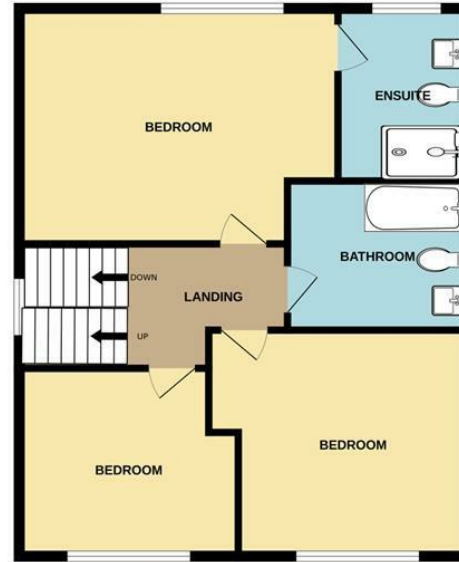

2ND FLOOR

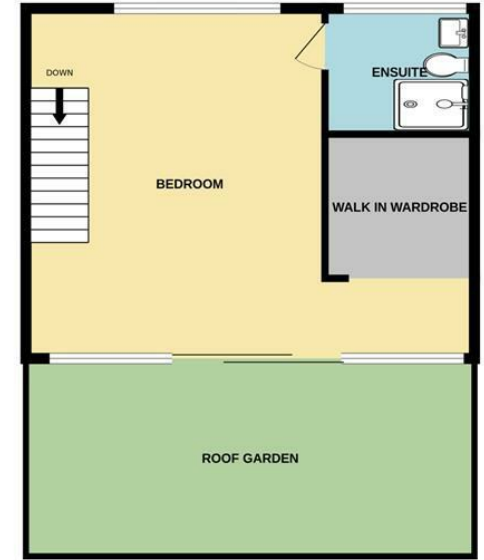

Measurements are approximate. Not to scale. Illustrative purposes only
Made with Metropix ©2024



These particulars are believed to be accurate but they are not guaranteed and do not form a contract. Neither Jordan Fishwick nor the vendor or lessor accept any responsibility in respect of these particulars, which are not intended to be statements or representations of fact and any intending purchaser or lessee must satisfy himself by inspection or otherwise as to the correctness of each of the statements contained in these particulars. Any floorplans on this brochure are for illustrative purposes only and are not necessarily to scale.

Offices at: Offices at Chorlton, Didsbury, Disley, Hale, Glossop, Macclesfield, Manchester Deansgate, Manchester Whitworth Street, New Mills, Sale, Wilmslow and Withington