



ESTATE AGENTS

Sales • Lettings • New Homes



17 Henrietta Court Marlborough Road

, Swindon, SN3 1QJ

Offers In Excess Of £90,000



Floor Plan

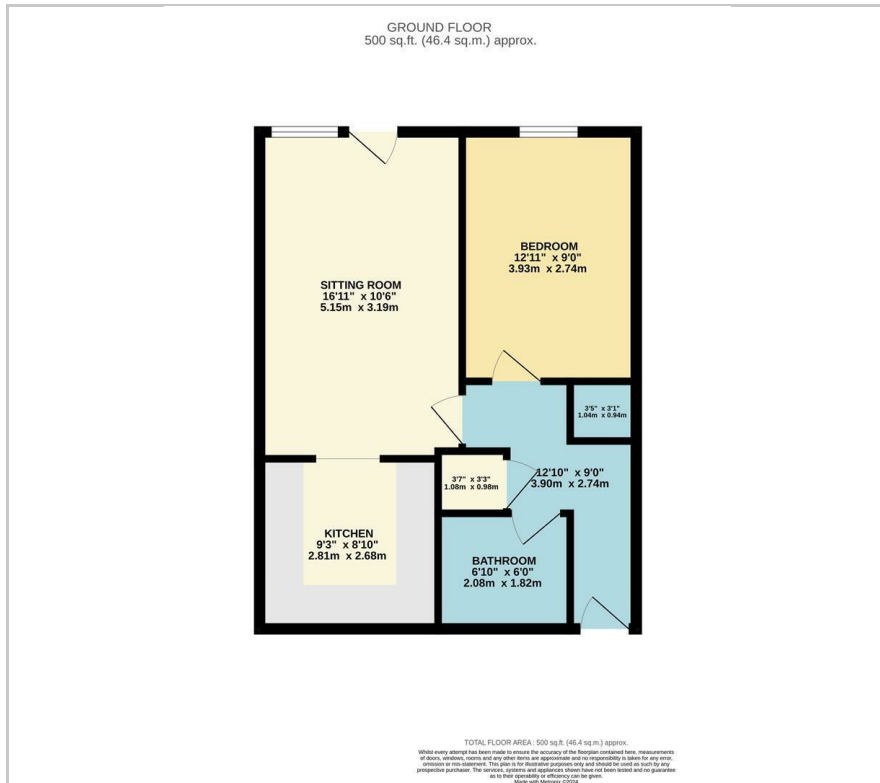

- GROUND FLOOR APARTMENT
- KITCHEN
- PARKING
- NO ONWARD CHAIN
- LOUNGE
- DOUBLE BEDROOM
- COMMUNAL GARDENS

NO ONWARD CHAIN A one bedroom GROUND FLOOR apartment situated in the popular retirement complex of Henrietta Court. The accommodation offers a pleasant sitting room with door onto the gardens, a kitchen, a refitted bathroom with walk-in shower & seat and a double bedroom with built-in wardrobe.

Henrietta Court is a small sought after development for the over 55's within short walking distance to the centre of Old Town where there are shops, coffee shops, supermarkets, doctors, dentists, library and a leisure complex. There are attractive gardens surrounding the property and parking available for owners and visitors. There is also a bus stop just outside the complex.

Service charge - £194 per month approx
Ground Rent - £150 per annum
Lease - 64 years remaining

Viewing

Please contact our Chappells Estate Agents Sales Office on 01793 618080 if you wish to arrange a viewing appointment for this property or require further information.

These particulars, whilst believed to be accurate are set out as a general outline only for guidance and do not constitute any part of an offer or contract. Intending purchasers should not rely on them as statements of representation of fact, but must satisfy themselves by inspection or otherwise as to their accuracy. No person in this firm's employment has the authority to make or give any representation or warranty in respect of the property.

35-36 Newport Street, Swindon, Wiltshire, SN1 3DF

01793 6180

sales@chappells.uk.com ww.chappells.uk.com



Area Map



Energy Efficiency Graph

