

Anfield, Towyn Road, Belgrano, LL22 9AB

£129,950

2 1 1



This no forward chain, two bedroom end of terrace house is situated in a popular seaside town, with close proximity to the coastal path, public transport links, and easy access to the A55. This property comprises of a bright lounge, kitchen/diner, two large bedrooms and a family bathroom. Benefiting from double glazed uPVC windows and gutters, gas central heating throughout, and off road parking.

Key Features

- No forward chain
- End of terrace
- Off-road parking for two cars
- Low maintenance garden
- Tenure - Freehold
- Coastal location
- Two double bedrooms
- Gas central heating
- EPC-C
- Council Tax-C

Approx Gross Internal Area
69 sq m / 738 sq ft

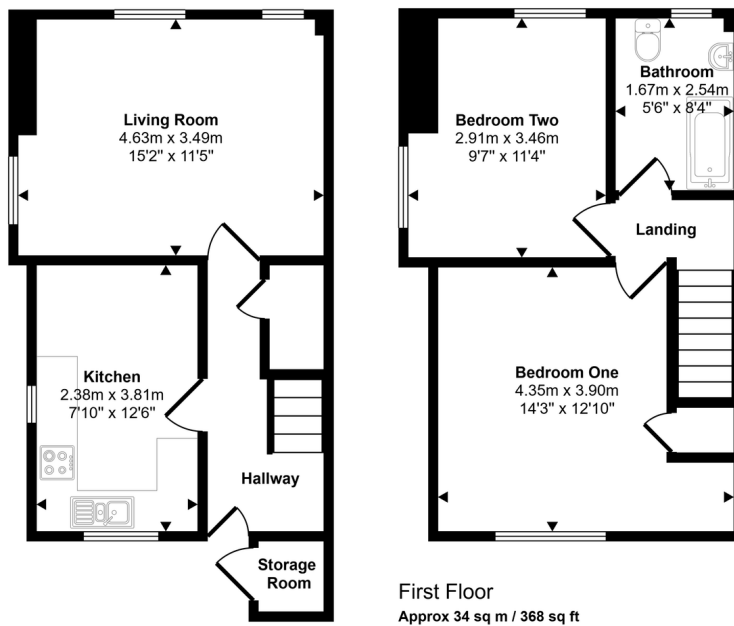

Ground Floor
Approx 34 sq m / 370 sq ft

First Floor
Approx 34 sq m / 368 sq ft

This floorplan is only for illustrative purposes and is not to scale. Measurements of rooms, doors, windows, and any items are approximate and no responsibility is taken for any error, omission or mis-statement. Icons of items such as bathroom suites are representations only and may not look like the real items. Made with Made Snappy 360.