

## 14 Bron Wern, Llanddulas, Abergele, LL22 8JD

£229,950

🛏 2 🚿 1 🛋 2



A semi-detached bungalow, available with no forwarding chain. Located in Llanddulas, a desirable, coastal village where the A55 expressway is easily accessed, providing an easy commute along the North Wales coast and beyond. The accommodation comprises of a bright lounge, converted garage space providing an additional reception room, two bedrooms, bathroom and kitchen. The property benefits from a South facing rear garden that offers a peaceful environment and a driveway at the front of the property perfect for off street parking. The nearby larger towns of Abergele and Colwyn bay have train stations, amenities, schools for all ages and supermarkets.

## Key Features

- Semi-detached bungalow
- No onward chain
- Council tax - C
- Garage conversion
- Off road parking
- Two bedrooms
- South facing rear garden
- EPC - TBC
- Tenure - Freehold
- A55 expressway easily accessed

Approx Gross Internal Area  
70 sq m / 749 sq ft

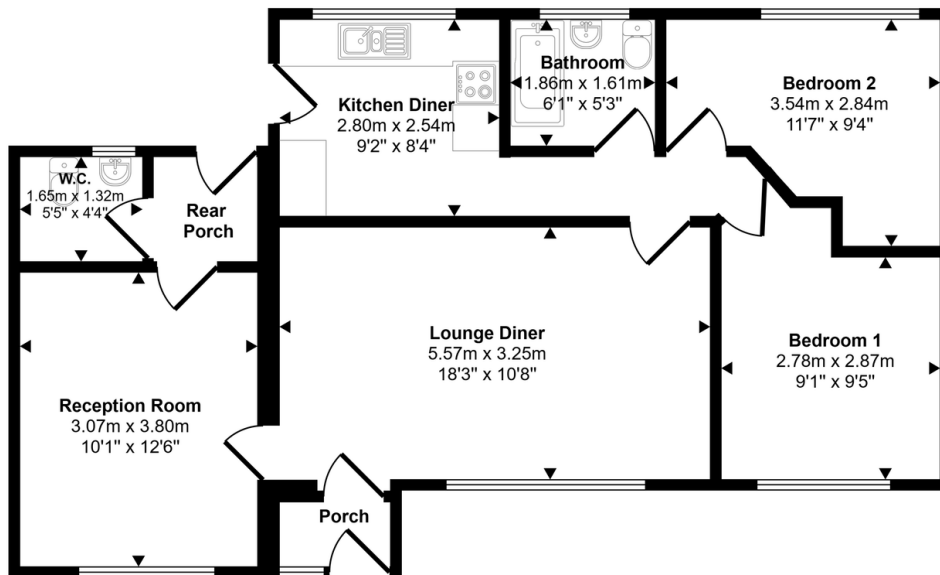

Floorplan

This floorplan is only for illustrative purposes and is not to scale. Measurements of rooms, doors, windows, and any items are approximate and no responsibility is taken for any error, omission or mis-statement. Icons of items such as bathroom suites are representations only and may not look like the real items. Made with Made Snappy 360.