

4 Tan Yr Foel, Rhyd-y-Foel, Abergele, Conwy, LL22 8HZ

£329,950

🛏 3 🚿 1 🛋 2



Offered with no forward chain is this elevated bungalow in a quiet cul-de-sac located in the delightful village of Rhyd-y-Foel, boasting glorious views of the mountainside. Within ten minutes drive of the A55 Expressway at Llanddulas, giving easy access along the North Wales coastline, Chester and beyond. The historic market town of Abergele is also within easy travelling distance and has a variety of shops including Tesco, schools for all age groups and leisure facilities. This property benefits from three bedrooms, a large kitchen diner, separate snug, utility room, good size gardens and a spacious garage.

Key Features

- No onward chain
- Peaceful rural village
- Three bedrooms
- Large garage
- Council tax band - E
- Picturesque views from all angles
- Detached bungalow
- Large Kitchen-Diner space
- Freehold
- EPC rating - TBC

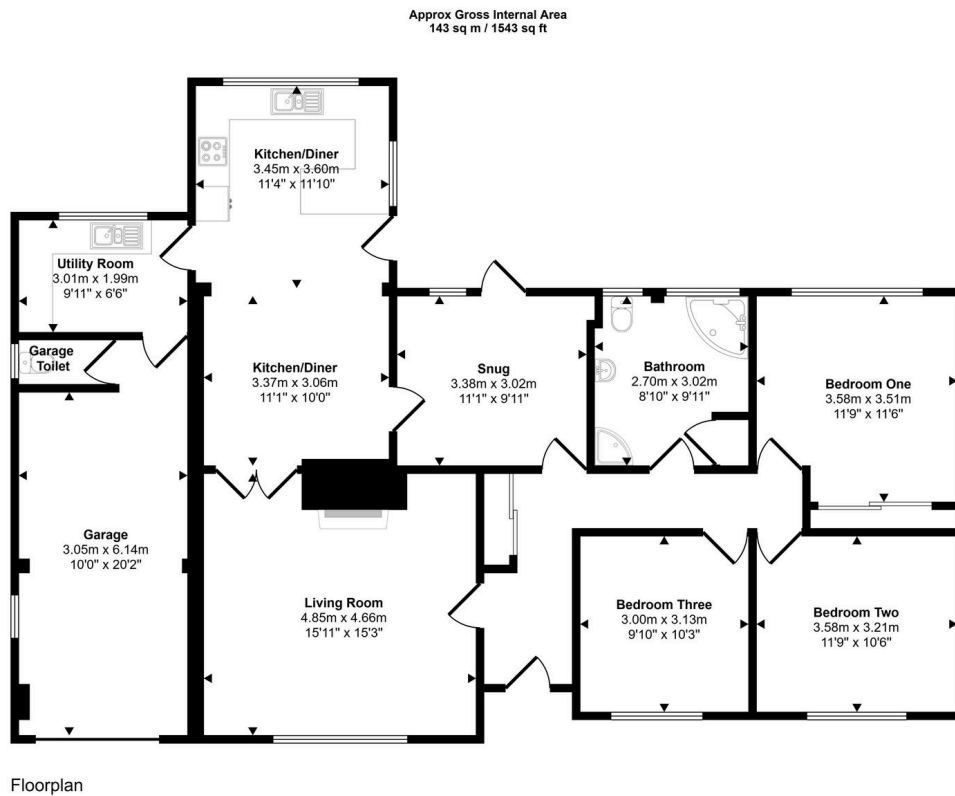

This floorplan is only for illustrative purposes and is not to scale. Measurements of rooms, doors, windows, and any items are approximate and no responsibility is taken for any error, omission or mis-statement. Icons of items such as bathroom suites are representations only and may not look like the real items. Made with Made Snappy 360.

CONSUMER PROTECTION REGULATIONS 2008 AND THE BUSINESS PROTECTION FROM MISLEADING MARKETING REGULATIONS 2008

These particulars, whilst believed to be accurate, are set out for guidance only and do not constitute any part of an offer or contract. Prospective purchasers or tenants should not rely on these particulars as statement or representation of fact, but must satisfy themselves by inspection or otherwise as to their accuracy. No person in the employment of PETER LARGE Estate Agents has the authority to make or give any representation or warranty in relation to the property. Room sizes are approximate and all comments are of the opinion of PETER LARGE Estate agents having carried out a walk through inspection. These sales particulars are prepared under the consumer regulations 2008 and are governed by the business from misleading marketing regulations 2008.